



NOTE: PLAN SHOWN IS PRELIMINARY AND IS SUBJECT TO CHANGE

LEGEND

— PROPOSED TRAIL PATH

--- PARCEL LIMITS

REVISION NO.	DATE	REVISION

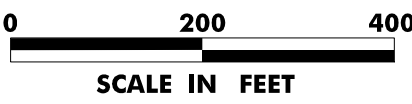

NV5

1315 Walnut Street, Suite 900
Philadelphia, PA 19107
Certification of Authorization No. 24GA27930500

**CAMDEN COUNTY LINK TRAIL
SEGMENT 1D
PUBLIC MEETING PLAN VIEW LAYOUT**

CAMDEN COUNTY

NEW JERSEY

PROJECT NO	DATE
540.1D	JULY 2020
DRAWN BY	DESIGNED BY
LC	LC
SCALE	CHECKED BY
1"=200'	ML
NV5	
SHEET NO.	1 of 4

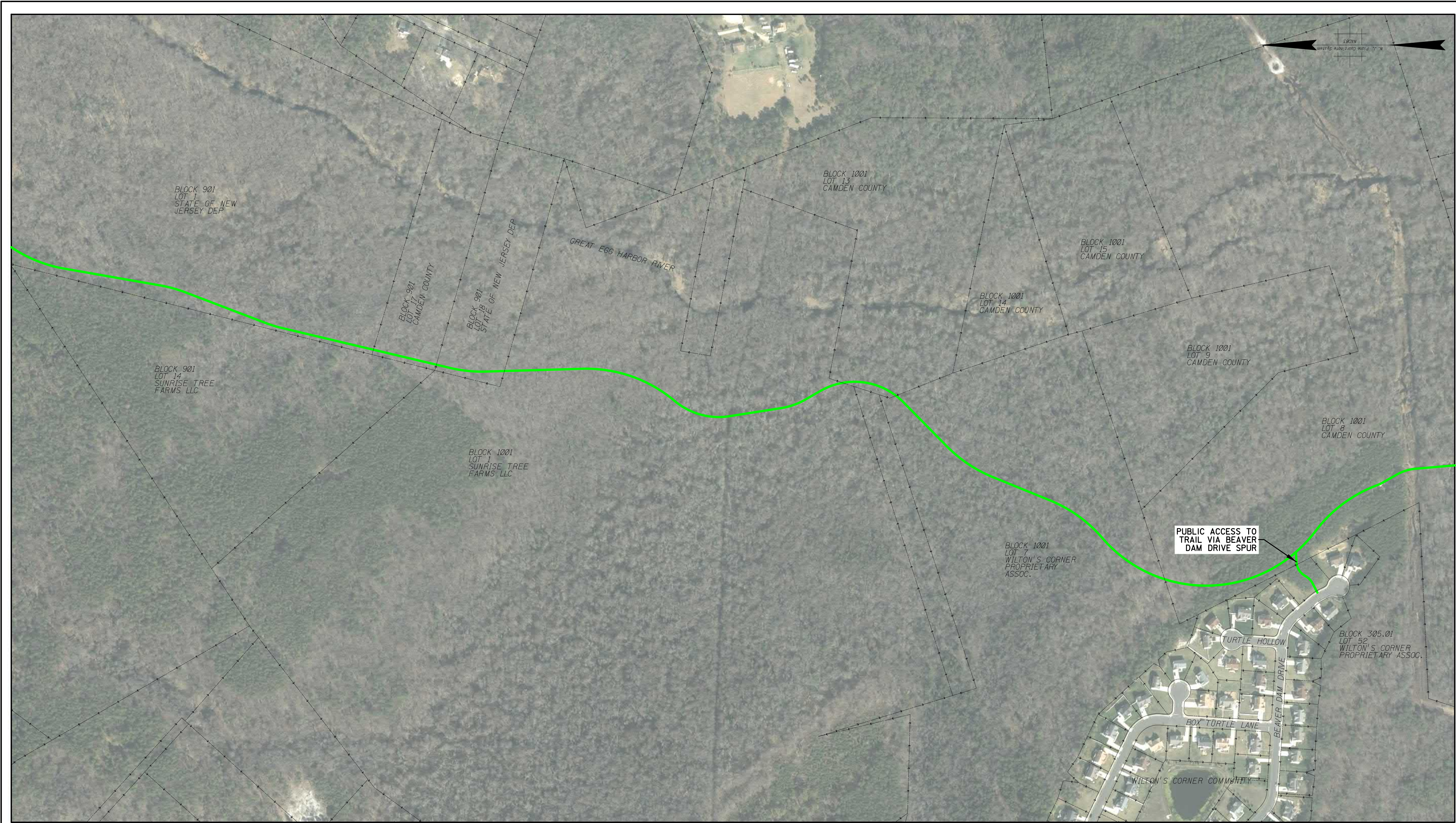

NOTE: PLAN SHOWN IS PRELIMINARY AND IS SUBJECT TO CHANGE

LEGEND

— PROPOSED TRAIL PATH

- - - PARCEL LIMITS

REVISION NO.	DATE	REVISION



1315 Walnut Street, Suite 900
Philadelphia, PA 19107
Certification of Authorization No. 24GA27930500

**CAMDEN COUNTY LINK TRAIL
SEGMENT 1D
PUBLIC MEETING PLAN VIEW LAYOUT**

CAMDEN COUNTY NEW JERSEY

PROJECT NO.	DATE
540.1D	JULY 2020
DRAWN BY	DESIGNED BY
LC	LC
SCALE	CHECKED BY
1"=200'	ML
NV5	
SHEET NO.	2 of 4



NOTE: PLAN SHOWN IS PRELIMINARY AND IS SUBJECT TO CHANGE

LEGEND

— PROPOSED TRAIL PATH

- - - - - PARCEL LIMITS

REVISION NO.	DATE	REVISION



1315 Walnut Street, Suite 900
Philadelphia, PA 19107
Certification of Authorization No. 24GA27930500

**CAMDEN COUNTY LINK TRAIL
SEGMENT 1D
PUBLIC MEETING PLAN VIEW LAYOUT**

CAMDEN COUNTY

NEW JERSEY

PROJECT NO.	DATE
540.1D	JULY 2020
DRAWN BY	DESIGNED BY
LC	LC
SCALE	CHECKED BY
1"=200'	ML
NV5	
SHEET NO.	3 of 4



NOTE: PLAN SHOWN IS PRELIMINARY AND IS SUBJECT TO CHANGE

LEGEND

- PROPOSED TRAIL PATH
- PARCEL LIMITS

REVISION NO.	DATE	REVISION

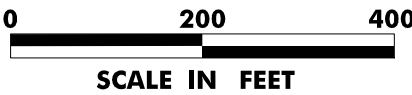

NV5

1315 Walnut Street, Suite 900
Philadelphia, PA 19107
Certification of Authorization No. 24GA27930500

CAMDEN COUNTY LINK TRAIL
SEGMENT 1D
PUBLIC MEETING PLAN VIEW LAYOUT

CAMDEN COUNTY

NEW JERSEY

PROJECT NO.	DATE
540.1D	JULY 2020
DRAWN BY	DESIGNED BY
LC	LC
SCALE	CHECKED BY
1"=200'	ML
NV5	
SHEET NO.	4 of 4



REVISION NO.	DATE	REVISION

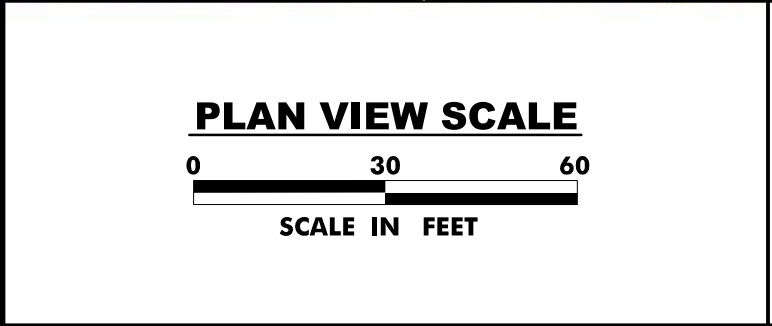

N|V|5

1315 Walnut Street, Suite 900
Philadelphia, PA 19107
Certification of Authorization No. 24GA27930500

**CAMDEN COUNTY LINK TRAIL
SEGMENT 1E
PUBLIC MEETING PLAN VIEW LAYOUT**

CAMDEN COUNTY NEW JERSEY

PROJECT NO	DATE
540.1E	JULY 2020
DRAWN BY	DESIGNED BY
LC	LC
SCALE	CHECKED BY
1"=30'	ML
NV5	
SHEET NO. 1	of 10

LEGEND

- PROPOSED EDGE OF TRAIL & SIDEWALK
- PROPOSED CURB
- CENTERLINE OF TRAIL

NOTE: PLAN SHOWN IS PRELIMINARY
AND IS SUBJECT TO CHANGE

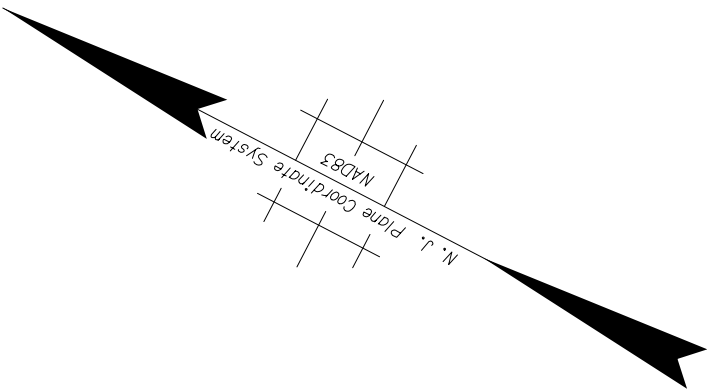

REVISION NO.	DATE	REVISION

PLAN VIEW SCALE
0 30 60
SCALE IN FEET

N|V|5

1315 Walnut Street, Suite 900
Philadelphia, PA 19107
Certification of Authorization No. 24GA27930500

CAMDEN COUNTY LINK TRAIL
SEGMENT 1E
PUBLIC MEETING PLAN VIEW LAYOUT

CAMDEN COUNTY

NEW JERSEY

PROJECT NO	DATE
540.1E	JULY 2020
DRAWN BY	DESIGNED BY
LC	LC
SCALE	CHECKED BY
1"=30'	ML
NV5	
SHEET NO. 2	of 10

LEGEND

- PROPOSED EDGE OF TRAIL & SIDEWALK
- PROPOSED CURB
- CENTERLINE OF TRAIL

NOTE: PLAN SHOWN IS PRELIMINARY
AND IS SUBJECT TO CHANGE

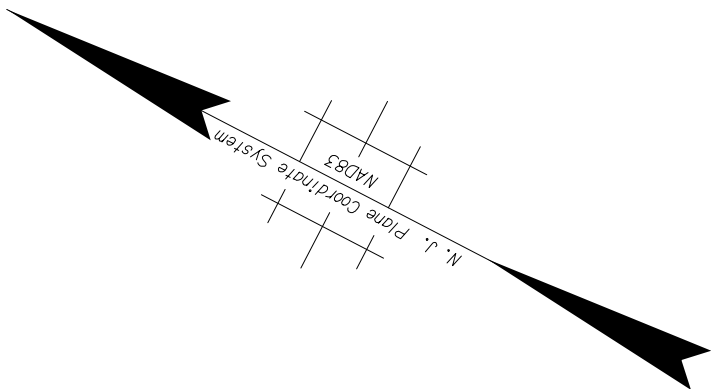

REVISION NO.	DATE	REVISION

PLAN VIEW SCALE
0 30 60
SCALE IN FEET

N|V|5

1315 Walnut Street, Suite 900
Philadelphia, PA 19107
Certification of Authorization No. 24GA27930500

CAMDEN COUNTY LINK TRAIL
SEGMENT 1E
PUBLIC MEETING PLAN VIEW LAYOUT

CAMDEN COUNTY

NEW JERSEY

PROJECT NO	DATE
540.1E	JULY 2020
DRAWN BY	DESIGNED BY
LC	LC
SCALE	CHECKED BY
1"=30'	ML
NV5	
SHEET NO.	of
3	10

LEGEND

- PROPOSED EDGE OF TRAIL & SIDEWALK
- PROPOSED CURB
- CENTERLINE OF TRAIL

NOTE: PLAN SHOWN IS PRELIMINARY
AND IS SUBJECT TO CHANGE

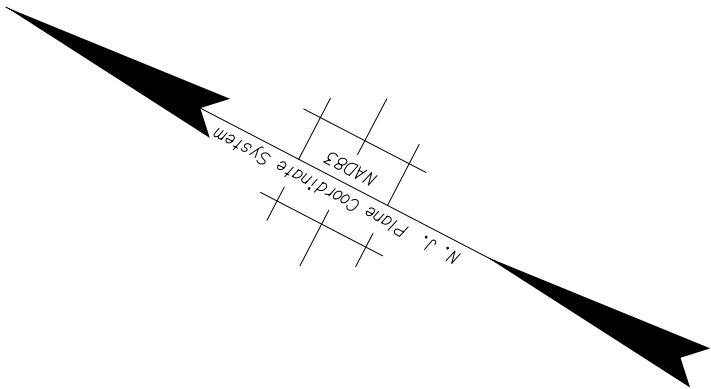

REVISION NO.	DATE	REVISION

PLAN VIEW SCALE
0 30 60
SCALE IN FEET

N|V|5

1315 Walnut Street, Suite 900
Philadelphia, PA 19107
Certification of Authorization No. 24GA27930500

CAMDEN COUNTY LINK TRAIL
SEGMENT 1E
PUBLIC MEETING PLAN VIEW LAYOUT

CAMDEN COUNTY

NEW JERSEY

PROJECT NO.	DATE
540.1E	JULY 2020
DRAWN BY	DESIGNED BY
LC	LC
SCALE	CHECKED BY
1"=30'	ML
NV5	
SHEET NO.	of
4	10

LEGEND

- PROPOSED EDGE OF TRAIL & SIDEWALK
- PROPOSED CURB
- CENTERLINE OF TRAIL

NOTE: PLAN SHOWN IS PRELIMINARY
AND IS SUBJECT TO CHANGE

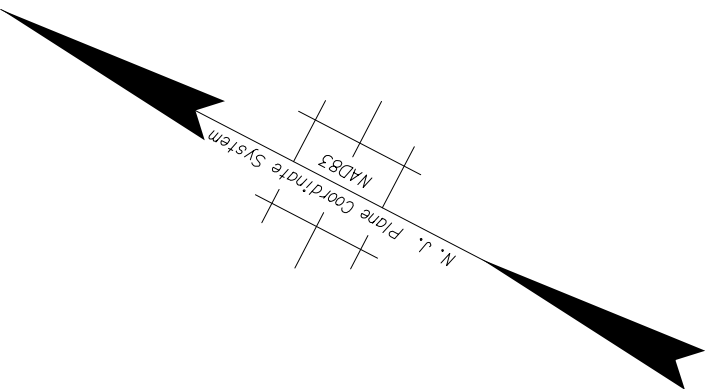

REVISION NO.	DATE	REVISION

PLAN VIEW SCALE
0 30 60
SCALE IN FEET

N|V|5

1315 Walnut Street, Suite 900
Philadelphia, PA 19107
Certification of Authorization No. 24GA27930500

CAMDEN COUNTY LINK TRAIL
SEGMENT 1E
PUBLIC MEETING PLAN VIEW LAYOUT

CAMDEN COUNTY

NEW JERSEY

PROJECT NO	DATE
540.1E	JULY 2020
DRAWN BY	DESIGNED BY
LC	LC
SCALE	CHECKED BY
1"=30'	ML
NV5	
SHEET NO. 5	of 10

LEGEND

- PROPOSED EDGE OF TRAIL & SIDEWALK
- PROPOSED CURB
- CENTERLINE OF TRAIL

NOTE: PLAN SHOWN IS PRELIMINARY
AND IS SUBJECT TO CHANGE

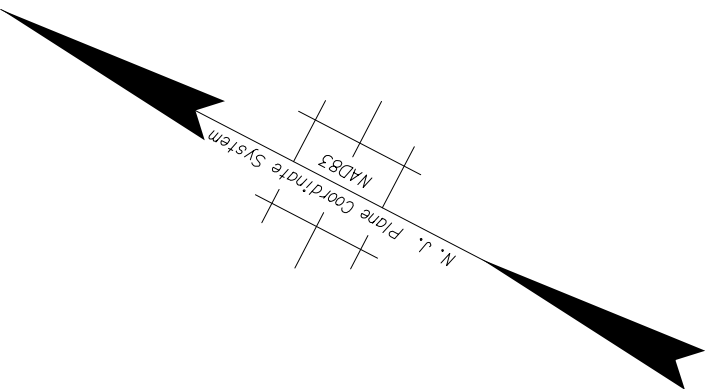

REVISION NO.	DATE	REVISION

PLAN VIEW SCALE
0 30 60
SCALE IN FEET

N|V|5

1315 Walnut Street, Suite 900
Philadelphia, PA 19107
Certification of Authorization No. 24GA27930500

CAMDEN COUNTY LINK TRAIL
SEGMENT 1E
PUBLIC MEETING PLAN VIEW LAYOUT

CAMDEN COUNTY

NEW JERSEY

PROJECT NO.	DATE
540.1E	JULY 2020
DRAWN BY	DESIGNED BY
LC	LC
SCALE	CHECKED BY
1"=30'	ML
NV5	
SHEET NO.	of
6	10

LEGEND

- PROPOSED EDGE OF TRAIL & SIDEWALK
- PROPOSED CURB
- CENTERLINE OF TRAIL

NOTE: PLAN SHOWN IS PRELIMINARY
AND IS SUBJECT TO CHANGE

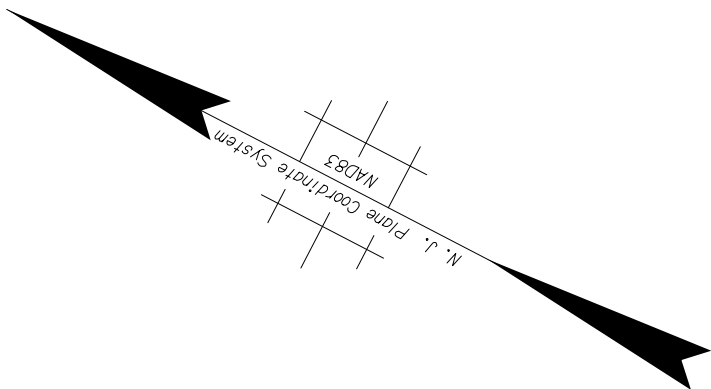

REVISION NO.	DATE	REVISION

PLAN VIEW SCALE
0 30 60
SCALE IN FEET

N|V|5

1315 Walnut Street, Suite 900
Philadelphia, PA 19107
Certification of Authorization No. 24GA27930500

CAMDEN COUNTY LINK TRAIL
SEGMENT 1E
PUBLIC MEETING PLAN VIEW LAYOUT

CAMDEN COUNTY

NEW JERSEY

PROJECT NO	DATE
540.1E	JULY 2020
DRAWN BY	DESIGNED BY
LC	LC
SCALE	CHECKED BY
1"=30'	ML
NV5	
SHEET NO. 7	of 10

LEGEND

- PROPOSED EDGE OF TRAIL & SIDEWALK
- PROPOSED CURB
- CENTERLINE OF TRAIL

NOTE: PLAN SHOWN IS PRELIMINARY
AND IS SUBJECT TO CHANGE

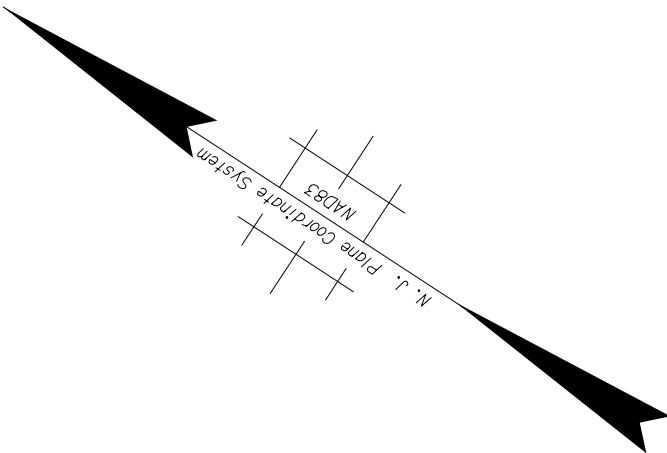

REVISION NO.	DATE	REVISION

PLAN VIEW SCALE
0 30 60
SCALE IN FEET

NV5

1315 Walnut Street, Suite 900
Philadelphia, PA 19107
Certification of Authorization No. 24GA27930500

CAMDEN COUNTY LINK TRAIL
SEGMENT 1E
PUBLIC MEETING PLAN VIEW LAYOUT

CAMDEN COUNTY

NEW JERSEY

PROJECT NO	DATE
540.1E	JULY 2020
DRAWN BY	DESIGNED BY
LC	LC
SCALE	CHECKED BY
1"=30'	ML
NV5	
SHEET NO.	of
8	10

LEGEND

- PROPOSED EDGE OF TRAIL & SIDEWALK
- PROPOSED CURB
- CENTERLINE OF TRAIL

NOTE: PLAN SHOWN IS PRELIMINARY
AND IS SUBJECT TO CHANGE

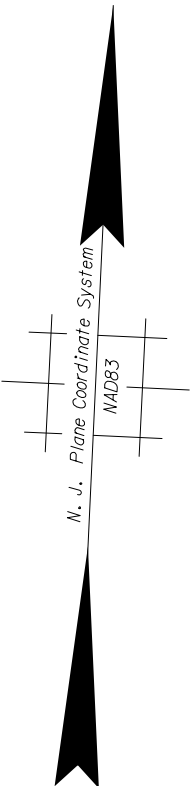

REVISION NO.	DATE	REVISION

PLAN VIEW SCALE
0 30 60
SCALE IN FEET

N|V|5

1315 Walnut Street, Suite 900
Philadelphia, PA 19107
Certification of Authorization No. 24GA27930500

CAMDEN COUNTY LINK TRAIL
SEGMENT 1E
PUBLIC MEETING PLAN VIEW LAYOUT

CAMDEN COUNTY

NEW JERSEY

PROJECT NO	DATE
540.1E	JULY 2020
DRAWN BY	DESIGNED BY
LC	LC
SCALE	CHECKED BY
1"=30'	ML
NV5	
SHEET NO. 9	of 10

LEGEND

- PROPOSED EDGE OF TRAIL & SIDEWALK
- PROPOSED CURB
- CENTERLINE OF TRAIL

NOTE: PLAN SHOWN IS PRELIMINARY
AND IS SUBJECT TO CHANGE

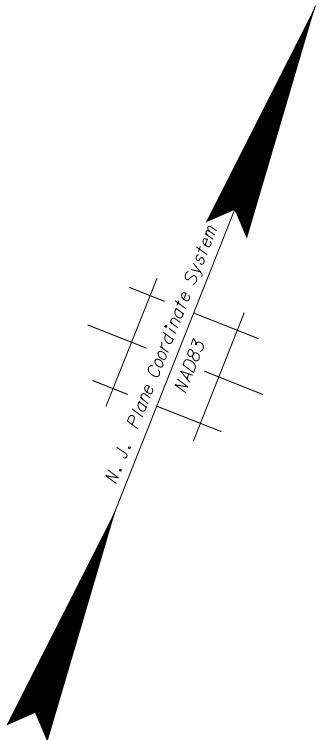

REVISION NO.	DATE	REVISION

PLAN VIEW SCALE
0 30 60
SCALE IN FEET

NV5

1315 Walnut Street, Suite 900
Philadelphia, PA 19107
Certification of Authorization No. 24GA27930500

CAMDEN COUNTY LINK TRAIL
SEGMENT 1E
PUBLIC MEETING PLAN VIEW LAYOUT

CAMDEN COUNTY

NEW JERSEY

PROJECT NO	DATE
540.1E	JULY 2020
DRAWN BY	DESIGNED BY
LC	LC
SCALE	CHECKED BY
1"=30'	ML
NV5	
SHEET NO.	of
10	10