

CURB SIZE	DIM "A"	DIM "B"
9" x 18"	18"	4"
9" x 18"	18"	6"

- NOTES:**
1. EXPANSION JOINTS  $\frac{1}{2}$ " WIDE IN THE CURB SHALL BE PROVIDED AT APPROXIMATELY EQUAL DISTANCES OF NOT MORE THAN 20' BETWEEN THE JOINTS.
  2. THE COST OF EXPANSION JOINTS IN THE CURB AND DENSE GRADED AGGREGATE BEDDING SHALL BE INCLUDED IN THE UNIT PRICE BID FOR THE CURB.
  3. CONCRETE SHALL BE CLASS B WITH 28 DAY COMPRESSIVE STRENGTH OF 4500 PSI, AND 6%  $\pm$ 1.5 AIR ENTRAINMENT.

DETAIL 1 STANDARD 8"X9"X18" CONCRETE  
 N.T.S. VERTICAL CURB DETAIL

No.				
DATE		REVISIONS		
<b>CAMDEN COUNTY</b> DEPARTMENT OF PUBLIC WORKS DIVISION OF PLANNING CHARLES J. DEPALMA PUBLIC WORKS COMPLEX 2311 EGG HARBOR ROAD NEW JERSEY 08021		<b>CAMDEN COUNTY</b> DEPARTMENT OF PUBLIC WORKS SAM MARTELLO, DIRECTOR KEVIN BECIGA, P.E., P.P., C.M.E., C.F.M. 2311 EGG HARBOR ROAD UNDERWOOD, NEW JERSEY 08021		TITLE  COUNTY STANDARD 8"X9"X18" CONCRETE VERTICAL CURB DETAIL
		DATE	MAR 2014	SH. NO.
		DRAWN BY	T.A.P	1
		APPROVED BY	K.B./A.L.	1

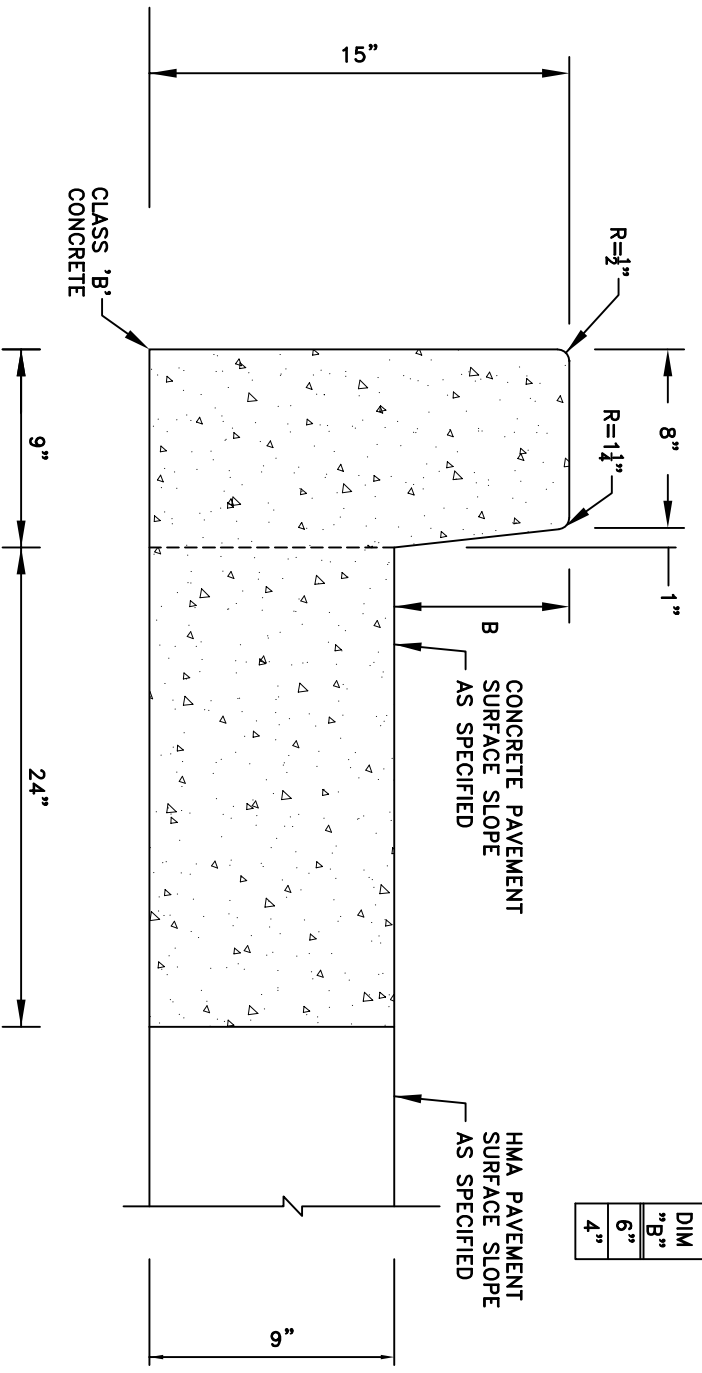

DIM	4"
"B"	6"
"B"	4"

**NOTES:**

1. TRANSVERSE JOINTS 1/2" WIDE SHALL BE INSTALLED IN THE CURB 20'-0" APART AND SHALL BE FILLED WITH PREFORMED BITUMINOUS IMPREGNATED FIBER JOINT FILLER, COMPLYING WITH THE REQUIREMENTS FOR TYPE III FILLER IN A.A.S.H.T.O. SPECS M-153, RECESSED 1/4" IN FROM FRONT FACE AND TOP OF CURB.
2. JOINT MATERIAL IN THE CURB SHALL BE AS SPECIFIED FOR CONCRETE VERTICAL CURB. THE TRANSVERSE EXPANSION JOINT MATERIAL SHALL NOT EXTEND THRU THE CURB.
3. CONCRETE SHALL BE CLASS B WITH 28 DAY COMPRESSIVE STRENGTH OF 4500 PSI, AND 6% ±1.5 AIR ENTRAINMENT.

DETAIL 2 STANDARD MONOLITHIC CONCRETE CURB AND GUTTER DETAIL

N.T.S.

CAMDEN COUNTY		CAMDEN COUNTY		TITLE	
DEPARTMENT OF PUBLIC WORKS		DEPARTMENT OF PUBLIC WORKS		COUNTY STANDARD	
DIVISION OF PLANNING		SAL MARTELLO, DIRECTOR		MONOLITHIC CONCRETE	
CHARLES J. DEPALMA PUBLIC WORKS COMPLEX		KEVIN BECRA, P.E., P.P., C.M.E., C.F.M.		CURB AND GUTTER DETAIL	
2311 EGG HARBOR ROAD		2311 COUNTESS AVENUE			
NEW JERSEY 08021		UNDERWOOD, NEW JERSEY 08021			
No.	DATE	DATE	DRAWN BY	APPROVED BY	SH. NO.
		MAR 2014	T.A.P	K.B./A.L.	1
REVISIONS					

CURB SIZE	DIM. A	DIM. B	DIM. C	DIM. D
9" x 18"	18"	6"	16"	4"

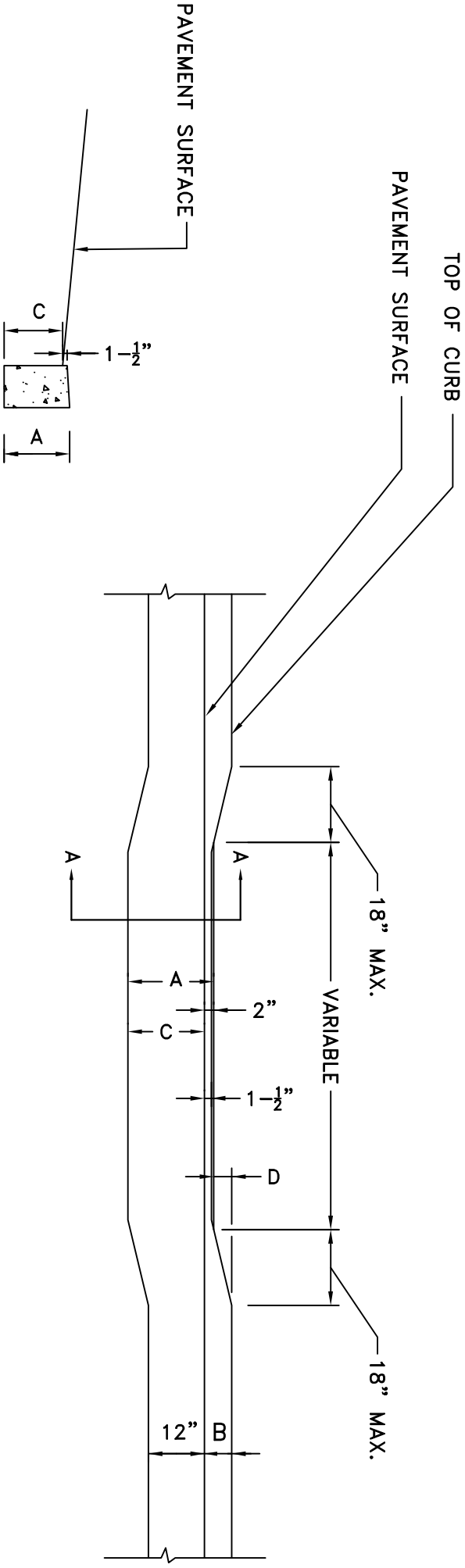

**SECTION A-A**

**METHOD OF DEPRESSING CURB**

**NOTES:**

1. CONCRETE SHALL BE CLASS B WITH 28 DAY COMPRESSIVE STRENGTH OF 4500 PSI, AND 6% ±1.5 AIR ENTRAINMENT.

DETAIL 3 STANDARD DEPRESSED CONCRETE CURB DETAIL

<b>No.</b>					
<b>DATE</b>		<b>REVISIONS</b>			
<b>CAMDEN COUNTY</b>		<b>CAMDEN COUNTY</b>		<b>TITLE</b>	
DEPARTMENT OF PUBLIC WORKS		DEPARTMENT OF PUBLIC WORKS		COUNTY STANDARD	
DIVISION OF PLANNING		SAM MARTELLO, DIRECTOR		DEPRESSED CONCRETE	
CHARLES J. DEPALMA, PUBLIC WORKS COMPLEX		KEVIN BECICA, P.E., P.P., C.M.E., C.F.M.		CURB DETAIL	
2311 EGG HARBOR ROAD		2311 SUNNYSIDE AVENUE			
NEW JERSEY 08021		UNDERWOOD, NEW JERSEY 08021			
				<b>DATE</b>	<b>DATE</b>
				MAR 2014	MAR 2014
				DRAWN BY	DRAWN BY
				T.A.P	T.A.P
				APPROVED BY	APPROVED BY
				K.B./A.L.	K.B./A.L.
				<b>SHT. NO.</b>	<b>SHT. NO.</b>
				1	1

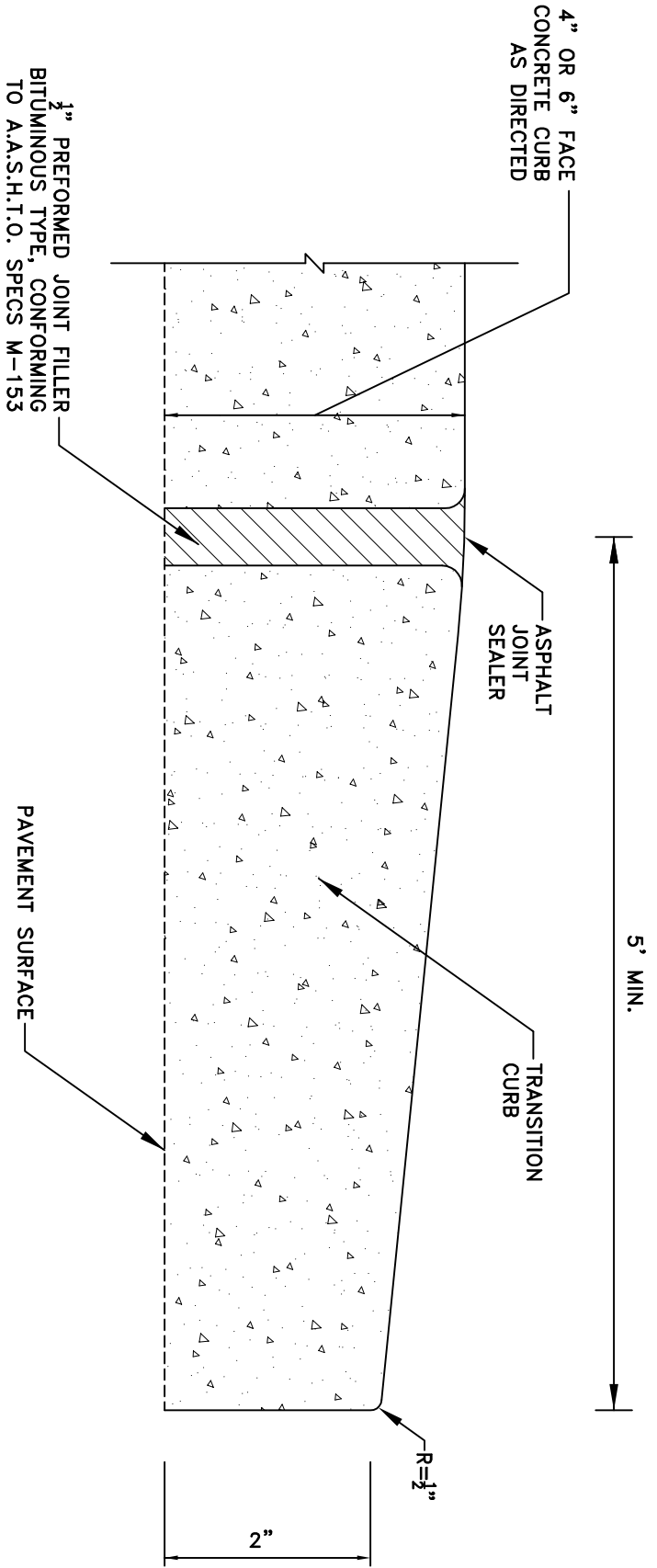

- NOTES:**
1. CONCRETE SHALL BE CLASS B WITH 28 DAY COMPRESSIVE STRENGTH OF 4500 PSI, AND 6% ±1.5 AIR ENTRAINMENT.

DETAIL  
4 STANDARD VERTICAL CONCRETE  
 N.I.S. CURB TAPER DETAIL

No.					
DATE					
	REVISIONS				
		<b>CAMDEN COUNTY</b> DEPARTMENT OF PUBLIC WORKS DIVISION OF PLANNING CHARLES J. DEPALMA PUBLIC WORKS COMPLEX 2311 EGG HARBOR ROAD NEW JERSEY 08021	<b>CAMDEN COUNTY</b> DEPARTMENT OF PUBLIC WORKS SAM MARTELLO, DIRECTOR KEVIN BECRA, P.E., C.M.E., C.F.M. 2311 EGG HARBOR ROAD LINCOLNWOOD, NEW JERSEY 08021	TITLE	COUNTY STANDARD VERTICAL CONCRETE CURB TAPER DETAIL
				DATE	MAR 2014
				DRAWN BY	T.A.P
				APPROVED BY	K.B./A.L.
				SHT. NO.	<span style="border: 1px solid black; border-radius: 50%; padding: 2px 10px;">1</span>

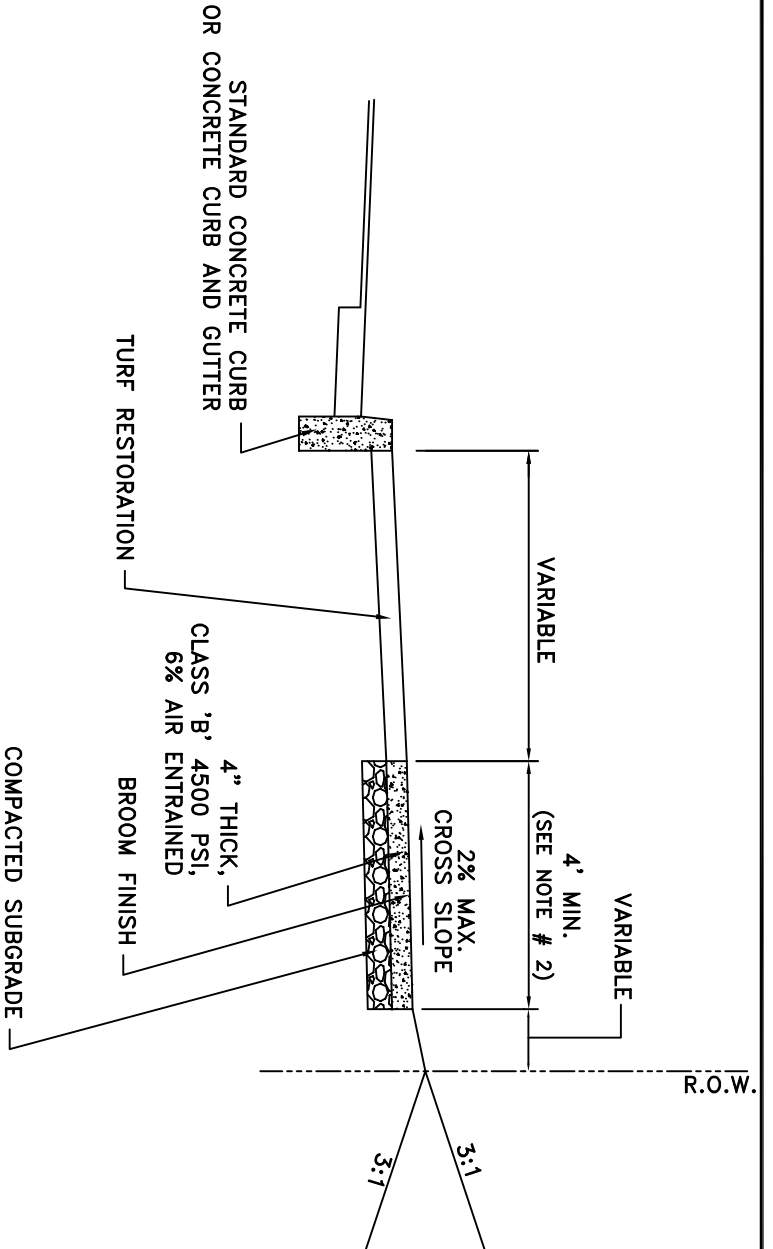

- NOTES:**
1. TURF RESTORATION TO CONSIST OF A MINIMUM OF 4" OF SELECT TOPSOIL, FERTILIZER AND SEED AS PER SPECIFICATIONS.
  2. IF SUBGRADE MATERIAL IS UNSUITABLE, CONTRACTOR TO REMOVE PER COUNTY ENGINEER'S DISCRETION AND REPLACE WITH SELECT FILL AT NO EXTRA COST TO THE COUNTY.
  3. SIDEWALK WIDTH SHALL BE 4'-0" MINIMUM UNLESS OTHERWISE NOTED ON THE APPROVED PLANS.
  4. CONCRETE SHALL BE CLASS B WITH 28 DAY COMPRESSIVE STRENGTH OF 4500 PSI AND 6% ±1.5% AIR ENTRAINMENT.

DETAIL 5 STANDARD CONCRETE SIDEWALK

N.T.S.

No.				
DATE				
	REVISIONS			
		<b>CAMDEN COUNTY</b> DEPARTMENT OF PUBLIC WORKS DIVISION OF PLANNING CHARLES J. DEPALMA PUBLIC WORKS COMPLEX 2311 BOG HANCOCK ROAD NEW JERSEY 08021	<b>CAMDEN COUNTY</b> DEPARTMENT OF PUBLIC WORKS SAM MARTELLO, DIRECTOR KEVIN BECIGA, P.E., P.P., C.M.E., C.F.M. COUNTY ENGINEER AND 2311 BOG HANCOCK ROAD LINCOLNWOOD, NEW JERSEY 08021	TITLE COUNTY STANDARD CONCRETE SIDEWALK DETAIL
		DATE MAR 2014	DRAWN BY T.A.P	APPROVED BY K.B./A.L.
				SHT. NO. 1

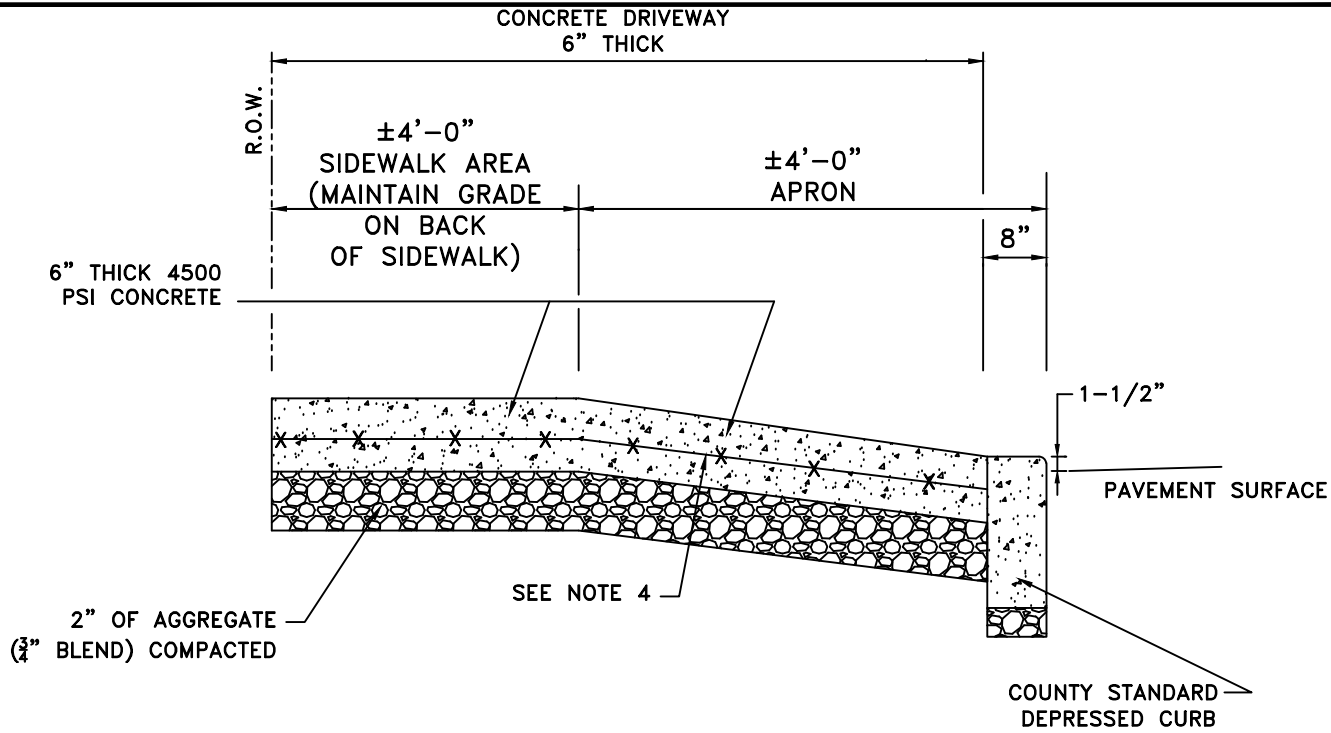

**NOTES:**

1. CONCRETE COMPRESSIVE STRENGTH SHALL BE A MINIMUM OF 4500 PSI AFTER 28 DAYS AT 6% ±1.5% AIR ENTRAINMENT.
2. CURB JOINT SHALL BE TROWELED WITH A MIN 1/2" RADIUS ALONG BACK OF CURB.
3. EXPANSION AND CONTRACTION JOINTS SHALL BE 1/2" PREMOLDED ASPHALT IMPREGNATED MATERIAL OR EQUAL EXTENDING FROM SUBGRADE TO FINISH GRADE.
4. PROVIDE 6" X 6" W1.4/W1.4 GALVANIZED MESH AT COMMERCIAL DRIVEWAYS ONLY. PROVIDE 6" X 6" W1.4/W1.4 NON GALVANIZED WELDED WIRE MESH AT RESIDENTIAL DRIVEWAYS.

DETAIL 6 STANDARD CONCRETE DRIVEWAY  
AND CONCRETE APRON

N.T.S.

Project: 3/6/2015, 1:58 PM - File Name: CA Engineering\County\_Standards\DT-6-Conc-Driveway-8.3X11.dwg

			<b>CAMDEN COUNTY</b> DEPARTMENT OF PUBLIC WORKS DIVISION OF PLANNING CHARLES J. DEPALMA PUBLIC WORKS COMPLEX 2311 EGG HARBOR ROAD LINDENWOLD NEW JERSEY 08021	<b>CAMDEN COUNTY</b> DEPARTMENT OF PUBLIC WORKS SAM MARTELLO, DIRECTOR KEVIN BECICA, PE, PP, CME, CFM COUNTY ENGINEER 2311 EGG HARBOR ROAD LINDENWOLD, NEW JERSEY 08021	TITLE COUNTY STANDARD CONCRETE DRIVEWAY DETAIL	DATE MAR 2014 DRAWN BY T.A.P. APPROVED BY K.B/A.L.	SHI. NO. <div style="border: 1px solid black; border-radius: 50%; width: 30px; height: 30px; margin: 0 auto; display: flex; flex-direction: column; align-items: center; justify-content: center;"> <span style="margin-bottom: 5px;">1</span> <span>1</span> </div>
1	03/06/2015	REINFORCEMENT SIZE REQUIREMENTS					
No.	DATE	REVISIONS					

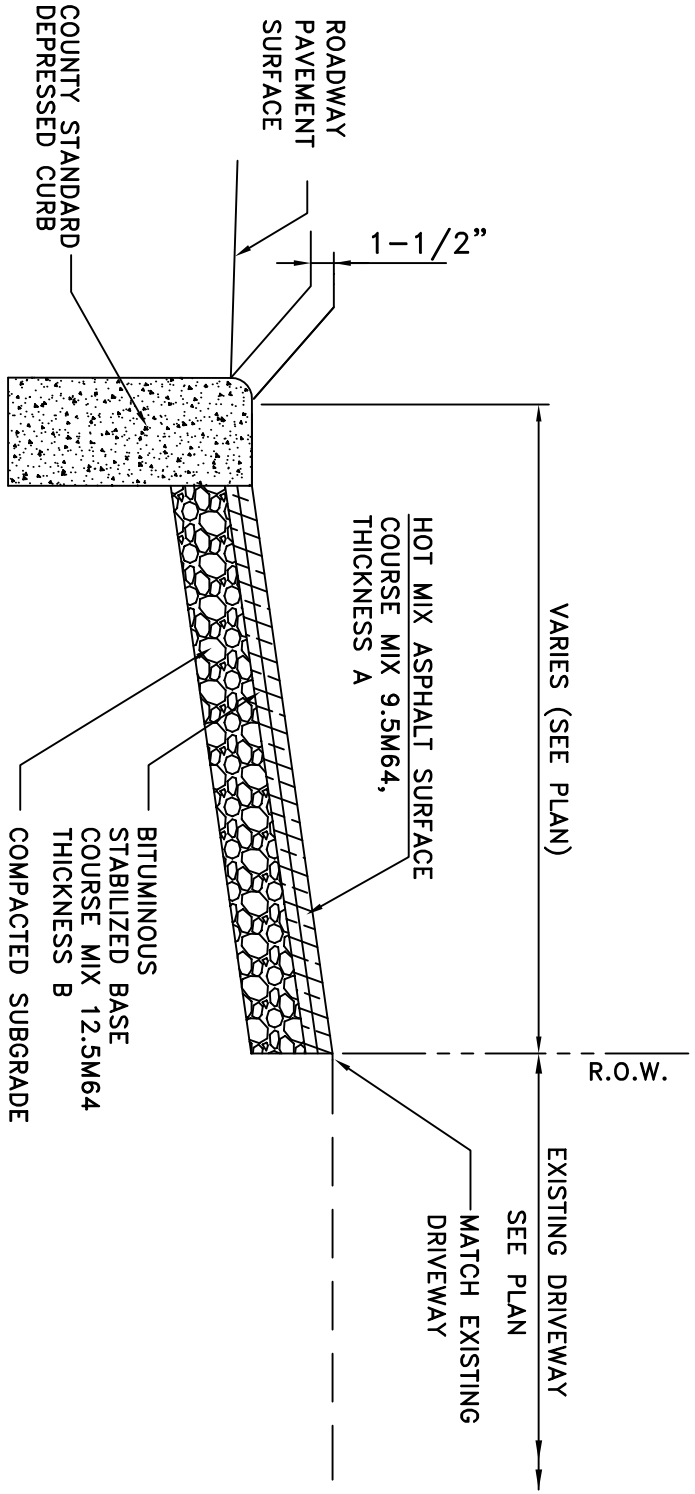

	INCHES	INCHES
BIT. CONCRETE		
TOP PAVE A	1 1/2	2
BASE PAVE B	2 1/2	2
TOTAL THICKNESS	4	4

NOTES:

1. THE DRIVEWAY IN THE COUNTY RIGHT-OF-WAY SHALL BE COMPOSED OF TOP COURSE AND BASE COURSE WITH A TOTAL THICKNESS OF 4 INCHES (SEE TABLE).
2. CURB JOINT SHALL BE TROWELED WITH A MIN 1/2" RADIUS ALONG BACK OF CURB. COUNTY RIGHT-OF-WAY.
3. A DRIVEWAY APRON MAY NOT IMPEDE THE FLOW OF STORMWATER.
4. A ROAD OPENING PERMIT IS REQUIRED BEFORE START OF CONSTRUCTION IN THE COUNTY RIGHT-OF-WAY.

DETAIL 7 STANDARD BITUMINOUS DRIVEWAY APRON TYPE 1

N.T.S.

	<b>CAMDEN COUNTY</b> DEPARTMENT OF PUBLIC WORKS DIVISION OF PLANNING CHARLES J. DEPALMA PUBLIC WORKS COMPLEX 2311 EGG HARBOR ROAD NEW JERSEY 08021	<b>CAMDEN COUNTY</b> DEPARTMENT OF PUBLIC WORKS SAM MARTELLO, DIRECTOR KEVIN BECKA, P.E., P.P., C.M.E., C.F.M. 2311 TUNN HANCOCK ROAD LINDENWOLD, NEW JERSEY 08021	TITLE  COUNTY STANDARD BITUMINOUS DRIVEWAY APRON DETAIL	DATE MARCH 2014 DRAWN BY T.A.P. APPROVED BY K.B./A.L.	SH. NO. <span style="border: 1px solid black; border-radius: 50%; padding: 5px;">1</span>
--	---	---	---	--	--

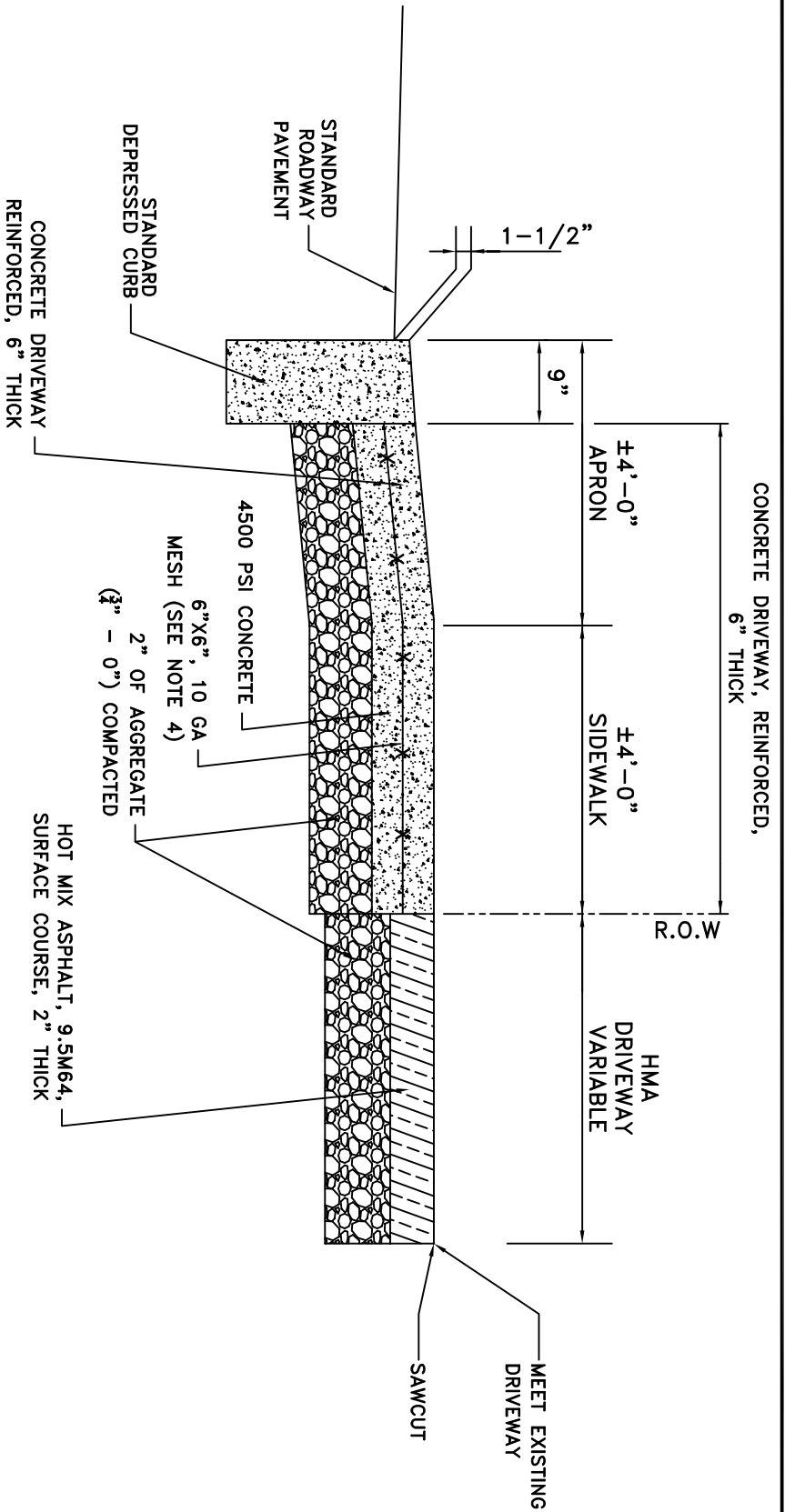

**NOTES:**

1. CONCRETE SHALL BE CLASS B WITH 28 DAY COMPRESSIVE STRENGTH OF 4500 PSI, 6% ±1.5% AIR ENTRAINMENT.
2. CURB JOINT SHALL BE TROWELED WITH A MIN 1/2" RADIUS ALONG BACK OF CURB.
3. EXPANSION AND CONTRACTION JOINTS SHALL BE 1/2" PREMOLED ASPHALT IMPREGNATED MATERIAL OR EQUAL EXTENDING FROM SUBGRADE TO FINISH GRADE.
4. 6" X 6" 10 GA MESH REQUIRED FOR COMMERCIAL DRIVEWAYS ONLY, 6" X 6" WELDED WIRE MESH REQUIRED FOR RESIDENTIAL DRIVEWAYS.

**DETAIL 8 STANDARD HOT MIX ASPHALT DRIVEWAY SECTION**

N.T.S.

ADJACENT TO REINFORCED CONCRETE SIDEWALK AND APRON

No.	DATE	REVISIONS	CAMDEN COUNTY DEPARTMENT OF PUBLIC WORKS DIVISION OF PLANNING CHARLES J. DEPALMA PUBLIC WORKS COMPLEX 2311 EGG HARBOR ROAD NEW JERSEY 08021	CAMDEN COUNTY DEPARTMENT OF PUBLIC WORKS SAM MARTELLO, DIRECTOR KEVIN BEGICA, P.E., P.E. C.M.E. CFM 2311 EGG HARBOR ROAD LINDENWOLD, NEW JERSEY 08021	TITLE COUNTY STANDARD HOT MIX ASPHALT DRIVEWAY ADJACENT TO REINFORCED CONCRETE SIDEWALK AND APRON	DATE MAR 2014 DRAWN BY T.A.P APPROVED BY K.B./A.L.	SHT. NO. 1
-----	------	-----------	--	--	---	---	---------------



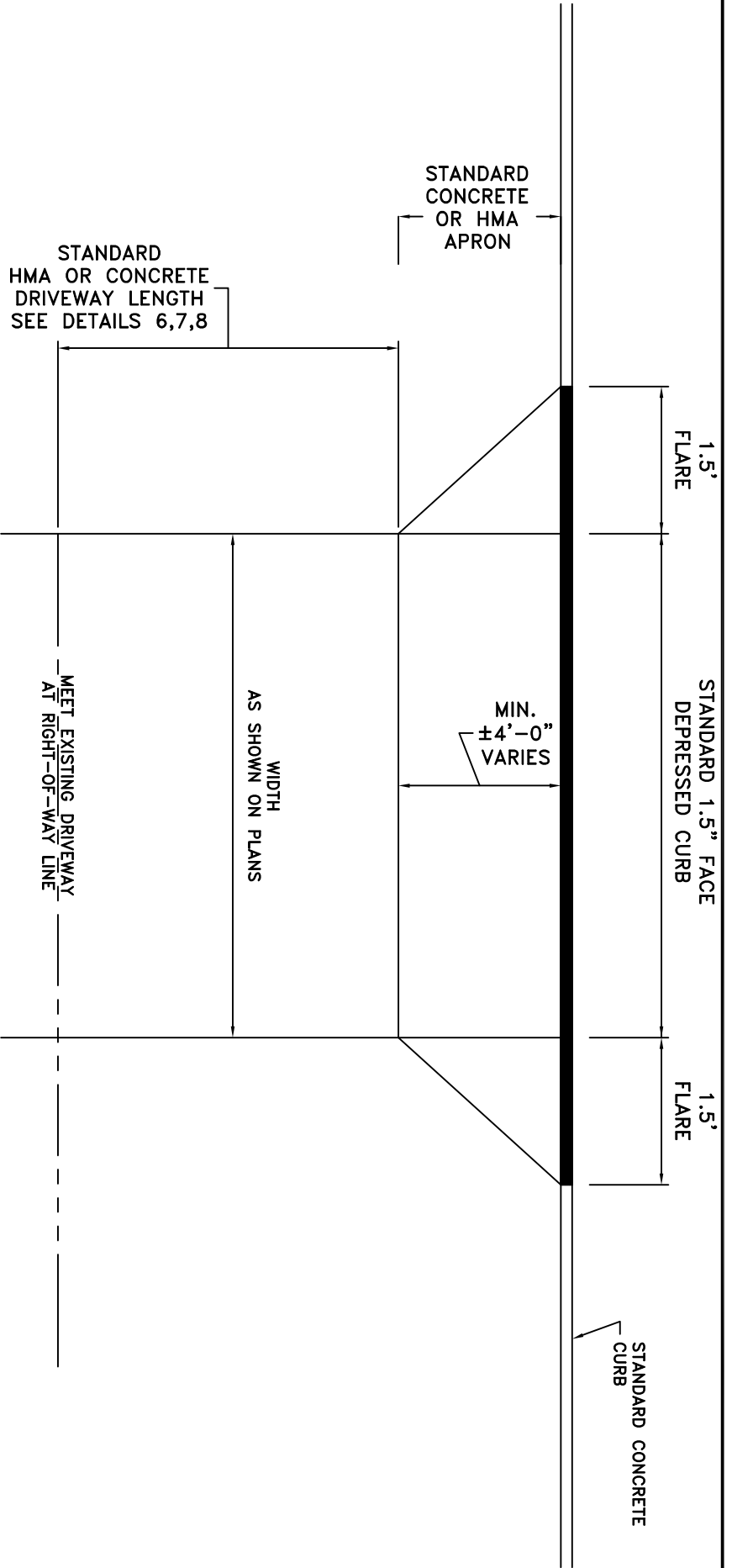

- NOTES:**
1. LENGTH AND WIDTH OF DRIVEWAY SHALL BE SHOWN ON THE PLANS OR AS DIRECTED.
  2. DEPRESSED CURB SHALL BE CONSTRUCTED AS PER COUNTY DEPRESSED CURB DETAIL.
  3. A DRIVEWAY APRON MAY NOT IMPEDE THE FLOW OF STORMWATER.

DETAIL 9 STANDARD DRIVEWAY TREATMENT  
 APRON AND FLARE  
 (PLAN VIEW)  
 N.T.S.

No.	DATE	REVISIONS	CAMDEN COUNTY		TITLE	DATE	SHT. NO.
			DEPARTMENT OF PUBLIC WORKS DIVISION OF PLANNING CHARLES J. DEPALMA PUBLIC WORKS COMPLEX 2311 BOG HANCOCK ROAD NEW JERSEY 08021	DEPARTMENT OF PUBLIC WORKS SAM MARTELLO, DIRECTOR KEVIN BECICA, P.E., C.M.E., C.F.M. 2311 SUNNYSIDE AVENUE LINCOLNWOOD, NEW JERSEY 08021			

# PAVEMENT MARKING LEGEND

UNLESS OTHERWISE SHOWN, PAVEMENT MARKINGS SHALL CONFORM TO THE FOLLOWING:

- STOP LINE (24" SWL)
    - 24" WIDE WHITE LINE
  - CENTER LINE (4" CL)
    - 2-4" WIDE YELLOW LINES
  - TWO WAY LEFT TURN LANE LINES (4" SYL) (4" DYL)
    - 4" WIDE YELLOW LINE
    - 4" WIDE YELLOW LINE, 10' LONG AT 30' INTERVALS
  - DASHED LANE LINE (4" DWL)
    - 4" WIDE WHITE LINE, 10' LONG AT 30' INTERVALS
  - LANE EXTENSION GUIDE LINES
    - 4" WIDE WHITE LINE, 2' LONG AT 4' INTERVALS
  - SOLID LANE LINE--EXCLUSIVE MOVEMENT (8" SWL)
    - 8" WIDE WHITE LINE
  - SOLID LANE LINE-- ALL OTHERS (4" SWL)
    - 4" WIDE WHITE LINE
  - CROSSWALK LINES (6" SWL)
    - 6" WIDE WHITE LINES
  - MEDIAN CROSS HATCH LINES (24" CHL)
    - 24" WIDE YELLOW LINES AT 45° SPACED 12' O.C.
  - GORE CROSS HATCH LINES (24" CHL)
    - 24" WIDE WHITE LINES AT 45° SPACED 12' O.C.
  - ISLAND CHANNELIZATION LINE
    - 8" WIDE WHITE LINE
  - RIGHT SHOULDER LINE
    - 4" WIDE WHITE LINE
  - LEFT SHOULDER LINE
    - 8" WIDE YELLOW LINE
- 1) ALL TRAFFIC CONTROL DEVICES SHALL CONFORM TO THE 2009 EDITION MANUAL ON UNIFORM TRAFFIC CONTROL DEVICES
  - 2) NEAREST CROSSWALK LINE IS TO BE LOCATED A MINIMUM OF 4' FROM THE STOP LINE.
  - 3) W = WHITE STRIPE  
Y = YELLOW STRIPE
  - 4) ALL DIMENSIONS SHOWN ARE FROM THE CENTER OF ALL PAVEMENT MARKING LINES.

## DETAIL 10 STANDARD PAVEMENT MARKING LEGEND

N.T.S.

No.	DATE	REVISIONS	<b>CAMDEN COUNTY</b> DEPARTMENT OF PUBLIC WORKS DIVISION OF PLANNING CHARLES J. DEPALMA PUBLIC WORKS COMPLEX 2311 BOG HANCOCK ROAD NEW JERSEY 08021		<b>CAMDEN COUNTY</b> DEPARTMENT OF PUBLIC WORKS SAM MARTELLO, DIRECTOR KEVIN BECICA, P.E., P.E., C.M.E., C.F.M. 2311 BOG HANCOCK ROAD UNDERWOOD, NEW JERSEY 08021		TITLE	COUNTY STANDARD PAVEMENT MARKING LEGEND	DATE MAR 2014	DRAWN BY T.A.P	APPROVED BY K.B./A.L.	SHT. NO. 1
-----	------	-----------	--	--	--	--	-------	---	------------------	-------------------	--------------------------	---------------

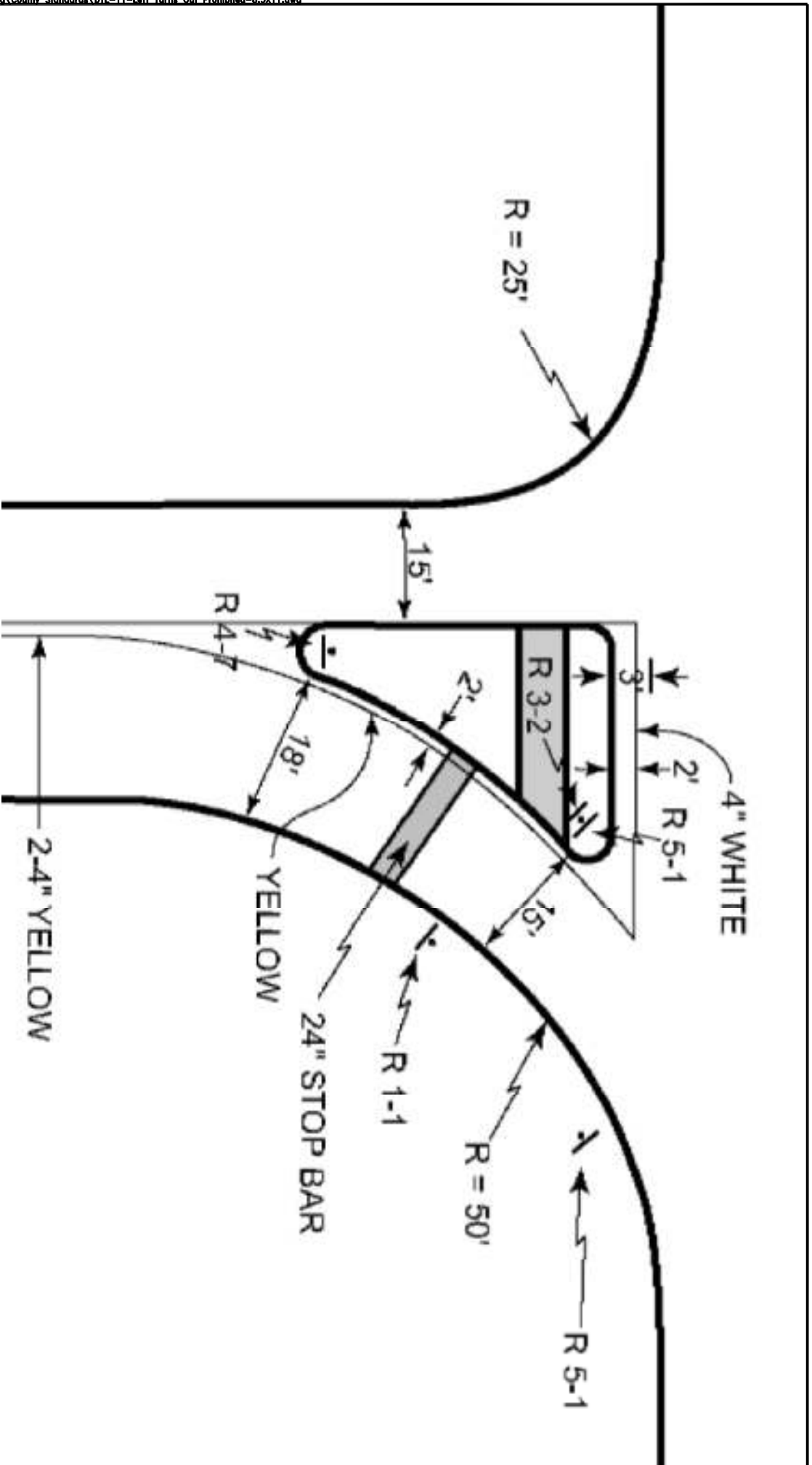

- NOTES:**
1. THE RADIUS SHOWN AT ALL CURB RETURNS ARE FOR REFERENCE PURPOSE ONLY. THE ARCHITECT/ENGINEER TO ADJUST THE RADIUS PER SITE CONDITIONS AND STANDARD DESIGN VEHICLE.
  2. THE SIGN DESIGNATIONS SHOWN ON THE DETAIL ARE STANDARD SIGNS PER MUTCD. REFER MUTCD SECTION 2 FOR STANDARD SIGN AND PLAQUE SIZES AND FURTHER DETAILS.
  3. THE LANE WIDTHS SHOWN ON THE DETAIL IS FOR REFERENCE PURPOSE ONLY. THE ARCHITECT/ENGINEER TO ADJUST LANE WIDTHS PER SITE CONDITIONS AND STANDARD DESIGN VEHICLE.

DETAIL **11** STANDARD LEFT TURN OUT  
 N.T.S. PROHIBITED DETAIL

No.	DATE	REVISIONS	CAMDEN COUNTY DEPARTMENT OF PUBLIC WORKS DIVISION OF PLANNING CHARLES J. DEPALMA PUBLIC WORKS COMPLEX 2311 EGG HARBOR ROAD NEW JERSEY 08021	CAMDEN COUNTY DEPARTMENT OF PUBLIC WORKS SAM MARTELLO, DIRECTOR KEVIN BECICA, P.E., P.P., C.M.E., C.F.M. 2311 SUNNYSIDE AVENUE LINDENWOLD, NEW JERSEY 08021	TITLE	COUNTY STANDARD LEFT TURN OUT PROHIBITED DETAIL	DATE MAR 2014 DRAWN BY T.A.P APPROVED BY K.B./A.L.	SHT. NO. 1
-----	------	-----------	--	--	-------	---	---	---------------

OPPOSITE  
EDGE OF PAVEMENT

R3-2

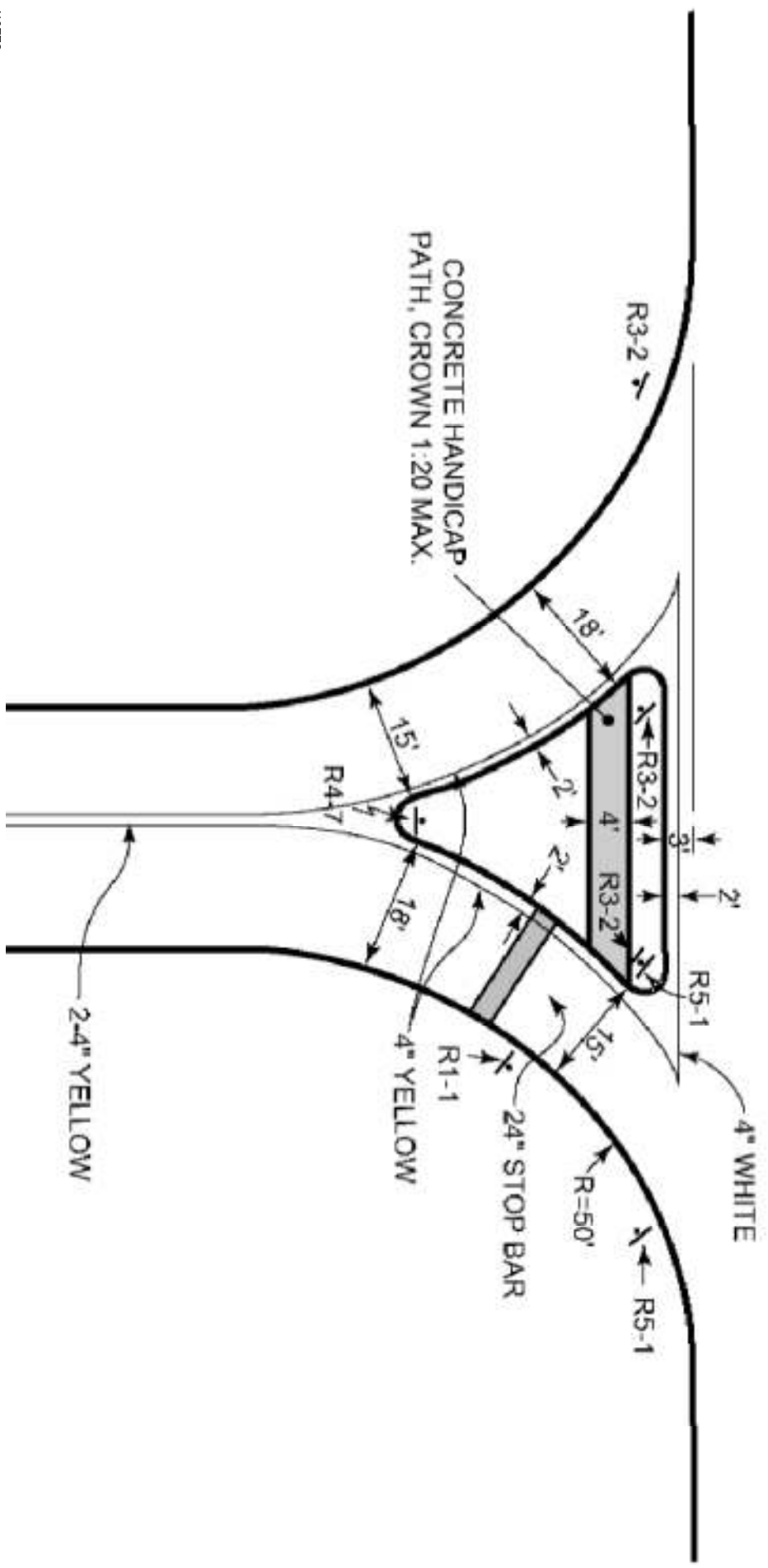

- NOTES:
1. THE RADIUS SHOWN AT ALL CURB RETURNS ARE FOR REFERENCE PURPOSE ONLY. THE ARCHITECT/ENGINEER TO ADJUST THE RADIUS PER SITE CONDITIONS AND STANDARD DESIGN VEHICLE.
  2. THE SIGN DESIGNATIONS SHOWN ON THE DETAIL ARE STANDARD SIGNS PER MUTCD. REFER MUTCD SECTION 2 FOR STANDARD SIGN AND PLAQUE SIZES AND FURTHER DETAILS.
  3. THE LANE WIDTHS SHOWN ON THE DETAIL IS FOR REFERENCE PURPOSE ONLY. THE ARCHITECT/ENGINEER TO ADJUST LANE WIDTHS PER SITE CONDITIONS AND STANDARD DESIGN VEHICLE.

DETAIL 12 STANDARD LEFT TURN IN AND

LEFT TURN OUT PROHIBITED DETAIL

N.T.S.

No.	DATE	REVISIONS	CAMDEN COUNTY DEPARTMENT OF PUBLIC WORKS DIVISION OF PLANNING CHARLES J. DEPALMA PUBLIC WORKS COMPLEX 2311 EGG HARBOR ROAD NEW JERSEY 08021	CAMDEN COUNTY DEPARTMENT OF PUBLIC WORKS SAM MARTELLO, DIRECTOR KEVIN BECICA, P.E., P.E. CMC, CFM 2311 EGG HARBOR ROAD UNDERWOOD, NEW JERSEY 08021	TITLE COUNTY STANDARD LEFT TURN IN AND LEFT TURN OUT PROHIBITED DETAIL	DATE MAR 2014	DRAWN BY T.A.P	APPROVED BY K.B./A.L.	SHT. NO. 1
-----	------	-----------	--	---	---	------------------	-------------------	--------------------------	---------------

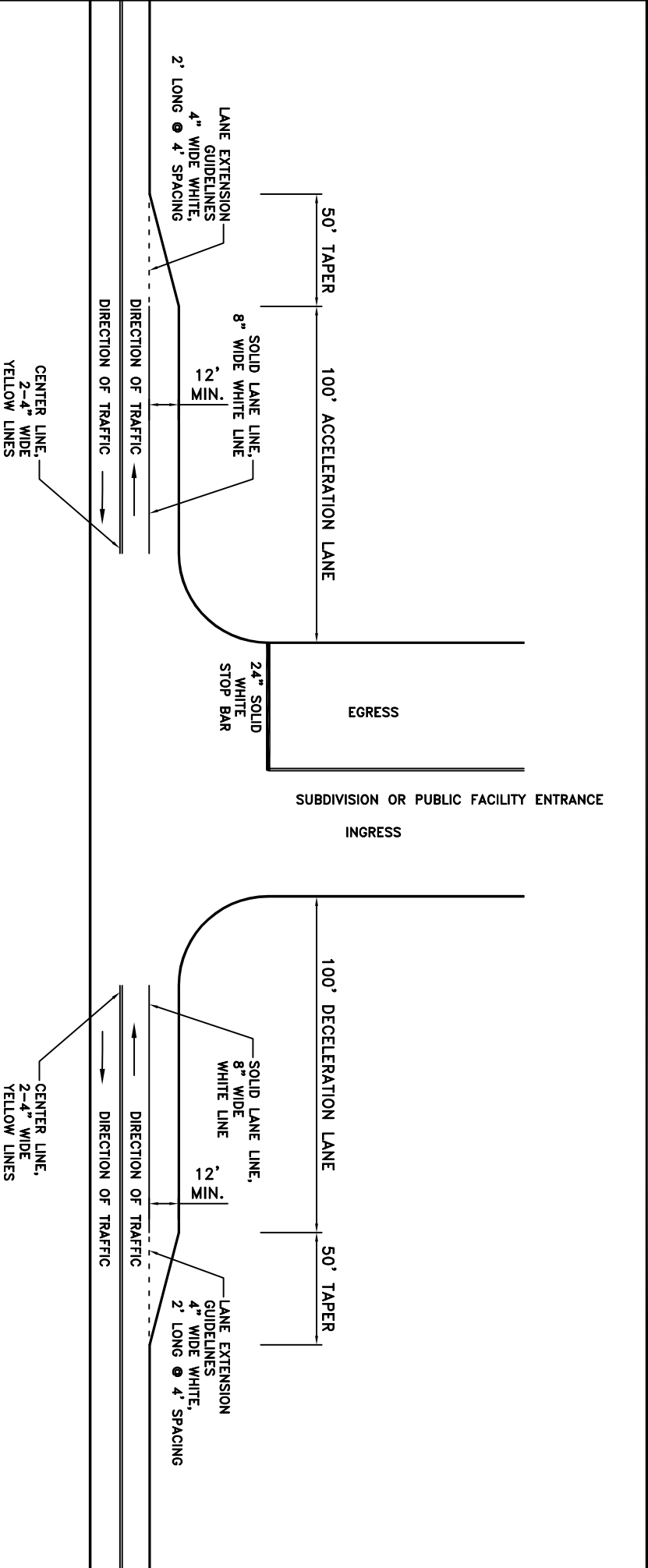

**NOTES:**

1. ACCELERATION LANES SHALL ONLY BE REQUIRED IN SPECIAL CIRCUMSTANCES WHERE TRAFFIC OR OTHER CONDITIONS INDICATE THE NEED PER ASHTO STANDARDS.
2. FULL DEPTH SAWCUT THE EDGE OF EXISTING PAVEMENT TO RECEIVE THE NEW ACCEL/DECEL PAVEMENT. SEE TYPICAL COUNTY ROADWAY WIDENING DETAIL.
3. ACCEL/DECEL LANES SHALL CONTINUE THE SLOPE OF ADJACENT ROADWAY (2% MIN).

DETAIL 13 ACCELERATION AND DECELERATION LANES

N.T.S.

No.	DATE	REVISIONS
<p><b>CAMDEN COUNTY</b>                  DEPARTMENT OF PUBLIC WORKS                  DIVISION OF PLANNING                  CHARLES J. DEPALMA PUBLIC WORKS COMPLEX                  2311 EGG HARBOR ROAD                  NEW JERSEY 08021</p>		
<p><b>CAMDEN COUNTY</b>                  DEPARTMENT OF PUBLIC WORKS                  SAM MARTELLO, DIRECTOR                  KEVIN BECORA, P.E., C.M.E., C.P.M.                  2311 EGG HARBOR ROAD                  UNDERWOOD, NEW JERSEY 08021</p>		
TITLE		COUNTY STANDARD
ACCELERATION AND DECELERATION LANES		LANES
DATE	MAR 2014	SHT. NO. 1
DRAWN BY	T.A.P	
APPROVED BY	K.B./A.L.	

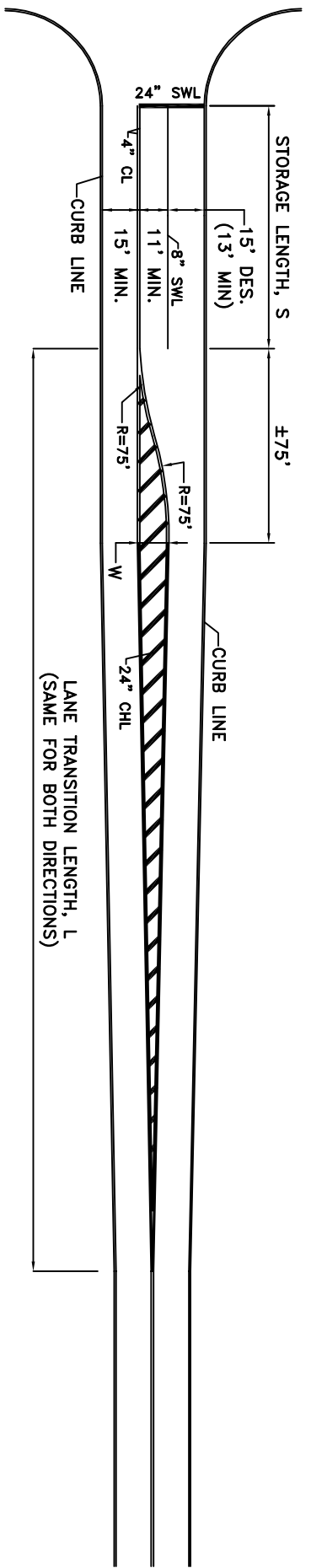

STRIPING PLAN WITH CURB

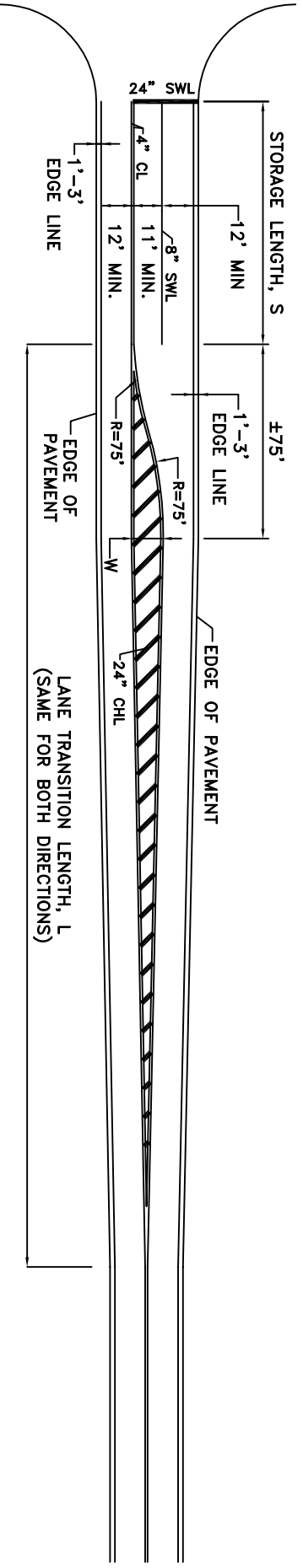

STRIPING PLAN WITHOUT CURB

NOTES:

1. FOR SIGNALIZED INTERSECTIONS, STORAGE LENGTH S IS BASED ON QUEUE ANALYSIS. FOR UNSIGNALIZED INTERSECTIONS MINIMUM RECOMMENDED STORAGE LENGTH IS 75'
2. FOR LANE TRANSITION LENGTH, L: SEE FIGURE:4-L, NDOT ROADWAY DESIGN MANUAL
3. FOR ALL PAVEMENT MARKINGS, SEE CAMDEN COUNTY PAVEMENT MARKING LEGEND DETAIL

DETAIL 14 LEFT TURN LANE AND TRANSITION DETAIL

N.T.S.

No.					
DATE					
REVISIONS					
CAMDEN COUNTY DEPARTMENT OF PUBLIC WORKS DIVISION OF PLANNING CHARLES J. DEPALMA PUBLIC WORKS COMPLEX 2311 EGG HARBOR ROAD NEW JERSEY 08021	CAMDEN COUNTY DEPARTMENT OF PUBLIC WORKS SAM MARTELLO, DIRECTOR KEVIN BECICA, P.E., P.P., C.M.E., C.P.M. 2311 COUNTY ENGINEER AND UNDERWOOD, NEW JERSEY 08021	TITLE	COUNTY STANDARD LEFT TURN LANE AND TRANSITION DETAIL	DATE MAR 2014	SHR. NO. 1
				DRAWN BY T.A.P.	
				APPROVED BY K.B./A.L.	

No.	
DATE	
REVISIONS	

**CAMDEN COUNTY**  
 DEPARTMENT OF PUBLIC WORKS  
 DIVISION OF PLANNING  
 CHARLES J. DEPALMA PUBLIC WORKS COMPLEX  
 2311 EGG HARBOR ROAD  
 NEW JERSEY 08021

**CAMDEN COUNTY**  
 DEPARTMENT OF PUBLIC WORKS  
 SAM MARTELLO, DIRECTOR  
 KEVIN BECICA, P.E., P.P. CHIEF, CFM  
 2311 EGG HARBOR ROAD  
 LINCOLNWOOD, NEW JERSEY 08021

TITLE  
 COUNTY STANDARD  
 CURB INLET WITH BICYCLE SAFE GRATE  
 AND TYPE 'N-ECO' CURB PIECE

DATE  
 MAR 2014  
 DRAWN BY  
 T.A.P.  
 APPROVED BY  
 K.B./A.L.

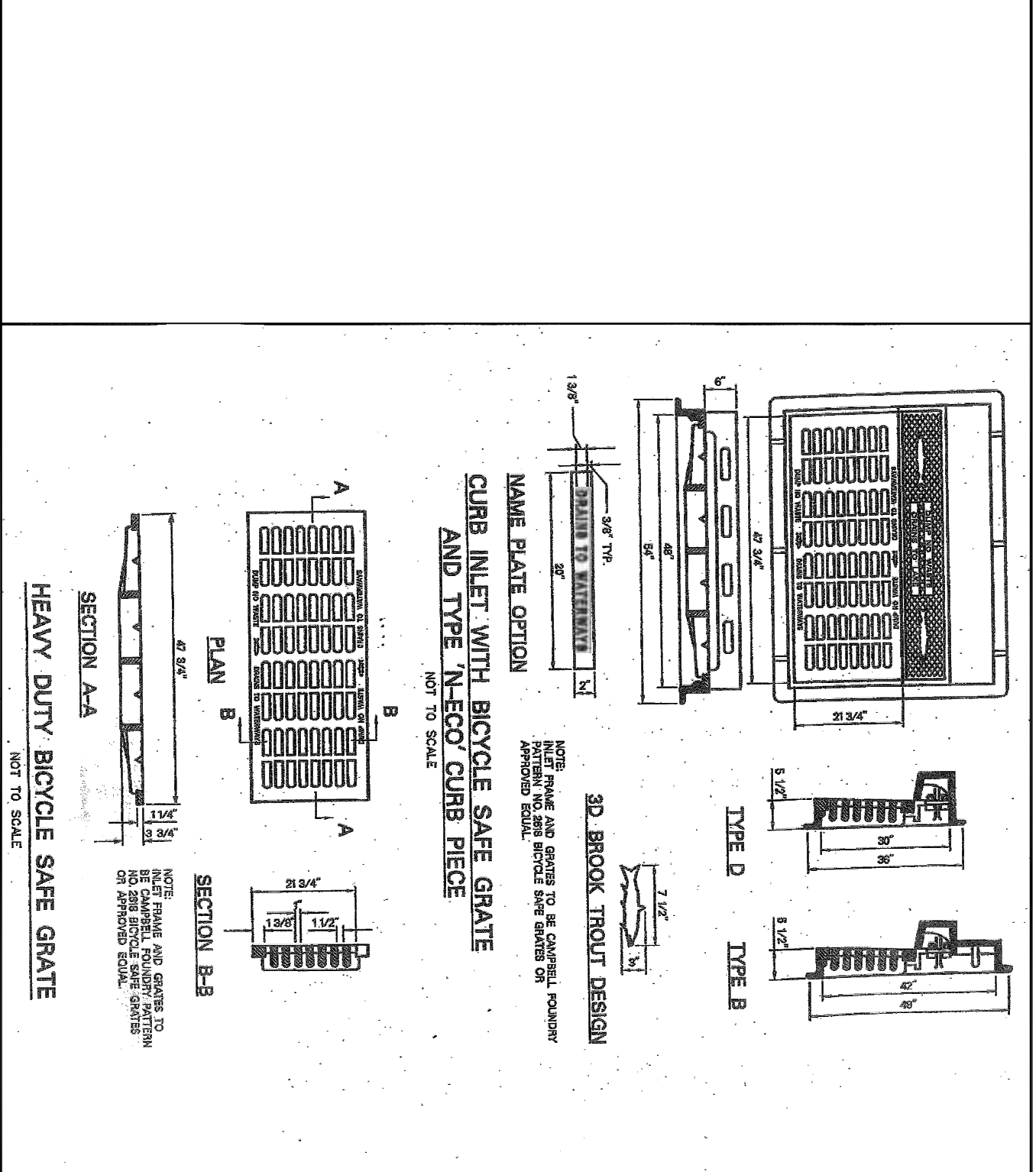

DETAIL 15 CURB INLET WITH BICYCLE SAFE GRATE AND TYPE 'N-ECO' CURB PIECE  
 N.T.S.

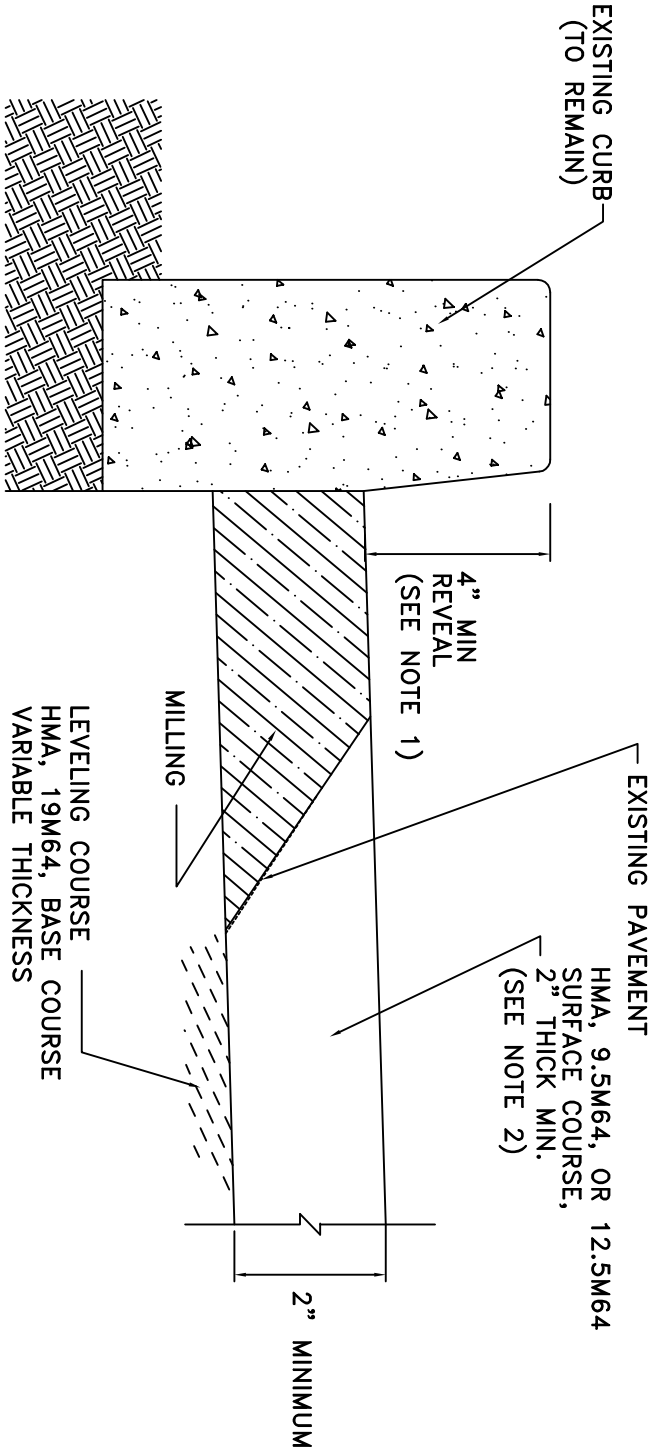

- NOTES:**
1. PROVIDE  $\frac{1}{2}$ " MINIMUM REVEAL AT DEPRESSED CURBS DURING MILL & RESURFACING.
  2. SURFACE COURSE MAY BE 9.5M64 FOR COUNTY ROADS WITH LESS THAN 5,000 AADT, SURFACE COURSE MUST BE 12.5M64 FOR COUNTY ROADS WITH EQUAL OR GREATER THAN 5000 AADT.

DETAIL 16 MILLING AND RESURFACING

N.T.S.

No.								
DATE								
	REVISIONS							
		<b>CAMDEN COUNTY</b> DEPARTMENT OF PUBLIC WORKS DIVISION OF PLANNING CHARLES J. DEPALMA PUBLIC WORKS COMPLEX 2311 EGG HARBOR ROAD NEW JERSEY 08021	<b>CAMDEN COUNTY</b> DEPARTMENT OF PUBLIC WORKS SAM MARTELLO, DIRECTOR KEVIN BECICA, P.E., P.P., C.M.E., C.F.M. 2311 EGG HARBOR ROAD LINCOLNWOOD, NEW JERSEY 08021	TITLE	COUNTY STANDARD MILLING AND RESURFACING DETAIL	DATE	MAR 2014 DRAWN BY T.A.P. APPROVED BY K.B./A.L.	
		1 <span style="border: 1px solid black; border-radius: 50%; padding: 2px 10px;">1</span>						SH. NO. 1



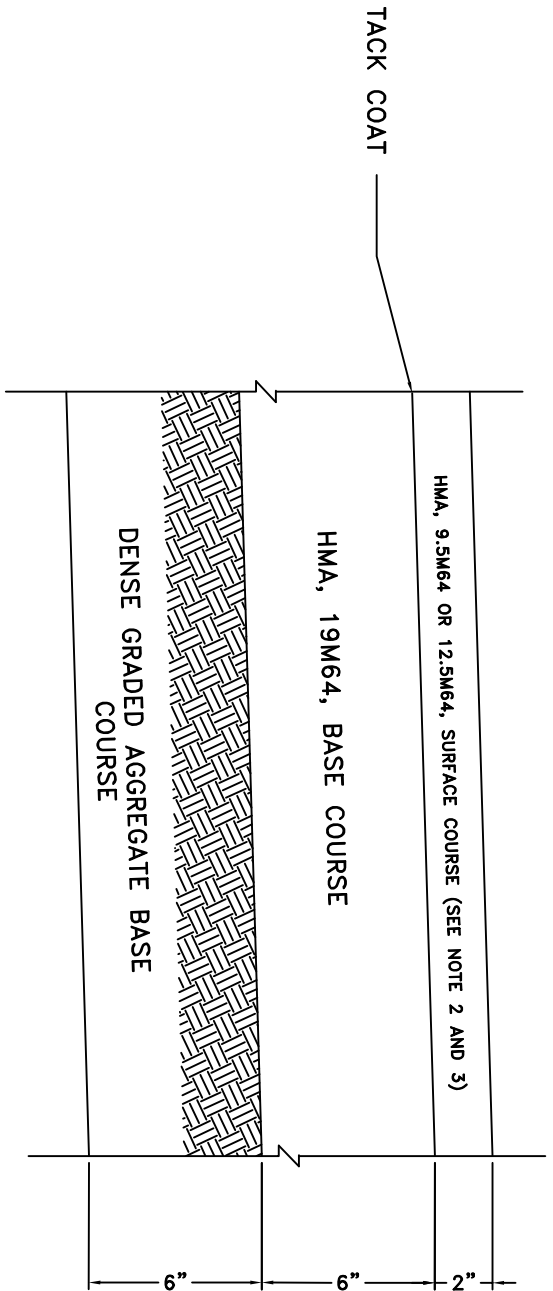

**NOTE:**

1. MIX NUMBERS ARE IN ACCORDANCE WITH NEW JERSEY DEPARTMENT OF TRANSPORTATION, STANDARD SPECIFICATIONS FOR ROAD AND BRIDGE CONSTRUCTION
2. SURFACE COURSE MAY BE 9.5M64 ON COUNTY ROADS WITH AADT LESS THAN 5,000.
3. SURFACE COURSE MUST BE 12.5M64 ON COUNTY ROADS WITH AADT EQUAL OR GREATER THAN 5,000.

DETAIL 17 HOT MIX ASPHALT PAVEMENT  
N.T.S.

No.					
DATE					
	REVISIONS				
		<b>CAMDEN COUNTY</b> DEPARTMENT OF PUBLIC WORKS DIVISION OF PLANNING CHARLES J. DEPALMA PUBLIC WORKS COMPLEX 2311 EGG HARBOR ROAD NEW JERSEY 08021	<b>CAMDEN COUNTY</b> DEPARTMENT OF PUBLIC WORKS SAM MARTELLO, DIRECTOR KEVIN BECICA, P.E., P.E., C.M.E., C.F.M. 2311 EGG HARBOR ROAD UNDERWOOD, NEW JERSEY 08021	TITLE	COUNTY STANDARD HOT MIX ASPHALT PAVEMENT DETAIL
				DATE	MAR 2014
				DRAWN BY	T.A.P
				APPROVED BY	K.B./A.L.
				SHT. NO.	1

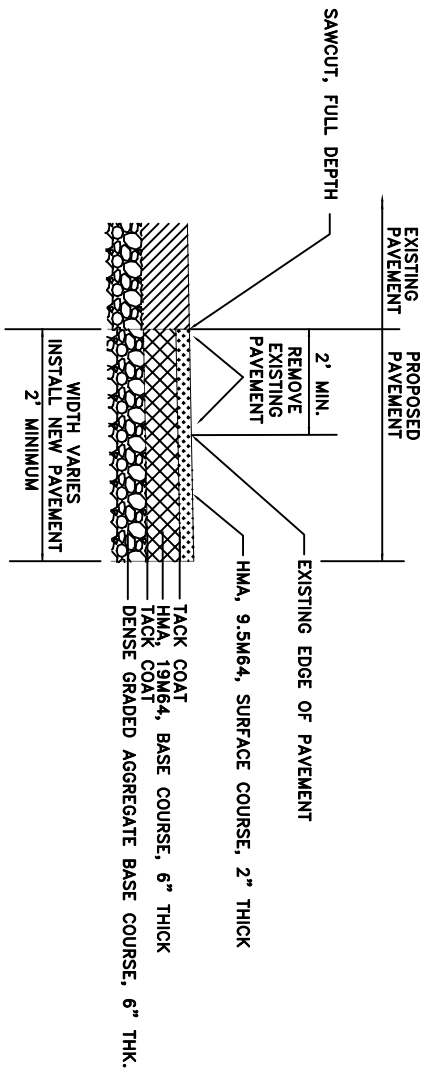

TYPICAL COUNTY PAVEMENT WIDENING  
(WITHOUT NEW CURB)

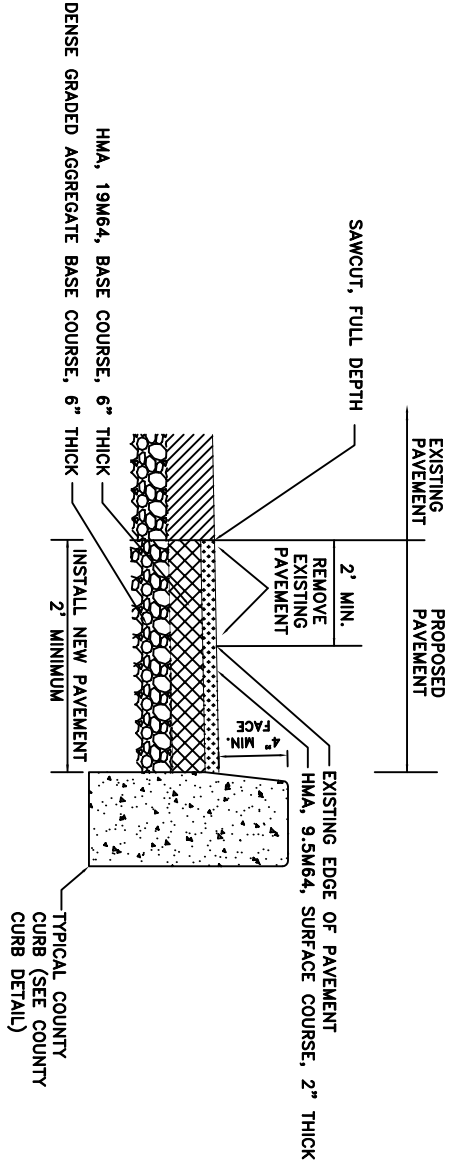

TYPICAL COUNTY PAVEMENT WIDENING (WITH NEW CURB) OR  
TYPICAL ROADWAY RESTORATION FOR CURB INSTALLATION

DETAIL 18 ROADWAY WIDENING / ROADWAY RESTORATION

N.T.S.

CAMDEN COUNTY DEPARTMENT OF PUBLIC WORKS DIVISION OF PLANNING CHARLES J. DEPALMA, PUBLIC WORKS COMPLEX 2311 EGG HARBOR ROAD NEW JERSEY 08021		CAMDEN COUNTY DEPARTMENT OF PUBLIC WORKS SAM MARTELLA, DIRECTOR KEVIN BECORA, P.E., P.P., C.M.E., C.F.M. 2311 EGG HARBOR ROAD UNDERWOOD, NEW JERSEY 08021		TITLE  COUNTY STANDARD ROADWAY WIDENING SECTIONS	DATE MAR 2014	SHT. NO. 1
REVISIONS					DRAWN BY T.A.P.	
					APPROVED BY K.B./A.L.	

NOTES:  
 BACKFILLING WITH EXCAVATED MATERIAL SHALL NOT BE PERMITTED IN TRENCHES FOR STORM SEWER & ALL OTHER UTILITIES.

DETAIL 19 RCP-STORM SEWER INSTALLATION.  
 N.T.S. & TRENCH RESTORATION DETAIL

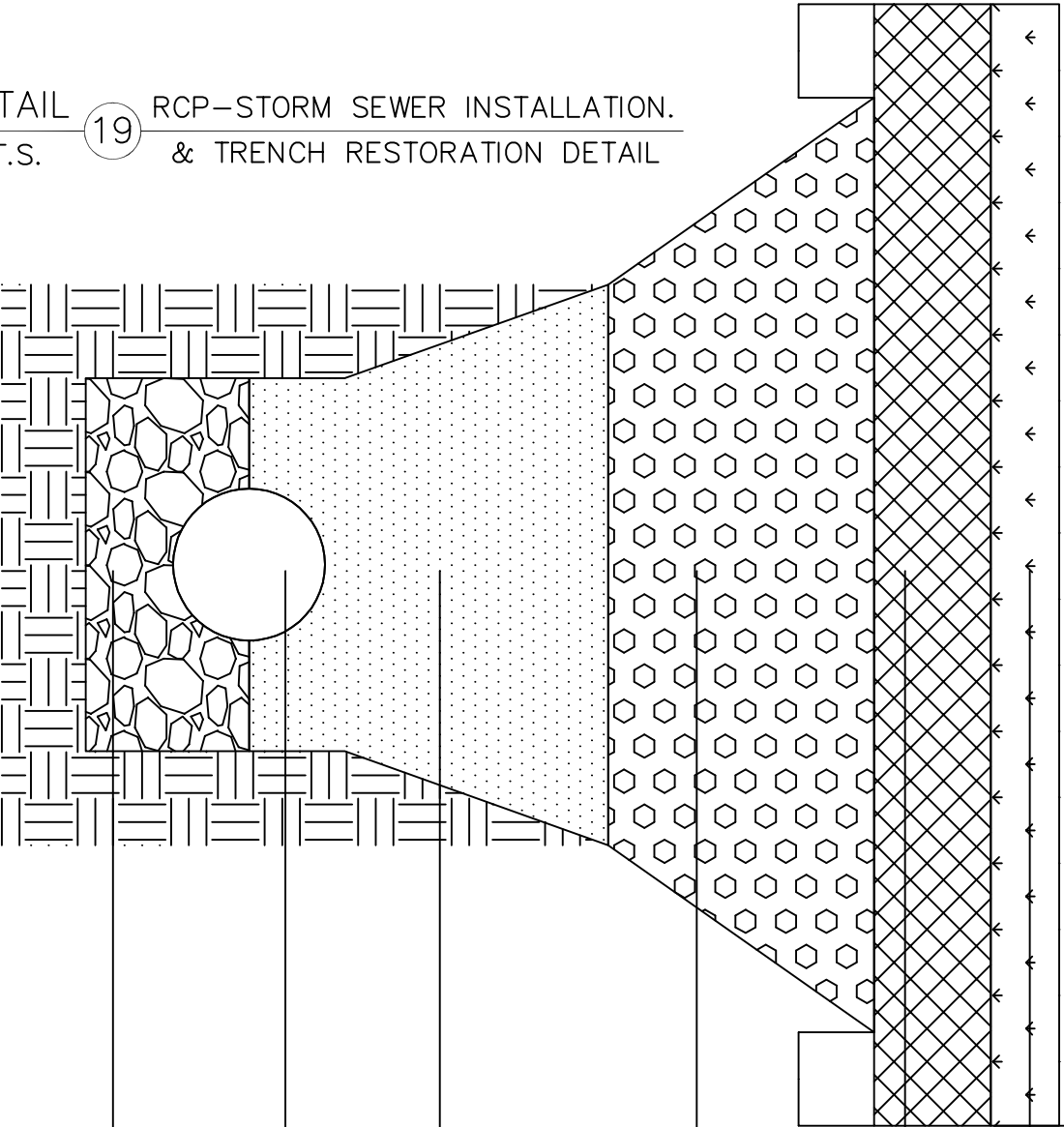

EXISTING PAVEMENT TO BE SAWCUT AND ALL EDGES TACKED (TYPICAL)

4"-6" TOPSOIL AND SEEDING FOR TRENCH RESTORATION THROUGH GRASSY AREAS

REFER TO PAVEMENT SECTION FOR TRENCH RESTORATION TROUGH PAVEMENT AREAS

6" DENSE GRADED AGGREGATE OR APPROVED EQUAL

SUITABLE EXCAVATED MATERIAL OR SELECT FILL AS DIRECTED BY THE ENGINEER COMPACTED TO 95% DENSITY

REINFORCED CONCRETE PIPE (VARIOUS DIAMETERS) ALL LIFT HOLES MUST BE SEALED WITH APPROVED MATERIAL, ALL JOINTS MUST BE SEALED WITH APPROVED MORTAR, AND JOINTS MUST BE WRAPPED WITH GEOTEXTILE FROM THE SPRING LINE ACROSS TOP OF PIPE

N.J.D.O.T. COARSE AGGREGATE NO. 57 COMPACTED TO 95% MAXIMUM DENSITY

No.	DATE	REVISIONS	CAMDEN COUNTY DEPARTMENT OF PUBLIC WORKS DIVISION OF PLANNING CHARLES J. DEPALMA PUBLIC WORKS COMPLEX 2311 EGG HARBOR ROAD NEW JERSEY 08021	CAMDEN COUNTY DEPARTMENT OF PUBLIC WORKS SAM MARTELLO, DIRECTOR KEVIN BECORA, P.E., P.P. C.M.E., C.P.M. 2311 EGG HARBOR ROAD LINDENWOLD, NEW JERSEY 08021	TITLE	COUNTY STANDARD TRENCH RESTORATION DETAIL IN PAVED AREA	DATE	MAR 2014 DRAWN BY T.A.P. APPROVED BY K.B./A.L.	SHT. NO. 1

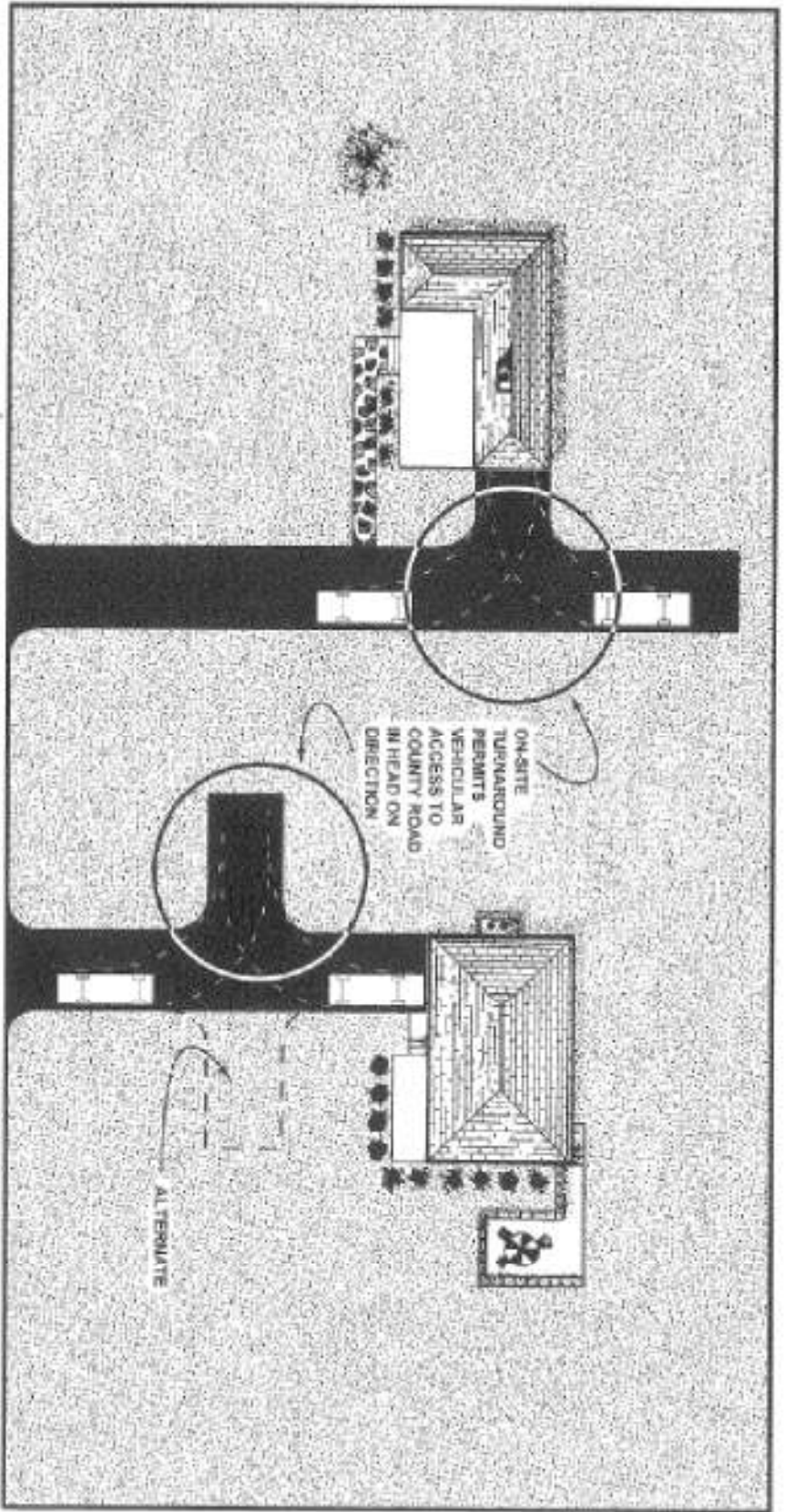

DETAIL 20 STANDARD DRIVEWAY TURNAROUNDS  
 (K - TURN DETAIL)  
 N.T.S.

No.	DATE	REVISIONS

**CAMDEN COUNTY**  
 DEPARTMENT OF PUBLIC WORKS  
 DIVISION OF PLANNING  
 CHARLES J. DEPALMA PUBLIC WORKS COMPLEX  
 2311 EGG HARBOR ROAD  
 NEW JERSEY 08021

**CAMDEN COUNTY**  
 DEPARTMENT OF PUBLIC WORKS  
 SAM MARTELLO, DIRECTOR  
 KEVIN BEGICA, P.E., P.E. CMC, CFM  
 2311 EGG HARBOR ROAD  
 UNDERWOOD, NEW JERSEY 08021

TITLE  
 COUNTY STANDARD  
 DRIVEWAY TURNAROUNDS  
 (K-TURN DETAIL)

DATE  
 MAR 2014  
 DRAWN BY  
 T.A.P  
 APPROVED BY  
 K.B./A.L.

SHT. NO.  
 1

# REVERSE FRONTAGE

COUNTY ROAD

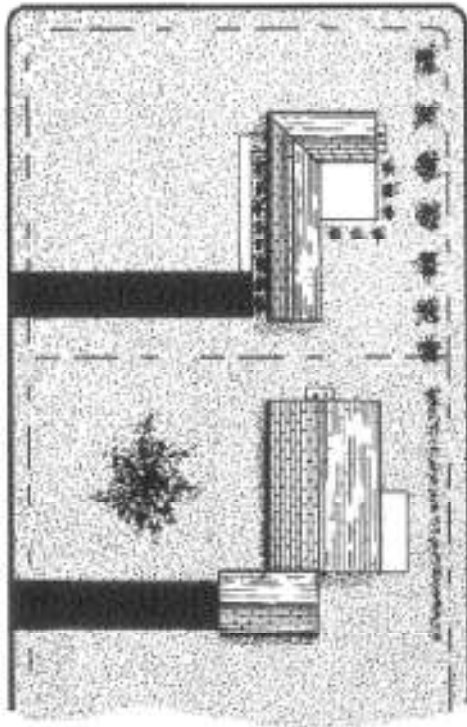
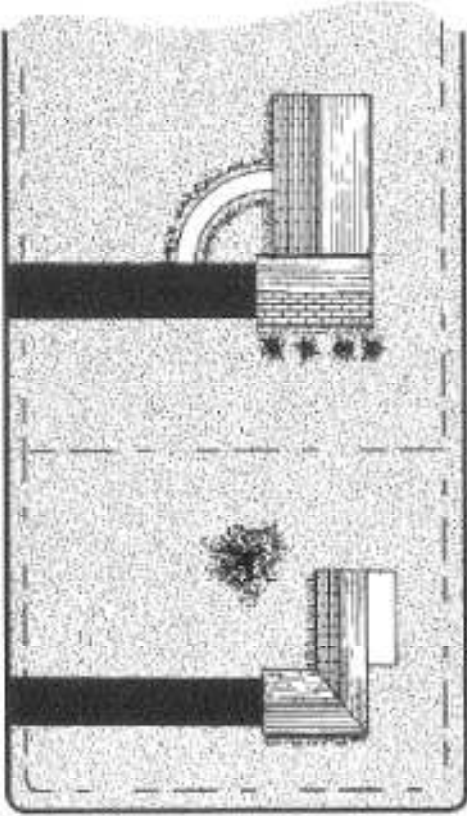

DETAIL **21** STANDARD REVERSE FRONTAGE  
 N.T.S. LOT DETAIL

No.	DATE	REVISIONS
CAMDEN COUNTY DEPARTMENT OF PUBLIC WORKS DIVISION OF PLANNING CHARLES J. DEPALMA PUBLIC WORKS COMPLEX 2311 EGG HARBOR ROAD NEW JERSEY 08021		CAMDEN COUNTY DEPARTMENT OF PUBLIC WORKS SAM MARTELLO, DIRECTOR KEVIN BECICA, P.E., C.M.E., C.F.M. 2311 EGG HARBOR ROAD LINCOLNWOOD, NEW JERSEY 08021
TITLE		COUNTY STANDARD REVERSE FRONTAGE LOT DETAIL
DATE	MAR 2014	
DRAWN BY	T.A.P	
APPROVED BY	K.B./A.L.	
SHT. NO.		1

Plotted: 7/10/2015 3:02 PM File Name: \\c:\pwworking\camden\_county\_standard\101-292-BYPASS\_AREA.dwg

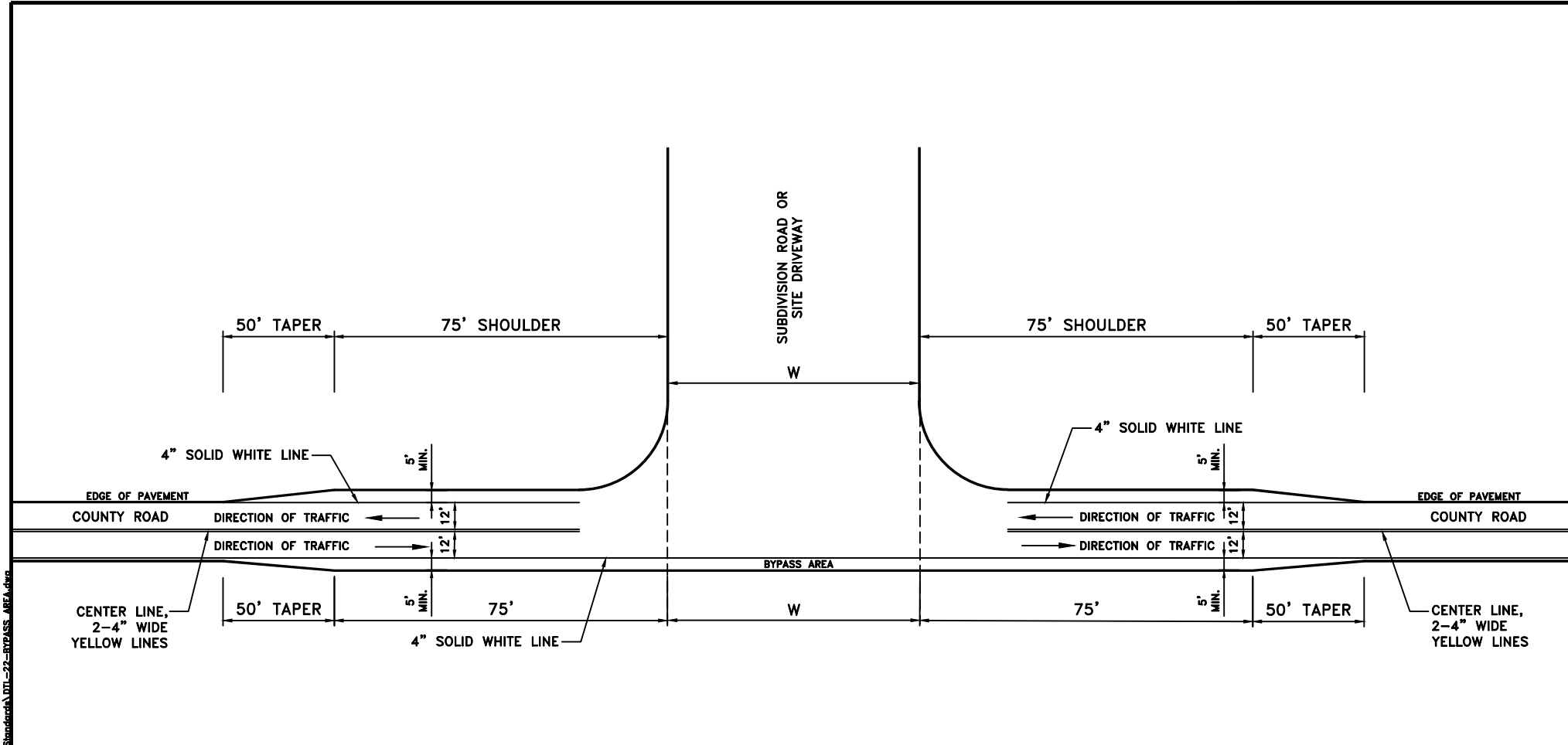

- NOTES:**
1. BYPASS AREA SHALL ONLY BE REQUIRED IN SPECIAL CIRCUMSTANCES WHERE TRAFFIC OR OTHER CONDITIONS INDICATE THE NEED.
  2. FULL DEPTH SAWCUT THE EDGE OF EXISTING PAVEMENT TO RECEIVE THE NEW BYPASS AREA PAVEMENT. SEE TYPICAL COUNTY ROADWAY WIDENING DETAIL.

DETAIL 22 BYPASS AREA  
 N.T.S.

No.	DATE	REVISIONS

**CAMDEN COUNTY**  
 DEPARTMENT OF PUBLIC WORKS  
 DIVISION OF PLANNING  
 CHARLES J. DEPALMA PUBLIC WORKS COMPLEX  
 2311 EGG HARBOR ROAD  
 LINDENWOLD  
 NEW JERSEY 08021

**CAMDEN COUNTY**  
 DEPARTMENT OF PUBLIC WORKS  
 SAM MARTELLO, DIRECTOR  
 KEVIN BECICA, PE, PP, CME, CFM  
 COUNTY ENGINEER  
 2311 EGG HARBOR ROAD  
 LINDENWOLD, NEW JERSEY 08021

TITLE  
 COUNTY STANDARD  
 BYPASS AREA

DATE  
 JUNE 2015  
 DRAWN BY  
 T.A.P./K.J.S.  
 APPROVED BY  
 K.B./A.L.

SHT. NO.  
1  
1

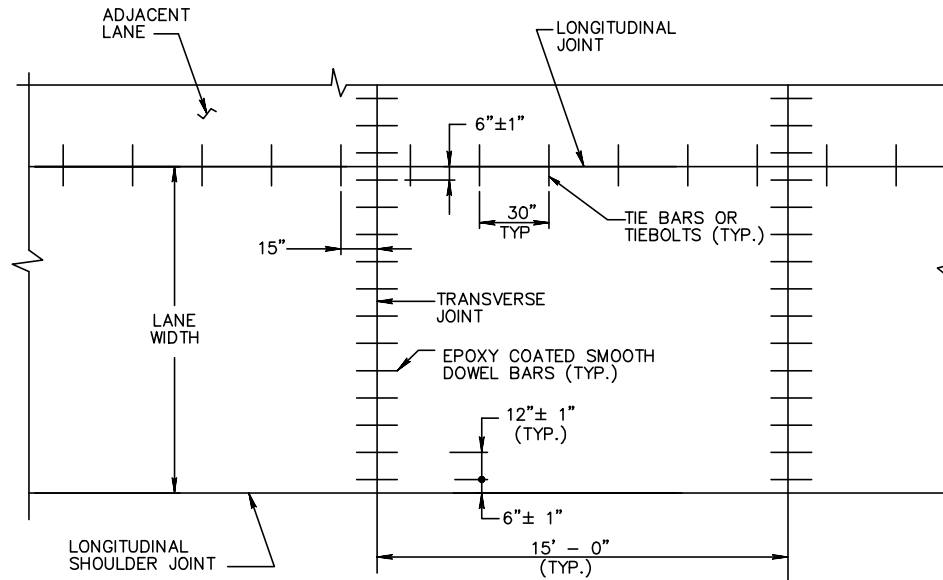

TYPICAL LAYOUT

SEE DETAIL A, B, OR C  
(SHT. 3 OF 4)

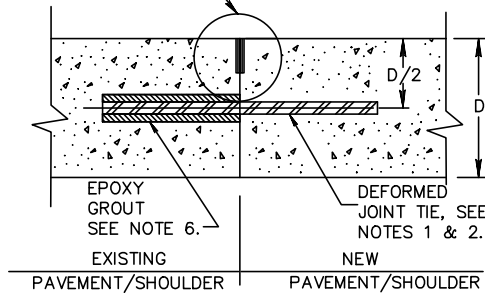

LONGITUDINAL JOINT  
WHEN TYING INTO EXISTING  
CONCRETE PAVEMENT/SHOULDER

NOTES :

1. SPECIFY #6 TIE BARS 30"± 1/4" LONG, SPACED 30" CENTER TO CENTER MAXIMUM. FOR JOINT TIES SPECIFY #6 BARS 18"±1/4" LONG, SPACED 30" CENTER TO CENTER MAXIMUM. PLACE PERPENDICULAR TO AND CENTERED OVER THE LONGITUDINAL JOINT ±1". WHEN ADJOINING TO AN UNEQUAL PAVEMENT OR SHOULDER DEPTH, D IS THE DEPTH OF THE THINNER SECTION.
2. DO NOT FIELD BEND TIE BARS, TIE BOLTS, AND JOINT TIES.
3. USE REBAR COUPLING DEVICE THAT IS LISTED ON THE QPL.
4. TEMPORARILY SECURE THE TIE BOLT TO THE FORM DURING PLACEMENT OF THE CONCRETE USING A METHOD ACCPETABLE TO THE R.E..
5. PLACE TIE BOLTS AT 30" CENTER TO CENTER MAXIMUM SPACING. WHEN ADJOINING TO AN UNEQUAL PAVEMENT OR SHOULDER DEPTH, D IS THE DEPTH OF THE THINNER SECTION. SCREW TIE BOLTS UNTIL SNUG.
6. USE AN APPROVED EPOXY GROUT MATERIAL TO WITHSTAND THE NECESSARY MINIMUM PULL-OUT RESISTANCE. TIE BAR HOLE DIAMETER IN EXISTING PAVEMENT SHOULD BE AS PER MANUFACTURER'S RECOMMENDATION. USE ROTARY IMPACT DRILL TO AVOID IMPACTING FINES INTO HOLE.
7. DO NOT USE THE HOOK COMPONENT OF THE TIE BOLT ASSEMBLY WHEN SLIP FORMING.
8. WHEN COLD-POURED JOINT SEALER IS SELECTED FOR USE IN TRANSVERSE JOINTS, USE THE SAME JOINT SEALING MATERIAL IN THE LONGITUDINAL JOINTS.

DETAIL 23 CONCRETE PAVEMENT REPAIR CONSTRUCTION DETAILS

N.T.S.

No.	DATE	REVISIONS

**CAMDEN COUNTY**  
DEPARTMENT OF PUBLIC WORKS  
DIVISION OF PLANNING  
CHARLES J. DEPALMA PUBLIC WORKS COMPLEX  
2311 EGG HARBOR ROAD  
LINDENWOLD  
NEW JERSEY 08021

**CAMDEN COUNTY**  
DEPARTMENT OF PUBLIC WORKS  
SAM MARTELLA, DIRECTOR  
KEVIN BECICA, PE, PP, CME, CFM  
COUNTY ENGINEER  
2311 EGG HARBOR ROAD  
LINDENWOLD, NEW JERSEY 08021

TITLE  
COUNTY STANDARD  
CONCRETE PAVEMENT REPAIR  
CONSTRUCTION DETAILS

DATE  
JULY 2015  
DRAWN BY  
T.A.P./K.J.S.  
APPROVED BY  
K.B/A.L.

SHT. NO.  
1  
4

Plotfile: 7/10/2015 3:05 PM File Name: \\c:\pwworking\camden\camden\standards\01-23-Concrete\_Pavement\_Repair\_Constr\_Details.dwg

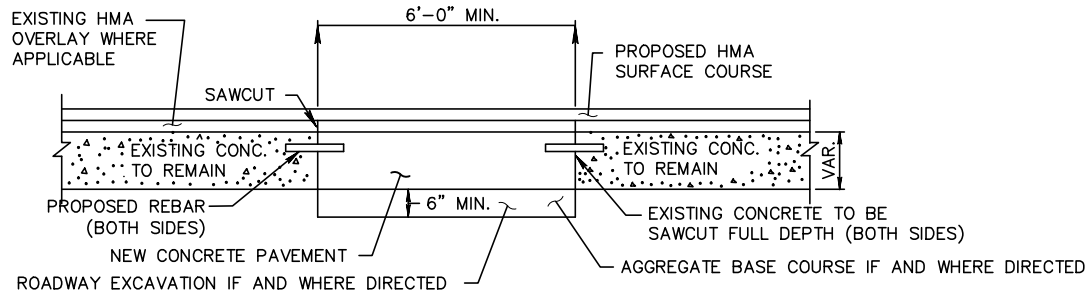

FULL DEPTH CONCRETE PAVEMENT REPAIR

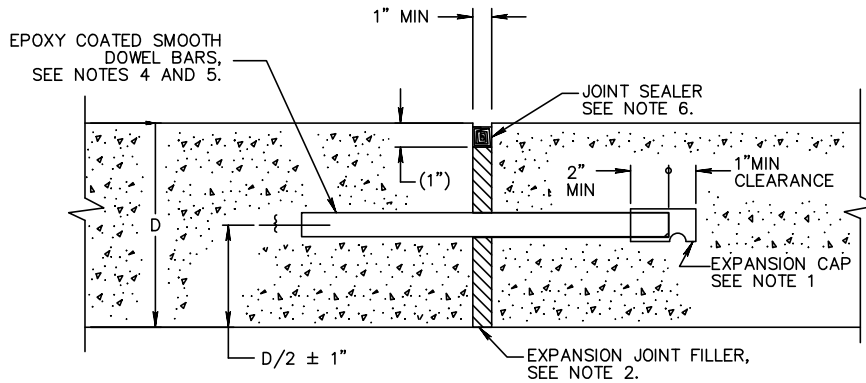

TRANSVERSE EXPANSION JOINT

NOTES :

1. PLACE A CLOSED-END EXPANSION CAP OVER THE LUBRICATED END OF ALL DOWEL BARS USED IN TRANSVERSE EXPANSION JOINTS AND PROVIDE A MINIMUM 1" CLEARANCE POCKET ASSURED BY MEANS OF A POSITIVE SPACING DEVICE.
2. CUT EXPANSION JOINT FILLER MATERIAL TO CONFORM TO THE CROSS SECTION OF THE PAVEMENT AND FURNISH IN STRIPS EQUAL TO THE WIDTH OF THE PAVEMENT SLAB. MAKE THE TOP SURFACE SMOOTH AND HAVE HOLES PUNCHED FOR THE DOWEL BARS PROVIDE A SNUG FIT WITHOUT LOSS IN THICKNESS OF THE MATERIAL.
3. CONSTRUCT ALL TRANSVERSE JOINTS PERPENDICULAR TO THE CENTERLINE.
4. USE MINIMUM 1 1/4" ~ x 18" LONG EPOXY COATED SMOOTH DOWEL BARS FOR PAVEMENT DEPTHS 10" OR LESS, AND MINIMUM 1 1/2" ~ X 18" LONG DOWEL BARS FOR PAVEMENT DEPTHS GREATER THAN 10". APPROVED ALTERNATE DOWEL BARS HAVING EQUIVALENT PROPERTIES TO CONVENTIONAL ROUND DOWEL REINFORCEMENT STEEL MAY BE PROPOSED FOR USE.
5. PLACE EPOXY COATED SMOOTH DOWEL BARS PARALLEL TO THE CENTERLINE AND SURFACE OF THE SLAB.
6. MAKE THE TOP OF THE JOINT SEALING MATERIAL 1/4" ± 1/8" BELOW THE SURFACE OF THE PAVEMENT.
7. THE INITIAL SAW CUT RELIEF JOINT IS NOT REQUIRED FOR CONSTRUCTION JOINTS.
8. WHEN COLD-POURED JOINT SEALER IS SELECTED FOR USE IN TRANSVERSE JOINTS, USE THE SAME JOINT SEALER IN THE LONGITUDINAL JOINTS.

DETAIL 24 CONCRETE PAVEMENT REPAIR CONSTRUCTION DETAILS

N.T.S.

Plotfile: 7/10/2015 3:08 PM File Name: \\c:\pwworking\camden\standards\01-24-Concrete\_Pavement\_Repair\_Constr\_Details.dwg

No.	DATE	REVISIONS

**CAMDEN COUNTY**  
DEPARTMENT OF PUBLIC WORKS  
DIVISION OF PLANNING  
CHARLES J. DEPALMA PUBLIC WORKS COMPLEX  
2311 EGG HARBOR ROAD  
LINDENWOLD  
NEW JERSEY 08021

**CAMDEN COUNTY**  
DEPARTMENT OF PUBLIC WORKS  
SAM MARTELLO, DIRECTOR  
KEVIN BECICA, PE, PP, CME, CFM  
COUNTY ENGINEER  
2311 EGG HARBOR ROAD  
LINDENWOLD, NEW JERSEY 08021

TITLE  
COUNTY STANDARD  
CONCRETE PAVEMENT REPAIR  
CONSTRUCTION DETAILS

DATE  
JULY 2015  
DRAWN BY  
T.A.P./K.J.S.  
APPROVED BY  
K.B./A.L.

SHT. NO.  
2  
4



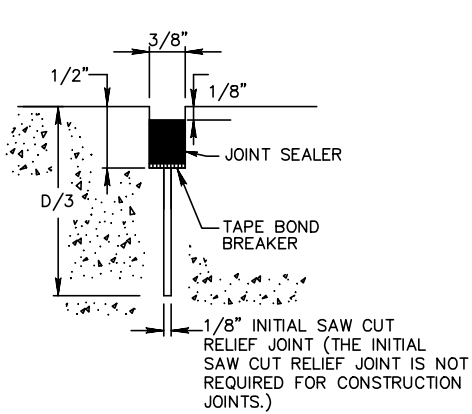

DETAIL A  
HOT-POURED JOINT SEALER

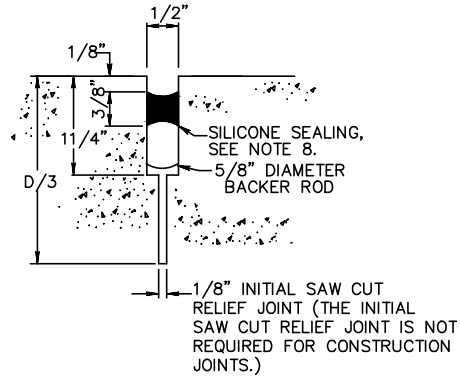

DETAIL B  
COLD-POURED JOINT SEALER  
WITH BACKER ROD  
(CAMDEN COUNTY  
PREFERRED TREATMENT)

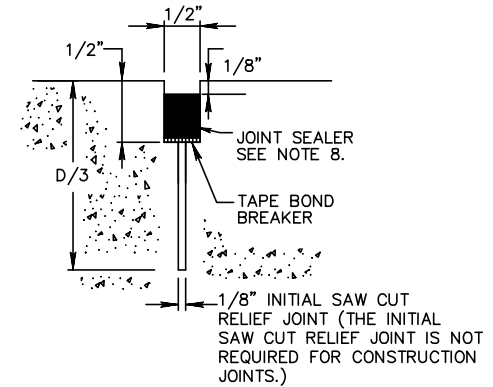

DETAIL C  
COLD-POURED JOINT SEALER  
WITHOUT BACKER ROD

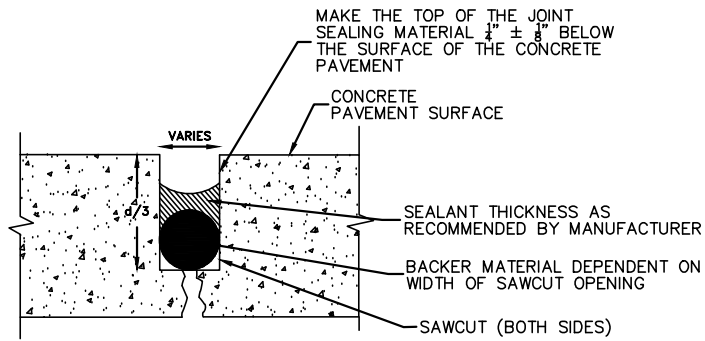

CRACK REPAIR DETAIL FOR CRACKS  
OVER 0.5 INCHES TO 2.0 INCHES IN WIDTH

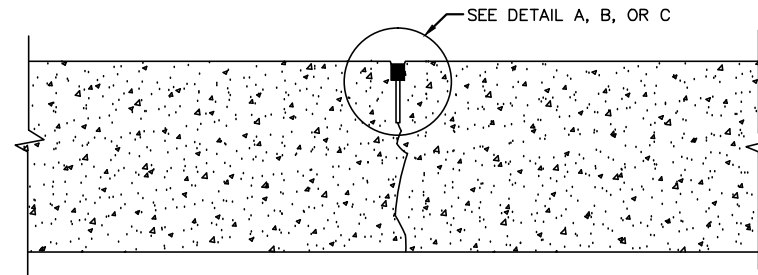

CRACK REPAIR DETAIL FOR CRACKS  
LESS THAN 0.5 INCHES WIDE

DETAIL 25 CONCRETE PAVEMENT REPAIR CONSTRUCTION DETAILS

N.T.S.

Plotted: 7/10/2015 3:07 PM File Name: \\cconew\linda\Engineering\County\_Standards\01-25-Concrete\_Pavement\_Repair\_Constr\_Details.dwg

No.	DATE	REVISIONS

**CAMDEN COUNTY**  
DEPARTMENT OF PUBLIC WORKS  
DIVISION OF PLANNING  
CHARLES J. DEPALMA PUBLIC WORKS COMPLEX  
2311 EGG HARBOR ROAD  
LINDENWOLD  
NEW JERSEY 08021

**CAMDEN COUNTY**  
DEPARTMENT OF PUBLIC WORKS  
SAM MARTELLO, DIRECTOR  
KEVIN BECICA, PE, PP, CME, CFM  
COUNTY ENGINEER  
2311 EGG HARBOR ROAD  
LINDENWOLD, NEW JERSEY 08021

TITLE  
COUNTY STANDARD  
CONCRETE PAVEMENT REPAIR  
CONSTRUCTION DETAILS

DATE  
JULY 2015  
DRAWN BY  
T.A.P/K.J.S.  
APPROVED BY  
K.B/A.L.

SHT. NO.  
3  
4

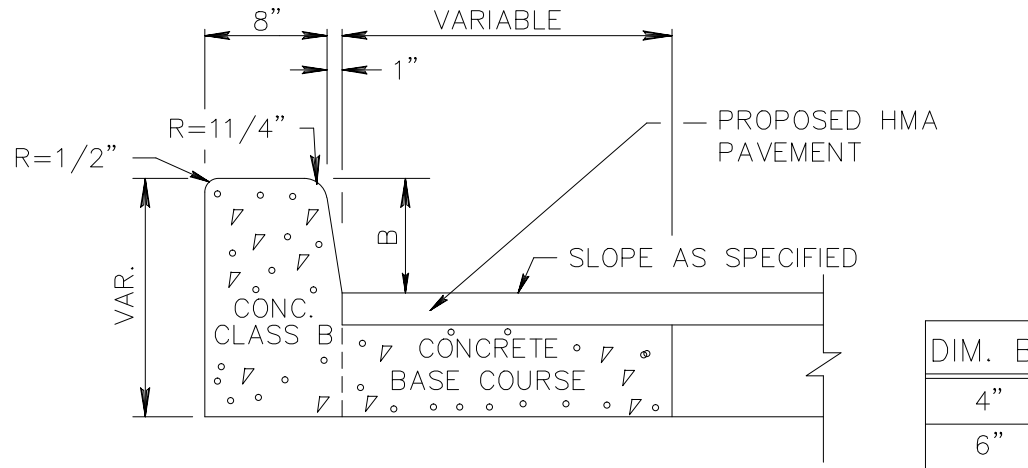

NOTES:  
 EXPANSION JOINTS 1/2 INCH WIDE IN THE CURB, AND EXPANSION JOINT ASSEMBLY IN THE MONOLITHIC PAVEMENT STRIP SHALL BE DIRECTLY OPPOSITE EVERY TRANSVERSE JOINT IN THE CENTRAL PAVEMENT STRIPS. JOINT MATERIAL IN THE CURB SHALL BE AS SPECIFIED FOR CONCRETE VERTICAL CURB. THE TRANSVERSE EXPANSION JOINT MATERIAL SHALL NOT EXTEND THRU THE CURB.

CONCRETE VERTICAL CURB  
 MONOLITHIC WITH CONCRETE BASE COURSE

DETAIL 26 CONCRETE PAVEMENT REPAIR CONSTRUCTION DETAILS

N.T.S.

Plotfile: 7/10/2015 3:09 PM File Name: \\c:\pwworking\linda\Engineering\County Standards\01-26-Concrete Pavement Repair Cont Details.dwg

No.	DATE	REVISIONS

**CAMDEN COUNTY**  
 DEPARTMENT OF PUBLIC WORKS  
 DIVISION OF PLANNING  
 CHARLES J. DEPALMA PUBLIC WORKS COMPLEX  
 2311 EGG HARBOR ROAD  
 LINDENWOLD  
 NEW JERSEY 08021

**CAMDEN COUNTY**  
 DEPARTMENT OF PUBLIC WORKS  
 SAM MARTELLO, DIRECTOR  
 KEVIN BECICA, PE, PP, CME, CFM  
 COUNTY ENGINEER  
 2311 EGG HARBOR ROAD  
 LINDENWOLD, NEW JERSEY 08021

TITLE  
 COUNTY STANDARD  
 CONCRETE PAVEMENT REPAIR  
 CONSTRUCTION DETAILS

DATE  
 JULY 2015  
 DRAWN BY  
 T.A.P./K.J.S.  
 APPROVED BY  
 K.B/A.L.

SHT. NO.  
4  
4