

CURB SIZE	DIM "A"	DIM "B"
9" x 18"	18"	4"
9" x 18"	18"	6"

- NOTES:**
1. EXPANSION JOINTS $\frac{1}{2}$ " WIDE IN THE CURB SHALL BE PROVIDED AT APPROXIMATELY EQUAL DISTANCES OF NOT MORE THAN 20' BETWEEN THE JOINTS.
 2. THE COST OF EXPANSION JOINTS IN THE CURB AND DENSE GRADED AGGREGATE BEDDING SHALL BE INCLUDED IN THE UNIT PRICE BID FOR THE CURB.
 3. CONCRETE SHALL BE CLASS B WITH 28 DAY COMPRESSIVE STRENGTH OF 4500 PSI, AND 6% \pm 1.5 AIR ENTRAINMENT.

DETAIL 1 STANDARD 8"X9"X18" CONCRETE
 N.T.S. VERTICAL CURB DETAIL

No.					
DATE					
	REVISIONS				
		CAMDEN COUNTY DEPARTMENT OF PUBLIC WORKS DIVISION OF PLANNING CHARLES J. DEPALMA PUBLIC WORKS COMPLEX 2311 EGG HARBOR ROAD NEW JERSEY 08021	CAMDEN COUNTY DEPARTMENT OF PUBLIC WORKS SAM MARTELLO, DIRECTOR KEVIN BECIGA, P.E., P.P., C.M.E., C.F.M. 2311 EGG HARBOR ROAD UNDERWOOD, NEW JERSEY 08021	TITLE	COUNTY STANDARD 8"X9"X18" CONCRETE VERTICAL CURB DETAIL
		DATE	MAR 2014	DRAWN BY	T.A.P
		APPROVED BY	K.B./A.L.	SHT. NO.	1

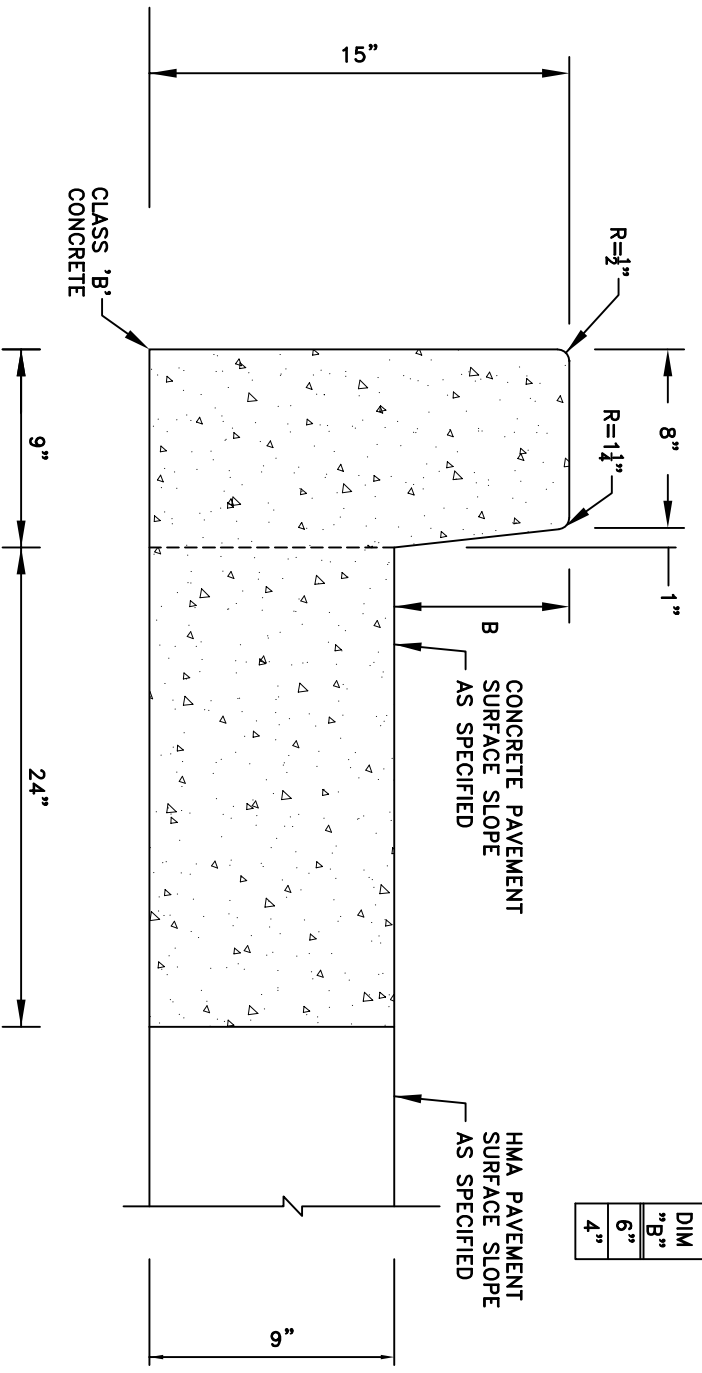

DIM	4"
"B"	6"
"B"	4"

NOTES:

1. TRANSVERSE JOINTS 1/2" WIDE SHALL BE INSTALLED IN THE CURB 20'-0" APART AND SHALL BE FILLED WITH PREFORMED BITUMINOUS IMPREGNATED FIBER JOINT FILLER, COMPLYING WITH THE REQUIREMENTS FOR TYPE III FILER IN A.A.S.H.T.O. SPECS M-153, RECESSED 1/4" IN FROM FRONT FACE AND TOP OF CURB.
2. JOINT MATERIAL IN THE CURB SHALL BE AS SPECIFIED FOR CONCRETE VERTICAL CURB. THE TRANSVERSE EXPANSION JOINT MATERIAL SHALL NOT EXTEND THRU THE CURB.
3. CONCRETE SHALL BE CLASS B WITH 28 DAY COMPRESSIVE STRENGTH OF 4500 PSI, AND 6% ±1.5 AIR ENTRAINMENT.

DETAIL 2 STANDARD MONOLITHIC CONCRETE CURB AND GUTTER DETAIL

N.T.S.

CAMDEN COUNTY		CAMDEN COUNTY		TITLE	
DEPARTMENT OF PUBLIC WORKS		DEPARTMENT OF PUBLIC WORKS		COUNTY STANDARD	
DIVISION OF PLANNING		SAL MARTELLO, DIRECTOR		MONOLITHIC CONCRETE	
CHARLES J. DEPALMA PUBLIC WORKS COMPLEX		KEVIN BECCA, P.E., P.P., C.M.E., C.F.M.		CURB AND GUTTER DETAIL	
2311 EGG HARBOR ROAD		2311 COUNTESS AVENUE			
NEW JERSEY 08021		UNDERWOOD, NEW JERSEY 08021			
No.	DATE	DATE	DRAWN BY	APPROVED BY	SH. NO.
		MAR 2014	T.A.P	K.B./A.L.	1
REVISIONS					

CURB SIZE	DIM. A	DIM. B	DIM. C	DIM. D
9" x 18"	18"	6"	16"	4"

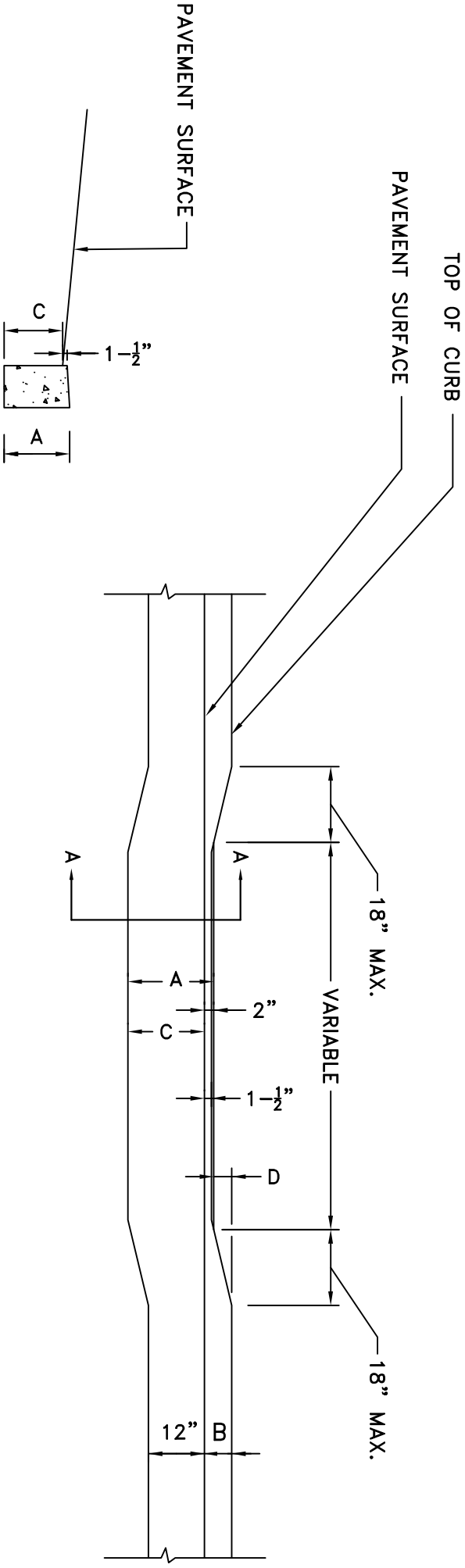

SECTION A-A

METHOD OF DEPRESSING CURB

NOTES:

1. CONCRETE SHALL BE CLASS B WITH 28 DAY COMPRESSIVE STRENGTH OF 4500 PSI, AND 6% ±1.5 AIR ENTRAINMENT.

DETAIL 3 STANDARD DEPRESSED CONCRETE CURB DETAIL

No.					
DATE		REVISIONS			
CAMDEN COUNTY		CAMDEN COUNTY		TITLE	
DEPARTMENT OF PUBLIC WORKS DIVISION OF PLANNING CHARLES J. DEPALMA PUBLIC WORKS COMPLEX 2311 EGG HARBOR ROAD NEW JERSEY 08021		DEPARTMENT OF PUBLIC WORKS SAM MARTELLO, DIRECTOR KEVIN BECICA, P.E., P.P., C.M.E., C.F.M. 2311 EGG HARBOR ROAD UNDERWOOD, NEW JERSEY 08021		COUNTY STANDARD DEPRESSED CONCRETE CURB DETAIL	
				DATE MAR 2014	
				DRAWN BY T.A.P.	
				APPROVED BY K.B./A.L.	
				SHT. NO. 1	

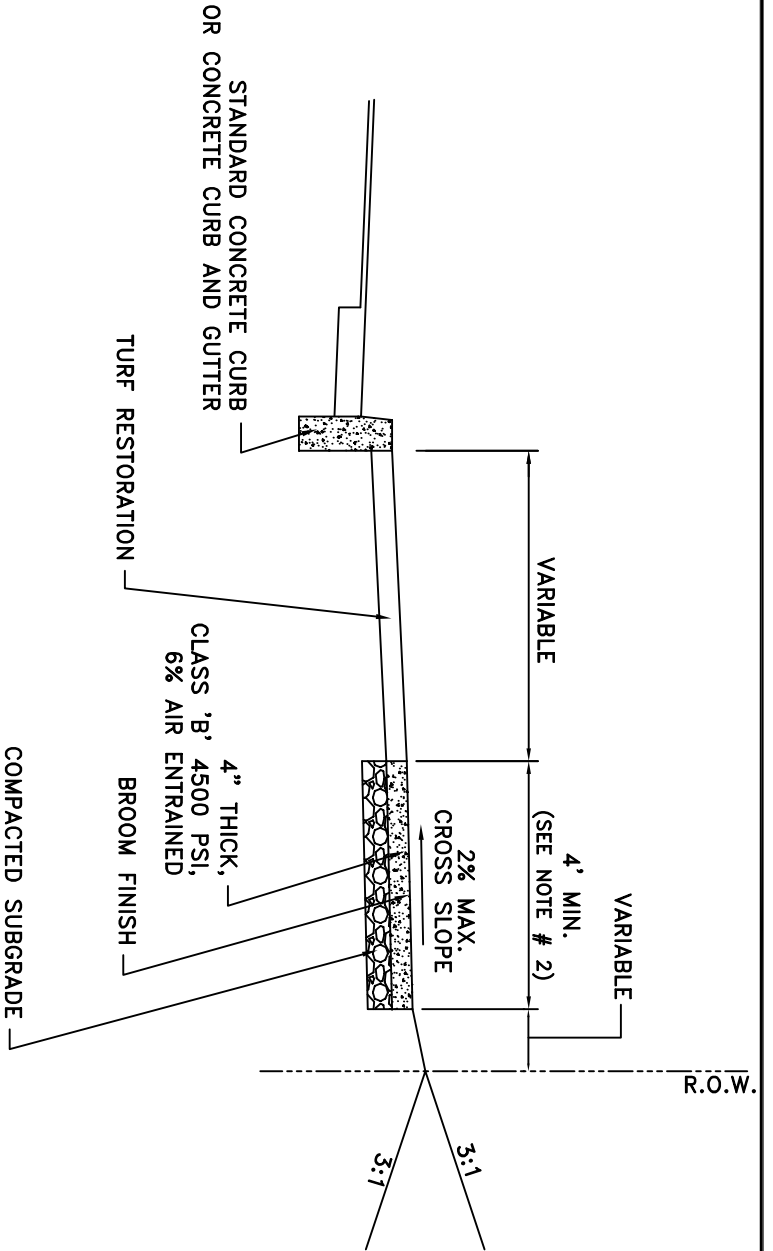

- NOTES:**
1. TURF RESTORATION TO CONSIST OF A MINIMUM OF 4" OF SELECT TOPSOIL, FERTILIZER AND SEED AS PER SPECIFICATIONS.
 2. IF SUBGRADE MATERIAL IS UNSUITABLE, CONTRACTOR TO REMOVE PER COUNTY ENGINEER'S DISCRETION AND REPLACE WITH SELECT FILL AT NO EXTRA COST TO THE COUNTY.
 3. SIDEWALK WIDTH SHALL BE 4'-0" MINIMUM UNLESS OTHERWISE NOTED ON THE APPROVED PLANS.
 4. CONCRETE SHALL BE CLASS B WITH 28 DAY COMPRESSIVE STRENGTH OF 4500 PSI AND 6% ±1.5% AIR ENTRAINMENT.

DETAIL 5 STANDARD CONCRETE SIDEWALK

N.T.S.

No.					
DATE					
	REVISIONS				
		CAMDEN COUNTY DEPARTMENT OF PUBLIC WORKS DIVISION OF PLANNING CHARLES J. DEPALMA PUBLIC WORKS COMPLEX 2311 EGG HARBOR ROAD NEW JERSEY 08021	CAMDEN COUNTY DEPARTMENT OF PUBLIC WORKS SAM MARTELLO, DIRECTOR KEVIN BECIGA, P.E., P.E., C.M.E., C.F.M. COUNTY ENGINEER AND 2311 EGG HARBOR ROAD UNDEWOOD, NEW JERSEY 08021	TITLE COUNTY STANDARD CONCRETE SIDEWALK DETAIL	DATE MAR 2014 DRAWN BY T.A.P. APPROVED BY K.B./A.L.
					SHF. NO. 1

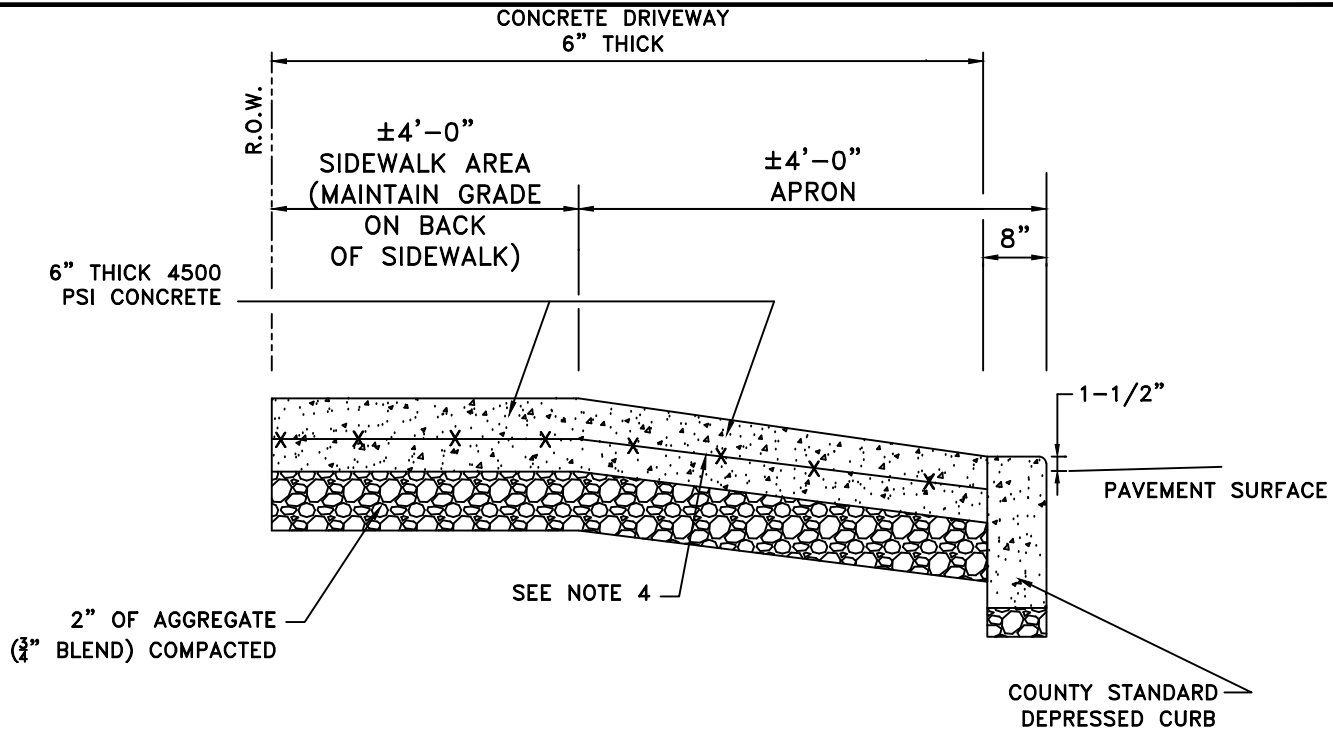

NOTES:

1. CONCRETE COMPRESSIVE STRENGTH SHALL BE A MINIMUM OF 4500 PSI AFTER 28 DAYS AT 6% ±1.5% AIR ENTRAINMENT.
2. CURB JOINT SHALL BE TROWELED WITH A MIN 1/2" RADIUS ALONG BACK OF CURB.
3. EXPANSION AND CONTRACTION JOINTS SHALL BE 1/2" PREMOLDED ASPHALT IMPREGNATED MATERIAL OR EQUAL EXTENDING FROM SUBGRADE TO FINISH GRADE.
4. PROVIDE 6" X 6" W1.4/W1.4 GALVANIZED MESH AT COMMERCIAL DRIVEWAYS ONLY. PROVIDE 6" X 6" W1.4/W1.4 NON GALVANIZED WELDED WIRE MESH AT RESIDENTIAL DRIVEWAYS.

DETAIL 6 STANDARD CONCRETE DRIVEWAY
AND CONCRETE APRON

N.T.S.

Project: 3/6/2015, 1:58 PM - File Name: CA Engineering\County_Standards\DT-6-Conc-Driveway-8.3X11.dwg

			CAMDEN COUNTY DEPARTMENT OF PUBLIC WORKS DIVISION OF PLANNING CHARLES J. DEPALMA PUBLIC WORKS COMPLEX 2311 EGG HARBOR ROAD LINDENWOLD NEW JERSEY 08021	CAMDEN COUNTY DEPARTMENT OF PUBLIC WORKS SAM MARTELLO, DIRECTOR KEVIN BECICA, PE, PP, CME, CFM COUNTY ENGINEER 2311 EGG HARBOR ROAD LINDENWOLD, NEW JERSEY 08021	TITLE COUNTY STANDARD CONCRETE DRIVEWAY DETAIL	DATE MAR 2014 DRAWN BY T.A.P. APPROVED BY K.B/A.L.	SHI. NO. <div style="border: 1px solid black; border-radius: 50%; width: 30px; height: 30px; display: flex; align-items: center; justify-content: center; margin: 0 auto;"> 1 </div> <div style="border: 1px solid black; border-radius: 50%; width: 30px; height: 30px; display: flex; align-items: center; justify-content: center; margin: 0 auto;"> 1 </div>
1	03/06/2015	REINFORCEMENT SIZE REQUIREMENTS					
No.	DATE	REVISIONS					

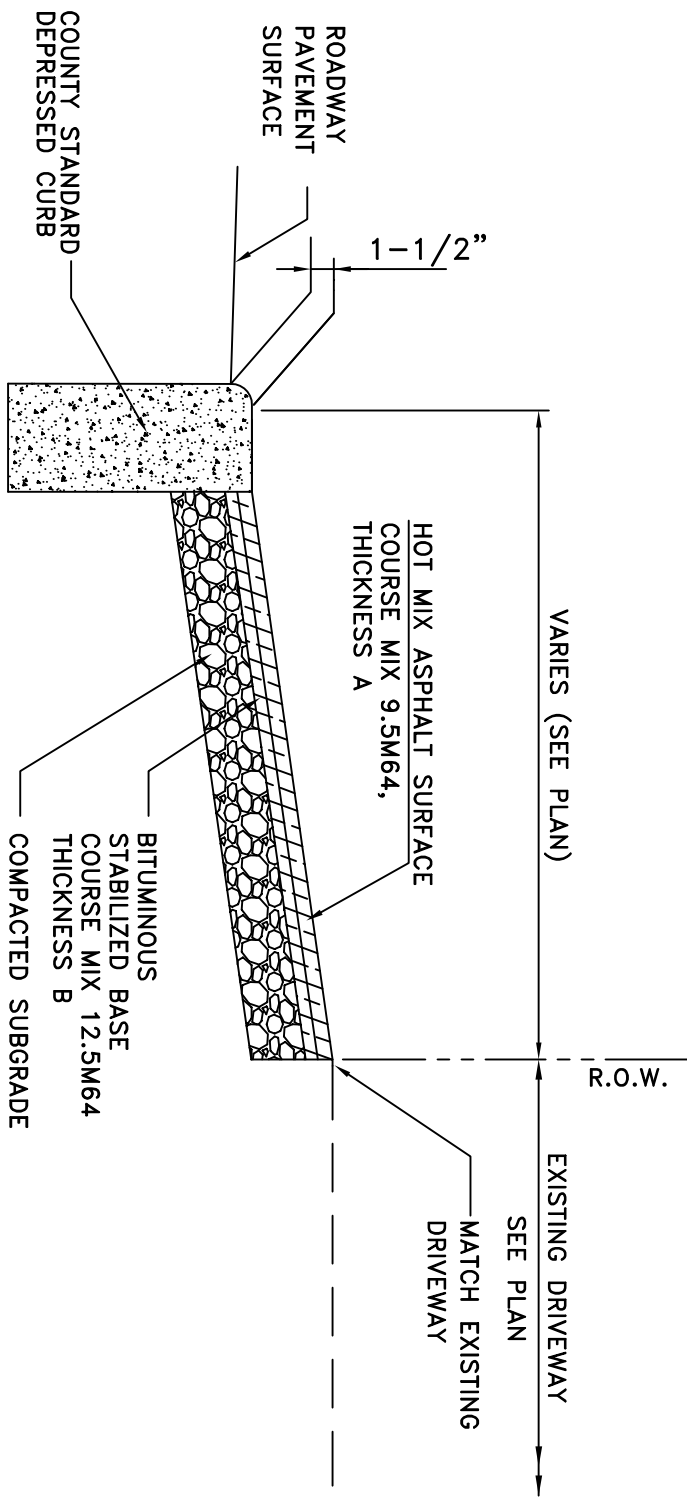

	BIT. CONCRETE	INCHES	INCHES
TOP PAVE A	1 1/2	2	
BASE PAVE B	2 1/2	2	
TOTAL THICKNESS	4	4	

NOTES:

1. THE DRIVEWAY IN THE COUNTY RIGHT-OF-WAY SHALL BE COMPOSED OF TOP COURSE AND BASE COURSE WITH A TOTAL THICKNESS OF 4 INCHES (SEE TABLE).
2. CURB JOINT SHALL BE TROWELED WITH A MIN 1/2" RADIUS ALONG BACK OF CURB. COUNTY RIGHT-OF-WAY.
3. A DRIVEWAY APRON MAY NOT IMPEDE THE FLOW OF STORMWATER.
4. A ROAD OPENING PERMIT IS REQUIRED BEFORE START OF CONSTRUCTION IN THE COUNTY RIGHT-OF-WAY.

DETAIL 7 STANDARD BITUMINOUS DRIVEWAY APRON TYPE 1

N.T.S.

	CAMDEN COUNTY DEPARTMENT OF PUBLIC WORKS DIVISION OF PLANNING CHARLES J. DEPALMA PUBLIC WORKS COMPLEX 2311 EGG HARBOR ROAD NEW JERSEY 08021	CAMDEN COUNTY DEPARTMENT OF PUBLIC WORKS SAM MARTELLO, DIRECTOR KEVIN BECKA, P.E., P.P., C.M.E., C.F.M. 2311 TUNN HANCOCK ROAD LINDENWOLD, NEW JERSEY 08021	TITLE COUNTY STANDARD BITUMINOUS DRIVEWAY APRON DETAIL	DATE MARCH 2014 DRAWN BY T.A.P. APPROVED BY K.B./A.L.	SH. NO. 1
--	---	---	---	--	--

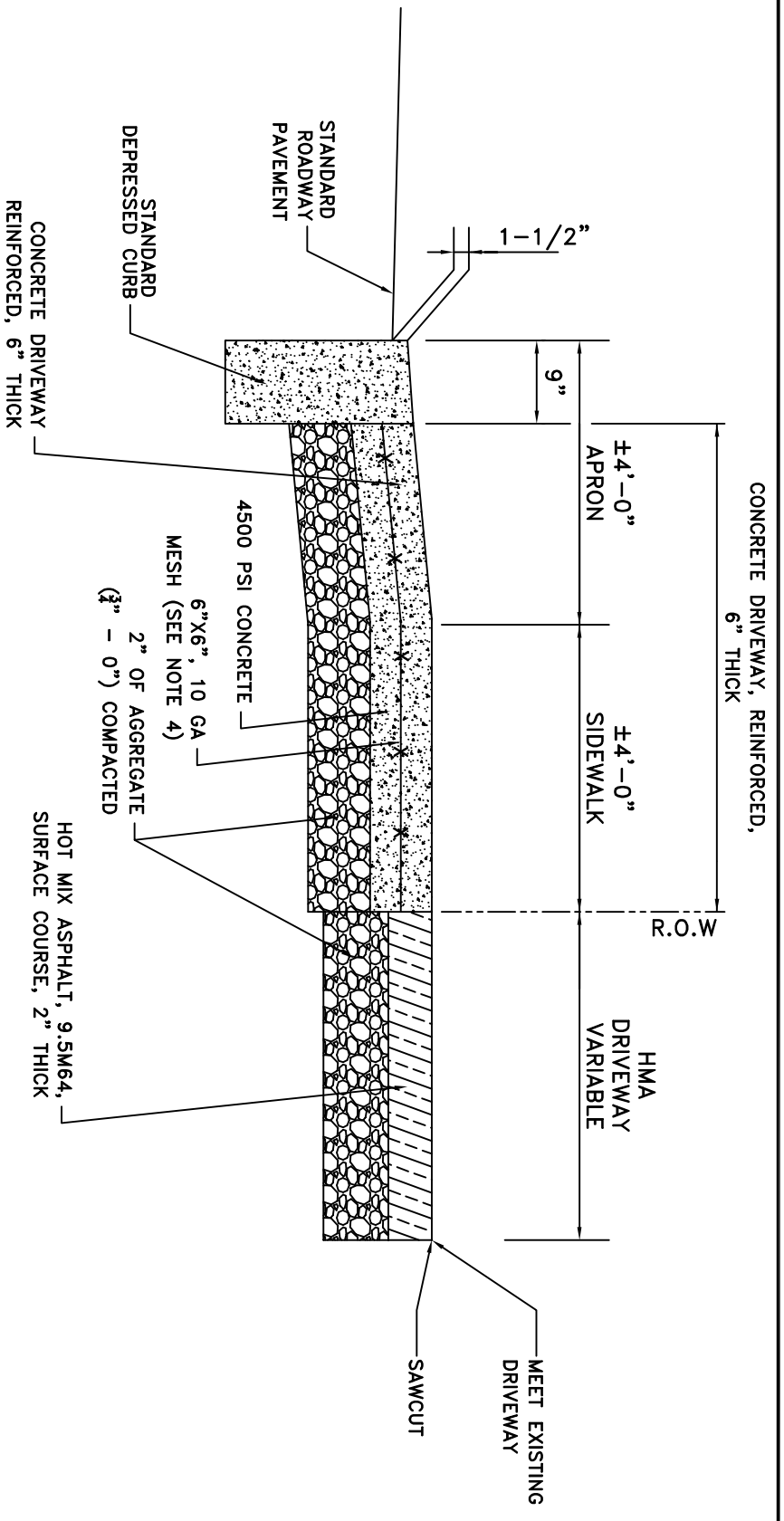

CONCRETE DRIVEWAY REINFORCED, 6" THICK

HOT MIX ASPHALT, 9.5M64, SURFACE COURSE, 2" THICK

NOTES:

1. CONCRETE SHALL BE CLASS B WITH 28 DAY COMPRESSIVE STRENGTH OF 4500 PSI, 6% ±1.5% AIR ENTRAINMENT.
2. CURB JOINT SHALL BE TROWELED WITH A MIN 1/2" RADIUS ALONG BACK OF CURB.
3. EXPANSION AND CONTRACTION JOINTS SHALL BE 1/2" PREMOLED ASPHALT IMPREGNATED MATERIAL OR EQUAL EXTENDING FROM SUBGRADE TO FINISH GRADE.
4. 6" X 6" 10 GA MESH REQUIRED FOR COMMERCIAL DRIVEWAYS ONLY, 6" X 6" WELDED WIRE MESH REQUIRED FOR RESIDENTIAL DRIVEWAYS.

DETAIL 8 STANDARD HOT MIX ASPHALT DRIVEWAY SECTION

N.T.S.

ADJACENT TO REINFORCED CONCRETE SIDEWALK AND APRON

No.					
DATE					
REVISIONS					
	CAMDEN COUNTY	CAMDEN COUNTY	TITLE	DATE	SHT. NO.
	DEPARTMENT OF PUBLIC WORKS DIVISION OF PLANNING CHARLES J. DEPALMA PUBLIC WORKS COMPLEX 2311 EGG HARBOR ROAD NEW JERSEY 08021	DEPARTMENT OF PUBLIC WORKS SAM MARTELLO, DIRECTOR KEVIN BECINA, P.E., P.E. C.M.E., C.F.M. 2311 SOUTH HANCOCK AVENUE LINDENWOLD, NEW JERSEY 08021	COUNTY STANDARD HOT MIX ASPHALT DRIVEWAY ADJACENT TO REINFORCED CONCRETE SIDEWALK AND APRON	MAR 2014 DRAWN BY T.A.P. APPROVED BY K.B./A.L.	1 1

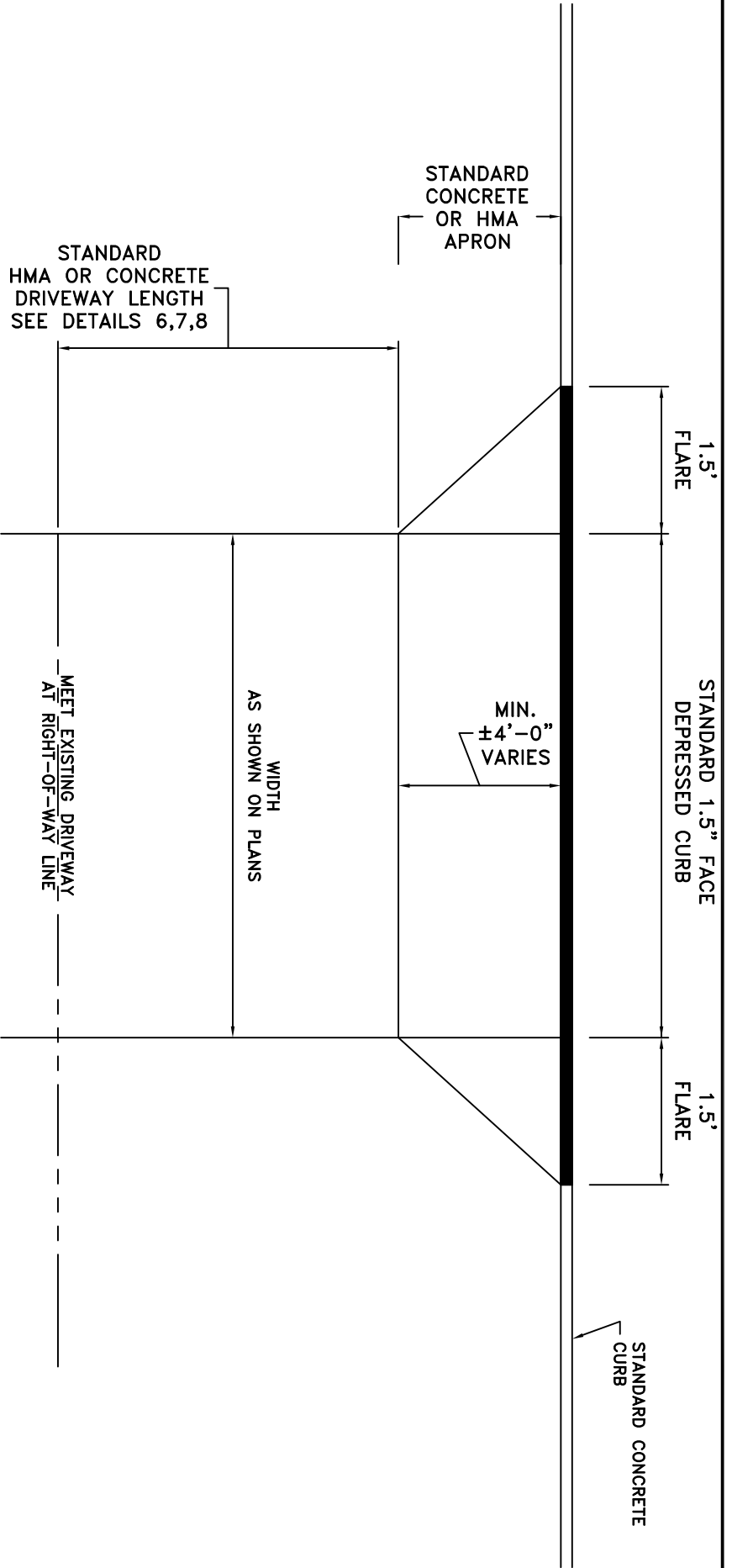

- NOTES:**
1. LENGTH AND WIDTH OF DRIVEWAY SHALL BE SHOWN ON THE PLANS OR AS DIRECTED.
 2. DEPRESSED CURB SHALL BE CONSTRUCTED AS PER COUNTY DEPRESSED CURB DETAIL.
 3. A DRIVEWAY APRON MAY NOT IMPEDE THE FLOW OF STORMWATER.

DETAIL 9 STANDARD DRIVEWAY TREATMENT
 APRON AND FLARE
 (PLAN VIEW)
 N.T.S.

No.	DATE	REVISIONS	CAMDEN COUNTY		TITLE	DATE	SHT. NO.
			DEPARTMENT OF PUBLIC WORKS DIVISION OF PLANNING CHARLES J. DEPALMA PUBLIC WORKS COMPLEX 2311 BOG HANCOCK ROAD NEW JERSEY 08021	DEPARTMENT OF PUBLIC WORKS SAM MARTELLO, DIRECTOR KEVIN BECIGA, P.E., C.M.E., C.F.M. 2311 SUNNYSIDE AVENUE LINCOLNWOOD, NEW JERSEY 08021			

PAVEMENT MARKING LEGEND

UNLESS OTHERWISE SHOWN, PAVEMENT MARKINGS SHALL CONFORM TO THE FOLLOWING:

- STOP LINE (24" SWL) -24" WIDE WHITE LINE
 - CENTER LINE (4" CL) -2-4" WIDE YELLOW LINES
 - TWO WAY LEFT TURN LANE LINES (4" SYL) (4" DYL) -4" WIDE YELLOW LINE
 - DASHED LANE LINE (4" DWL) -4" WIDE YELLOW LINE, 10' LONG AT 30' INTERVALS
 - LANE EXTENSION GUIDE LINES -4" WIDE WHITE LINE, 10' LONG AT 30' INTERVALS
 - SOLID LANE LINE-EXCLUSIVE MOVEMENT (8" SWL) -4" WIDE WHITE LINE, 10' LONG AT 30' INTERVALS
 - SOLID LANE LINE- ALL OTHERS (4" SWL) -4" WIDE WHITE LINE, 2' LONG AT 4' INTERVALS
 - CROSSWALK LINES (6" SWL) -8" WIDE WHITE LINE
 - MEDIAN CROSS HATCH LINES (24" CHL) -4" WIDE WHITE LINE
 - GORE CROSS HATCH LINES (24" CHL) -8" WIDE WHITE LINE
 - ISLAND CHANNELIZATION LINE AT 45° SPACED 12' O.C.
 - RIGHT SHOULDER LINE AT 45° SPACED 12' O.C.
 - LEFT SHOULDER LINE AT 45° SPACED 12' O.C.
- 1) ALL TRAFFIC CONTROL DEVICES SHALL CONFORM TO THE 2009 EDITION MANUAL ON UNIFORM TRAFFIC CONTROL DEVICES
 - 2) NEAREST CROSSWALK LINE IS TO BE LOCATED A MINIMUM OF 4' FROM THE STOP LINE.
 - 3) W = WHITE STRIPE
Y = YELLOW STRIPE
 - 4) ALL DIMENSIONS SHOWN ARE FROM THE CENTER OF ALL PAVEMENT MARKING LINES.

DETAIL 10 STANDARD PAVEMENT MARKING LEGEND

N.T.S.

No.	DATE	REVISIONS	CAMDEN COUNTY DEPARTMENT OF PUBLIC WORKS DIVISION OF PLANNING CHARLES J. DEPALMA PUBLIC WORKS COMPLEX 2311 BOG HANCOCK ROAD NEW JERSEY 08021	CAMDEN COUNTY DEPARTMENT OF PUBLIC WORKS SAM MARTELLO, DIRECTOR KEVIN BECICA, P.E., P.E., C.M.E., C.F.M. 2311 BOG HANCOCK ROAD UNDERWOOD, NEW JERSEY 08021	TITLE COUNTY STANDARD PAVEMENT MARKING LEGEND	DATE MAR 2014 DRAWN BY T.A.P. APPROVED BY K.B./A.L.	SHT. NO. 1
-----	------	-----------	---	---	--	--	---------------

OPPOSITE
EDGE OF PAVEMENT

1/2 R3-2

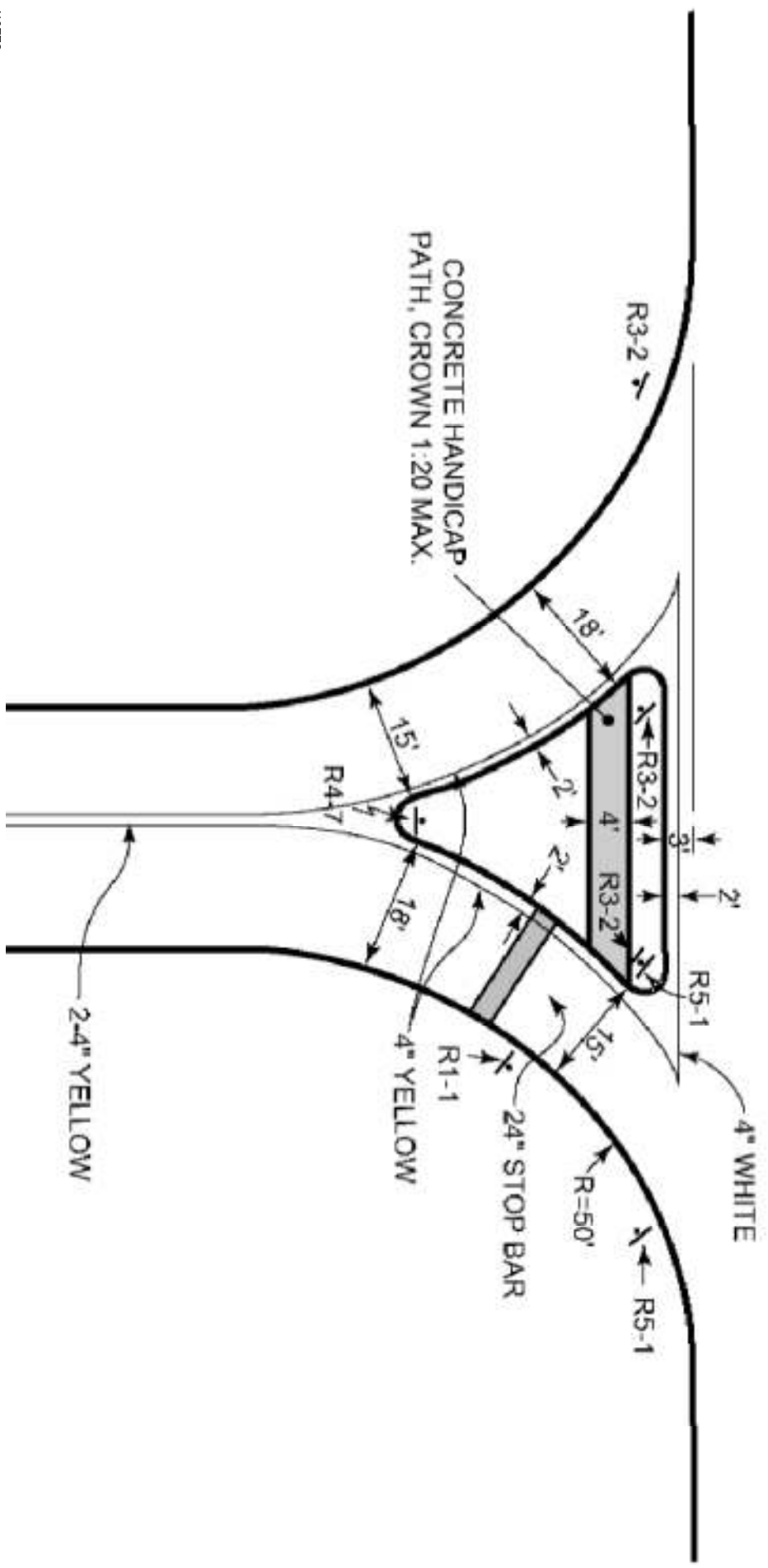

- NOTES:
1. THE RADIUS SHOWN AT ALL CURB RETURNS ARE FOR REFERENCE PURPOSE ONLY. THE ARCHITECT/ENGINEER TO ADJUST THE RADIUS PER SITE CONDITIONS AND STANDARD DESIGN VEHICLE.
 2. THE SIGN DESIGNATIONS SHOWN ON THE DETAIL ARE STANDARD SIGNS PER MUTCD. REFER MUTCD SECTION 2 FOR STANDARD SIGN AND PLAQUE SIZES AND FURTHER DETAILS.
 3. THE LANE WIDTHS SHOWN ON THE DETAIL IS FOR REFERENCE PURPOSE ONLY. THE ARCHITECT/ENGINEER TO ADJUST LANE WIDTHS PER SITE CONDITIONS AND STANDARD DESIGN VEHICLE.

DETAIL 12 STANDARD LEFT TURN IN AND
LEFT TURN OUT PROHIBITED DETAIL

N.T.S.

No.	DATE	REVISIONS	CAMDEN COUNTY		TITLE	DATE	SHT. NO.
			DEPARTMENT OF PUBLIC WORKS DIVISION OF PLANNING CHARLES J. DEPALMA PUBLIC WORKS COMPLEX 2311 EGG HARBOR ROAD NEW JERSEY 08021	DEPARTMENT OF PUBLIC WORKS SAM MARTELLO, DIRECTOR KEVIN BEGICA, P.E., P.E. CMC, CFM 2311 EGG HARBOR ROAD UNDERWOOD, NEW JERSEY 08021			

No.	
DATE	
REVISIONS	

CAMDEN COUNTY
 DEPARTMENT OF PUBLIC WORKS
 DIVISION OF PLANNING
 CHARLES J. DEPALMA PUBLIC WORKS COMPLEX
 2311 EGG HARBOR ROAD
 NEW JERSEY 08021

CAMDEN COUNTY
 DEPARTMENT OF PUBLIC WORKS
 SAM MARTELLO, DIRECTOR
 KEVIN BECIGA, P.E., P.P., C.M.E., C.F.M.
 2311 EGG HARBOR ROAD
 LINCOLNWOOD, NEW JERSEY 08021

TITLE
 COUNTY STANDARD
 CURB INLET WITH BICYCLE SAFE GRATE
 AND TYPE 'N-ECO' CURB PIECE

DATE
 MAR 2014
 DRAWN BY
 T.A.P.
 APPROVED BY
 K.B./A.L.

SHT. NO.
 1

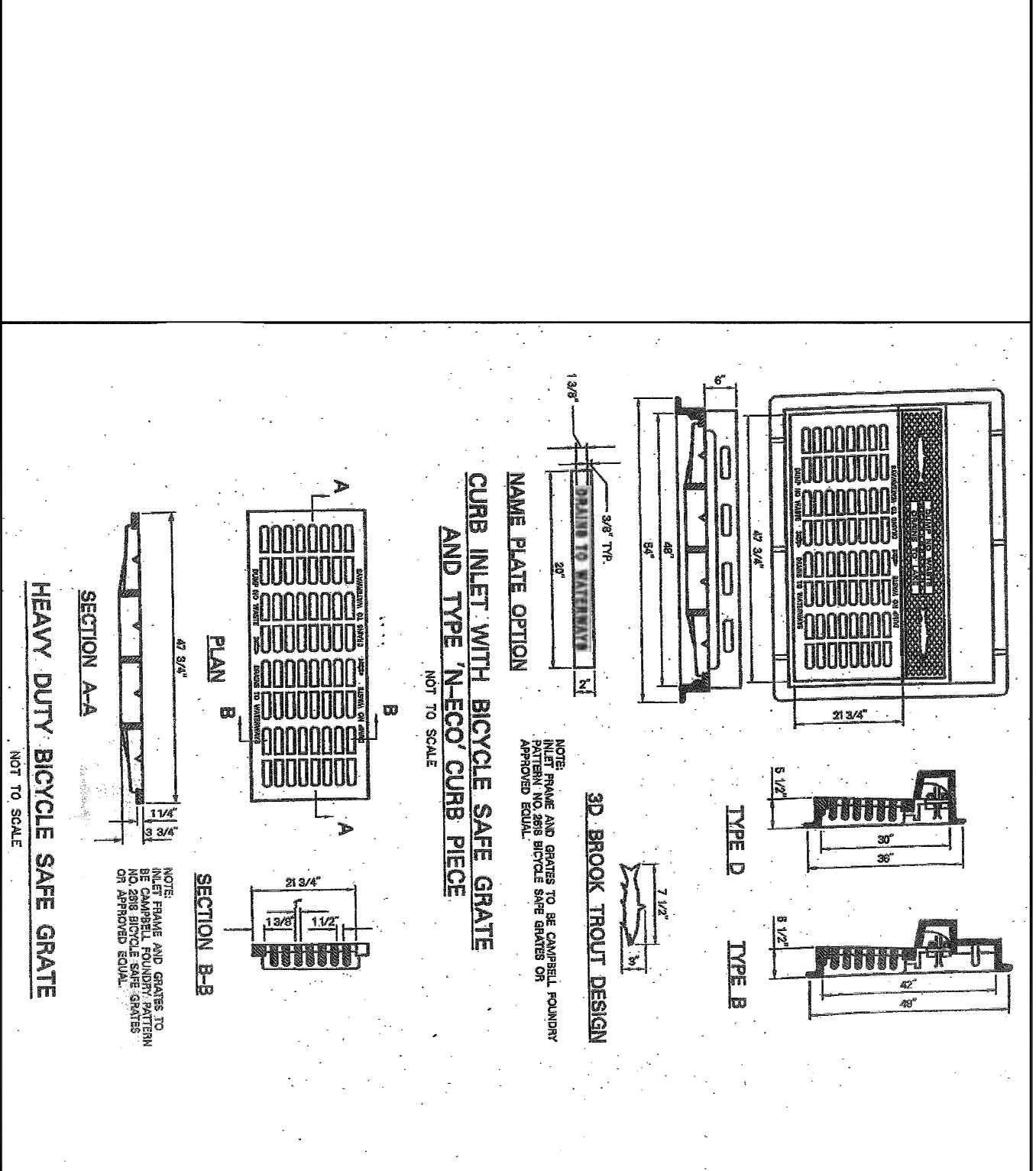

HEAVY DUTY BICYCLE SAFE GRATE

CURB INLET WITH BICYCLE SAFE GRATE AND TYPE 'N-ECO' CURB PIECE

DETAIL 15 CURB INLET WITH BICYCLE SAFE GRATE AND TYPE 'N-ECO' CURB PIECE
 N.T.S.

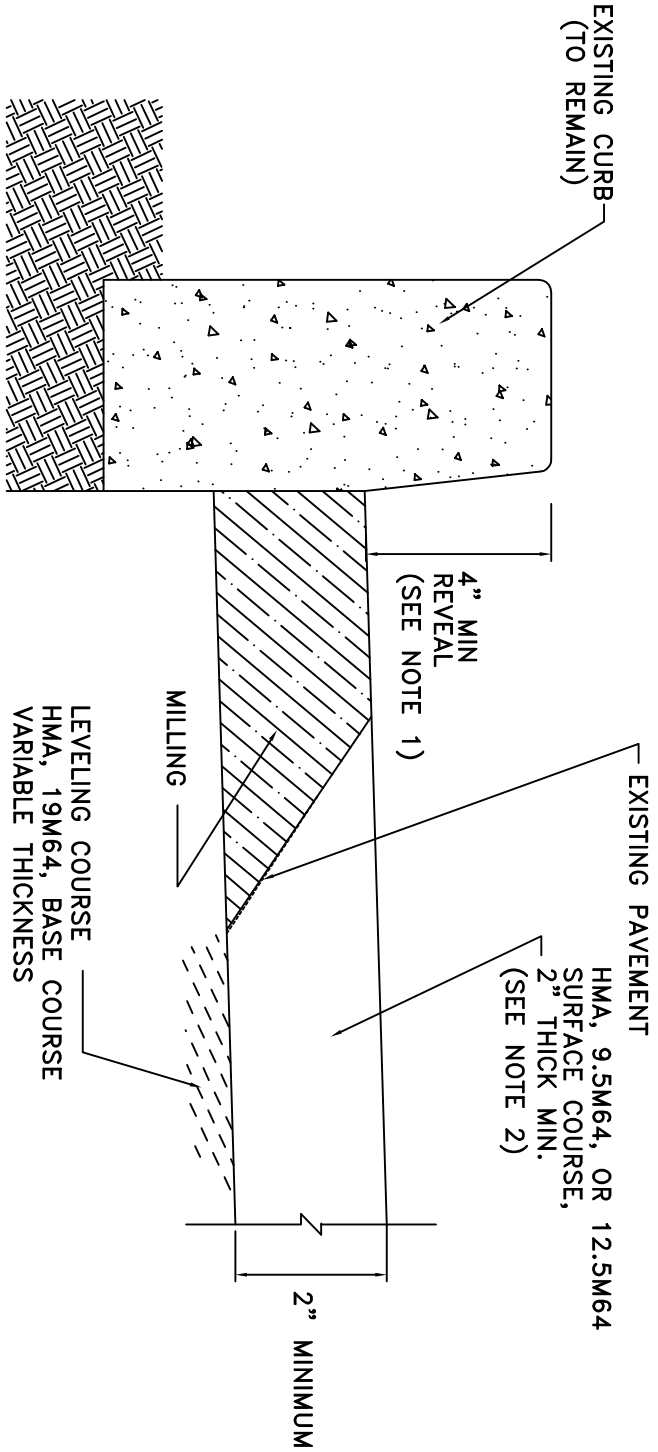

- NOTES:**
1. PROVIDE $\frac{1}{2}$ " MINIMUM REVEAL AT DEPRESSED CURBS DURING MILL & RESURFACING.
 2. SURFACE COURSE MAY BE 9.5M64 FOR COUNTY ROADS WITH LESS THAN 5,000 AADT, SURFACE COURSE MUST BE 12.5M64 FOR COUNTY ROADS WITH EQUAL OR GREATER THAN 5000 AADT.

DETAIL 16 MILLING AND RESURFACING

N.T.S.

No.					
DATE					
	REVISIONS				
		CAMDEN COUNTY DEPARTMENT OF PUBLIC WORKS DIVISION OF PLANNING CHARLES J. DEPALMA PUBLIC WORKS COMPLEX 2311 EGG HARBOR ROAD NEW JERSEY 08021	CAMDEN COUNTY DEPARTMENT OF PUBLIC WORKS SAM MARTELLO, DIRECTOR KEVIN BECICA, P.E., P.E., C.M.E., C.F.M. 2311 EGG HARBOR ROAD LINCOLNWOOD, NEW JERSEY 08021	TITLE COUNTY STANDARD MILLING AND RESURFACING DETAIL	DATE MAR 2014 DRAWN BY T.A.P. APPROVED BY K.B./A.L.
					SH. NO. 1

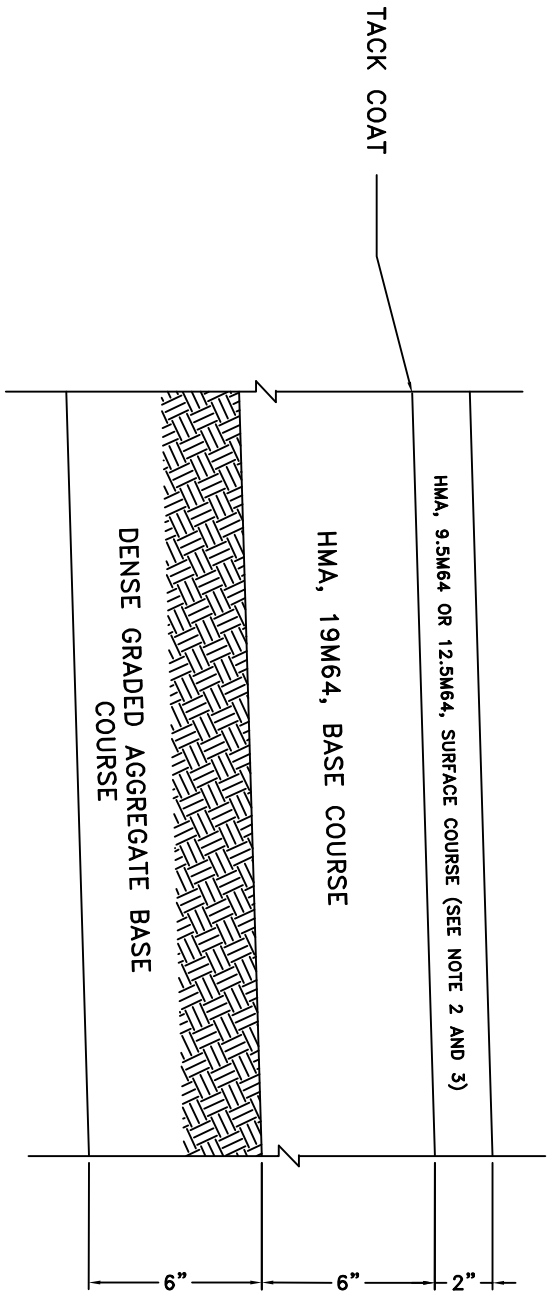

NOTE:

1. MIX NUMBERS ARE IN ACCORDANCE WITH NEW JERSEY DEPARTMENT OF TRANSPORTATION, STANDARD SPECIFICATIONS FOR ROAD AND BRIDGE CONSTRUCTION
2. SURFACE COURSE MAY BE 9.5M64 ON COUNTY ROADS WITH AADT LESS THAN 5,000.
3. SURFACE COURSE MUST BE 12.5M64 ON COUNTY ROADS WITH AADT EQUAL OR GREATER THAN 5,000.

DETAIL 17 HOT MIX ASPHALT PAVEMENT

N.T.S.

No.					
DATE					
	REVISIONS				
		CAMDEN COUNTY DEPARTMENT OF PUBLIC WORKS DIVISION OF PLANNING CHARLES J. DEPALMA PUBLIC WORKS COMPLEX 2311 EGG HARBOR ROAD NEW JERSEY 08021	CAMDEN COUNTY DEPARTMENT OF PUBLIC WORKS SAM MARTELLO, DIRECTOR KEVIN BECICA, P.E., P.E., C.M.E., C.F.M. 2311 EGG HARBOR ROAD UNDERWOOD, NEW JERSEY 08021	TITLE	COUNTY STANDARD HOT MIX ASPHALT PAVEMENT DETAIL
				DATE	MAR 2014 DRAWN BY T.A.P. APPROVED BY K.B./A.L.
				SHT. NO.	1 1

Plotted: 1/31/2017 11:55 AM File Name: \\C:\DPW\HMA\Engineering\County_Standards\DTL-18A-Roadway Widening-8.5X11.dwg

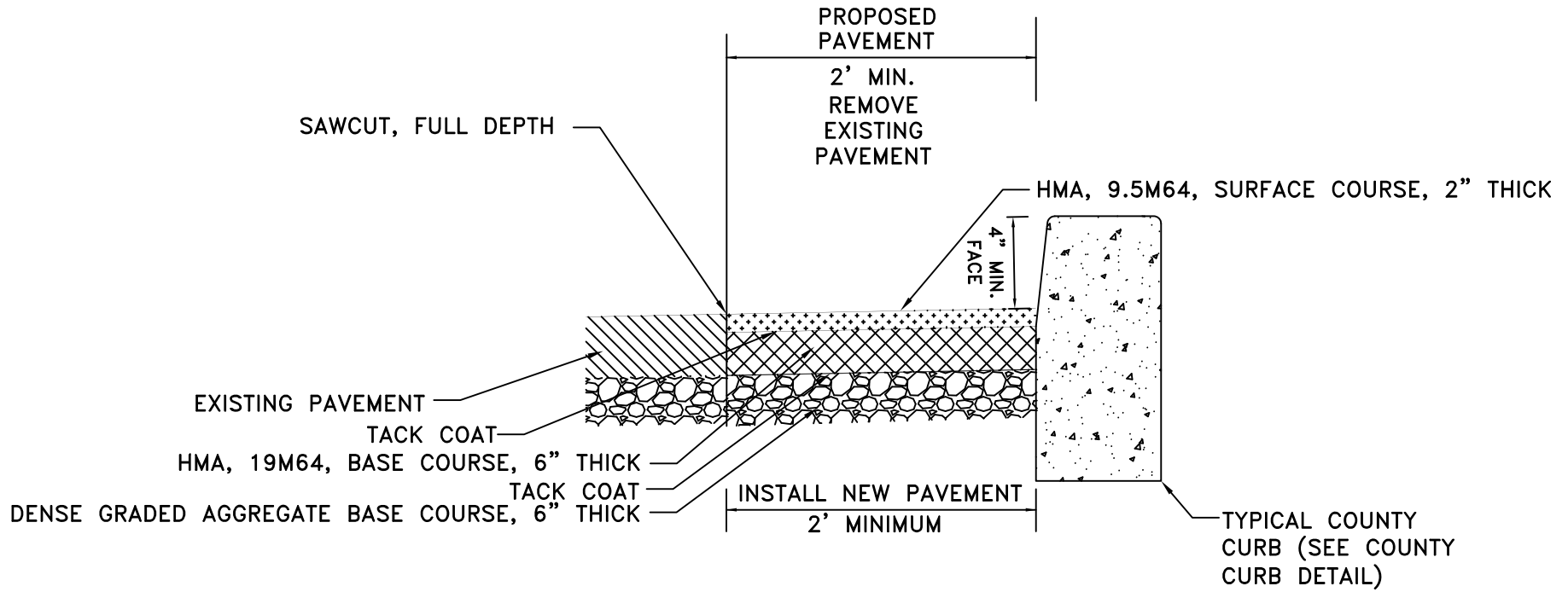

DETAIL 18A TYPICAL ROADWAY RESTORATION FOR CURB INSTALLATION

N.T.S.

NOTES:

1. SEE CONSTRUCTION PLANS FOR LOCATIONS WHERE PAVEMENT RESTORATION ADJACENT TO CURB IS GREATER THAN 2' MINIMUM

			CAMDEN COUNTY DEPARTMENT OF PUBLIC WORKS DIVISION OF PLANNING CHARLES J. DEPALMA PUBLIC WORKS COMPLEX 2311 EGG HARBOR ROAD LINDENWOLD NEW JERSEY 08021	CAMDEN COUNTY DEPARTMENT OF PUBLIC WORKS SAM MARTELLO, DIRECTOR KEVIN BECICA, PE, PP, CME, CFM COUNTY ENGINEER 2311 EGG HARBOR ROAD LINDENWOLD, NEW JERSEY 08021	TITLE COUNTY STANDARD ROADWAY WIDENING SECTIONS	DATE JAN 2017 DRAWN BY T.A.P. APPROVED BY K.B./A.L.	SHT. NO. <div style="border: 1px solid black; border-radius: 50%; width: 30px; height: 30px; display: flex; align-items: center; justify-content: center; margin: 0 auto;"> 1 </div> <div style="border: 1px solid black; border-radius: 50%; width: 30px; height: 30px; display: flex; align-items: center; justify-content: center; margin: 0 auto;"> 1 </div>
No.	DATE	REVISIONS					

Plotted: 1/31/2017 11:55 AM File Name: \\C:\D:\P\W\HMA\A\Engineering\County_Standards\DTL-18B-Roadway_Widening-8.5X11.dwg

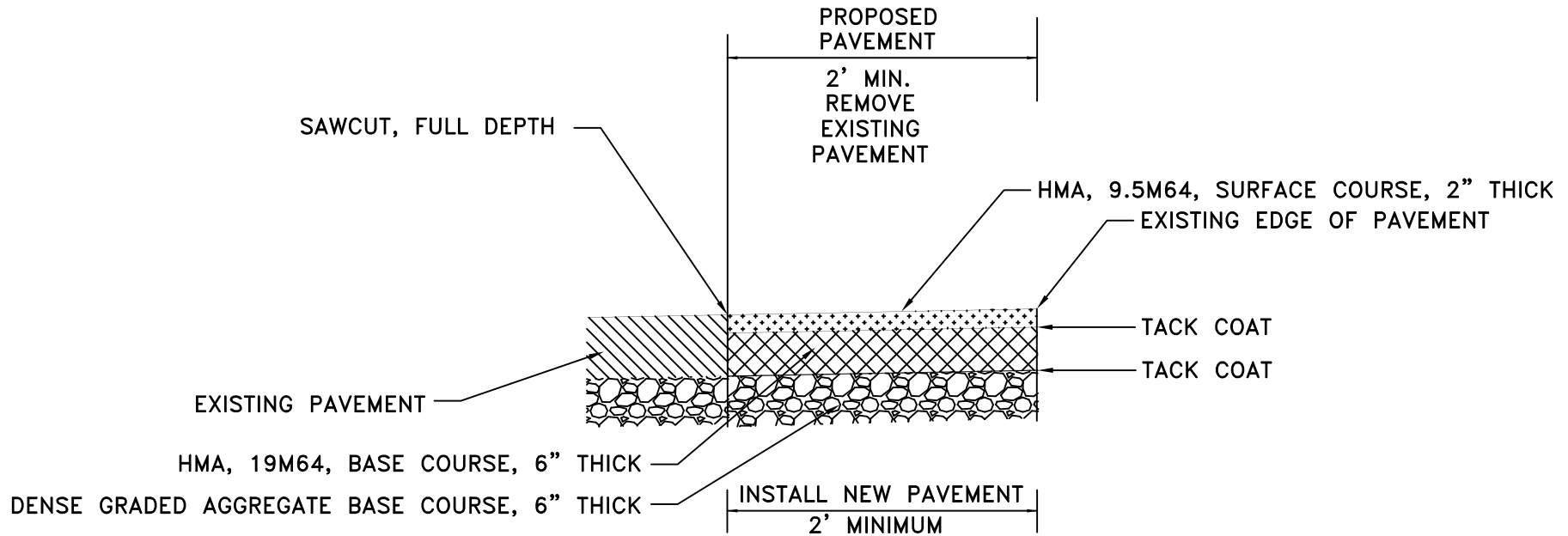

DETAIL 18B TYPICAL ROADWAY WIDENING WHERE NO CURB IS PRESENT

N.T.S.

18B

NOTES:

1. SEE CONSTRUCTION PLANS FOR LOCATIONS WHERE PAVEMENT RESTORATION ADJACENT TO EXISTING EDGE OF PAVEMENT IS GREATER THAN 2' MINIMUM

		CAMDEN COUNTY DEPARTMENT OF PUBLIC WORKS DIVISION OF PLANNING CHARLES J. DEPALMA PUBLIC WORKS COMPLEX 2311 EGG HARBOR ROAD LINDENWOLD NEW JERSEY 08021		CAMDEN COUNTY DEPARTMENT OF PUBLIC WORKS SAM MARTELLO, DIRECTOR KEVIN BECICA, PE, PP, CME, CFM COUNTY ENGINEER 2311 EGG HARBOR ROAD LINDENWOLD, NEW JERSEY 08021		TITLE COUNTY STANDARD ROADWAY WIDENING SECTIONS		DATE JAN 2017 DRAWN BY T.A.P. APPROVED BY K.B./A.L.		SHT. NO. 1 1	
No.	DATE	REVISIONS									

NOTES:
 BACKFILLING WITH EXCAVATED MATERIAL SHALL NOT BE PERMITTED IN TRENCHES FOR STORM SEWER & ALL OTHER UTILITIES.
 10' MAX. OR TO THE NEAREST JOINT

DETAIL 19B RCP-STORM SEWER INSTALLATION.
 N.T.S. & TRENCH RESTORATION DETAIL
 IN CONCRETE PAVEMENT
 WITH HMA PAVEMENT

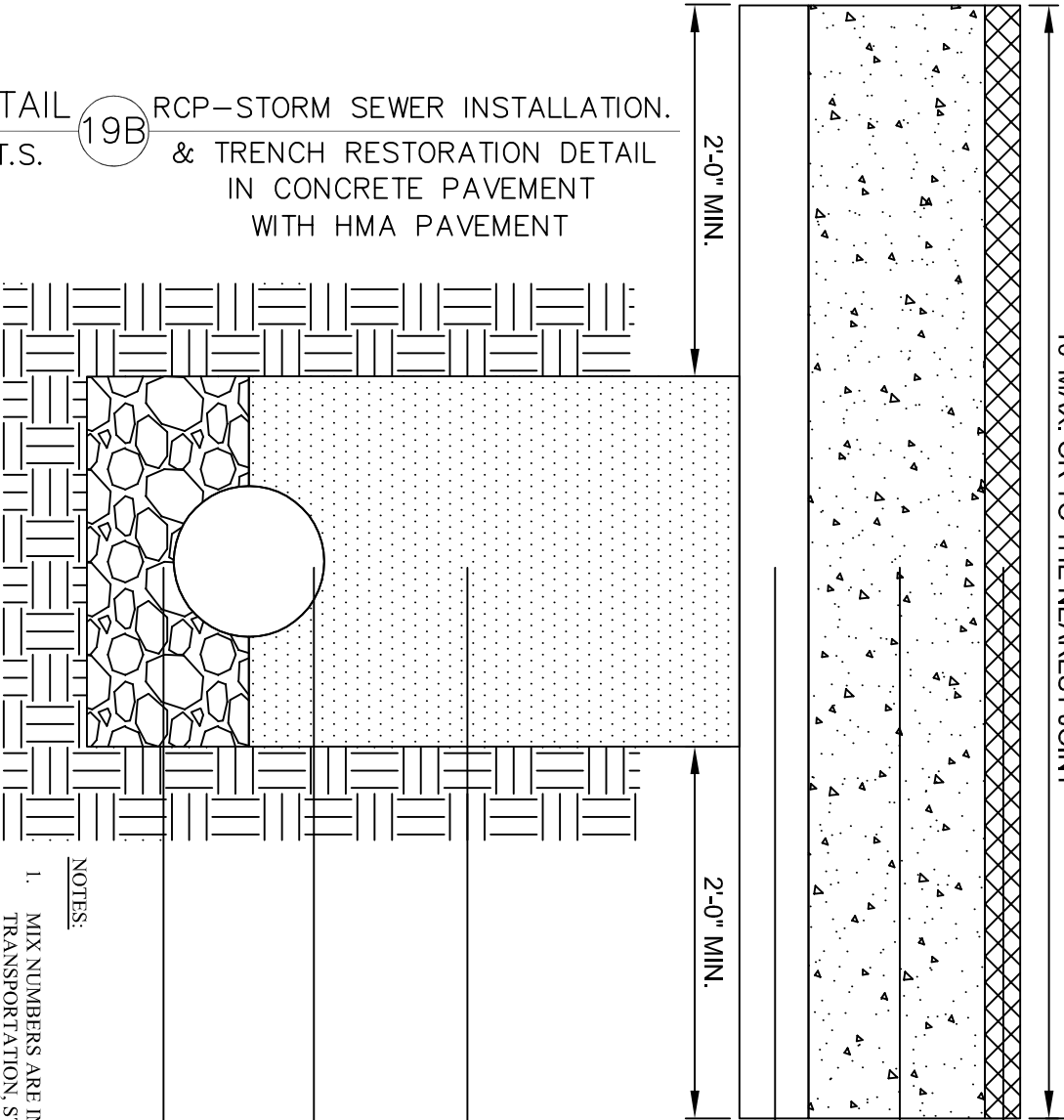

EXISTING PAVEMENT TO BE SAWCUT AND ALL EDGES TACKED (TYPICAL)

PROPOSED HMA PAVEMENT SURFACE COURSE 9.5M64 OR 12.5M64, SEE NOTES

CONCRETE SURFACE COURSE, 9" THICK MIN. WITH DOWELS PER NIDOT DETAIL CD-453-1

SUBBASE, 6" MIN., NON-STABILIZED OPEN GRADED DRAINAGE LAYER OR DGA BASE COURSE

SUITABLE EXCAVATED MATERIAL OR SELECT FILL AS DIRECTED BY THE ENGINEER COMPACTED TO 95% DENSITY

REINFORCED CONCRETE PIPE (VARIOUS DIAMETERS)
 ALL LIFT HOLES MUST BE SEALED WITH APPROVED MATERIAL, ALL JOINTS MUST BE SEALED WITH APPROVED MORTAR, AND JOINTS MUST BE WRAPPED WITH GEOTEXTILE FROM THE SPRING LINE ACROSS TOP OF PIPE

N.J.D.O.T. COARSE AGGREGATE
 NO. 57 COMPACTED TO 95%
 MAXIMUM DENSITY

- NOTES:
1. MIX NUMBERS ARE IN ACCORDANCE WITH NEW JERSEY DEPARTMENT OF TRANSPORTATION, STANDARD SPECIFICATIONS FOR ROAD AND BRIDGE CONSTRUCTION.
 2. SURFACE COURSE MAY BE 9.5M64 ON COUNTY ROADS WITH AADT LESS THAN 5,000.
 3. SURFACE COURSE MUST BE 12.5M64 ON COUNTY ROADS WITH AADT EQUAL OR GREATER THAN 5,000.

NO.	DATE	REVISIONS	CAMDEN COUNTY DEPARTMENT OF PUBLIC WORKS DIVISION OF PLANNING CHARLES J. DEVALUA PUBLIC WORKS COMPLEX 2311 EGG HARBOR ROAD NEW JERSEY 08021	CAMDEN COUNTY DEPARTMENT OF PUBLIC WORKS SAM MARELLA, DIRECTOR KEVIN BECCA, PE, PP, CM, CFM COUNTY ENGINEER 2311 EGG HARBOR ROAD LINDENWALD, NEW JERSEY 08021	TITLE COUNTY STANDARD TRENCH RESTORATION DETAIL IN CONCRETE PAVEMENT AREA (WITH HMA PRESENT)	DATE MAY 2016 DRAWN BY T.A.P. APPROVED BY K.B./A.L.	SHT. NO. 1
-----	------	-----------	--	---	---	--	---------------

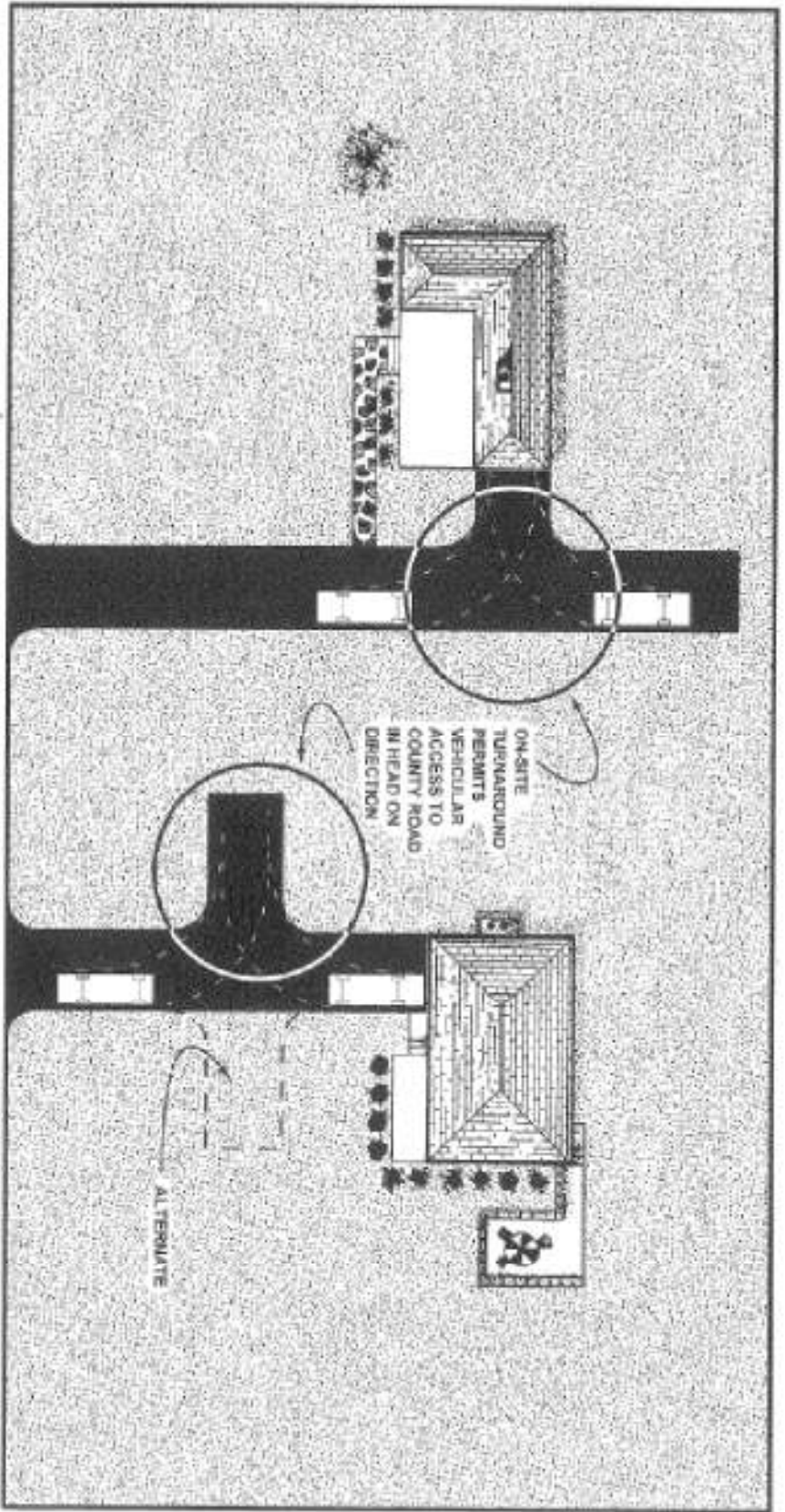

DETAIL 20 STANDARD DRIVEWAY TURNAROUNDS
 N.T.S. (K - TURN DETAIL)

No.	DATE	REVISIONS

CAMDEN COUNTY
 DEPARTMENT OF PUBLIC WORKS
 DIVISION OF PLANNING
 CHARLES J. DEPALMA PUBLIC WORKS COMPLEX
 2311 EGG HARBOR ROAD
 NEW JERSEY 08021

CAMDEN COUNTY
 DEPARTMENT OF PUBLIC WORKS
 SAM MARTELLO, DIRECTOR
 KEVIN BEGICA, P.E., P.E. CMC, CFM
 2311 EGG HARBOR ROAD
 UNDEENWOLD, NEW JERSEY 08021

TITLE
 COUNTY STANDARD
 DRIVEWAY TURNAROUNDS
 (K-TURN DETAIL)

DATE
 MAR 2014
 DRAWN BY
 T.A.P
 APPROVED BY
 K.B./A.L.

SHT. NO.
 1

Plotted: 7/10/2015 3:02 PM File Name: \\c:\pwworking\camden_county_standard\101-292-BYPASS AREA.dwg

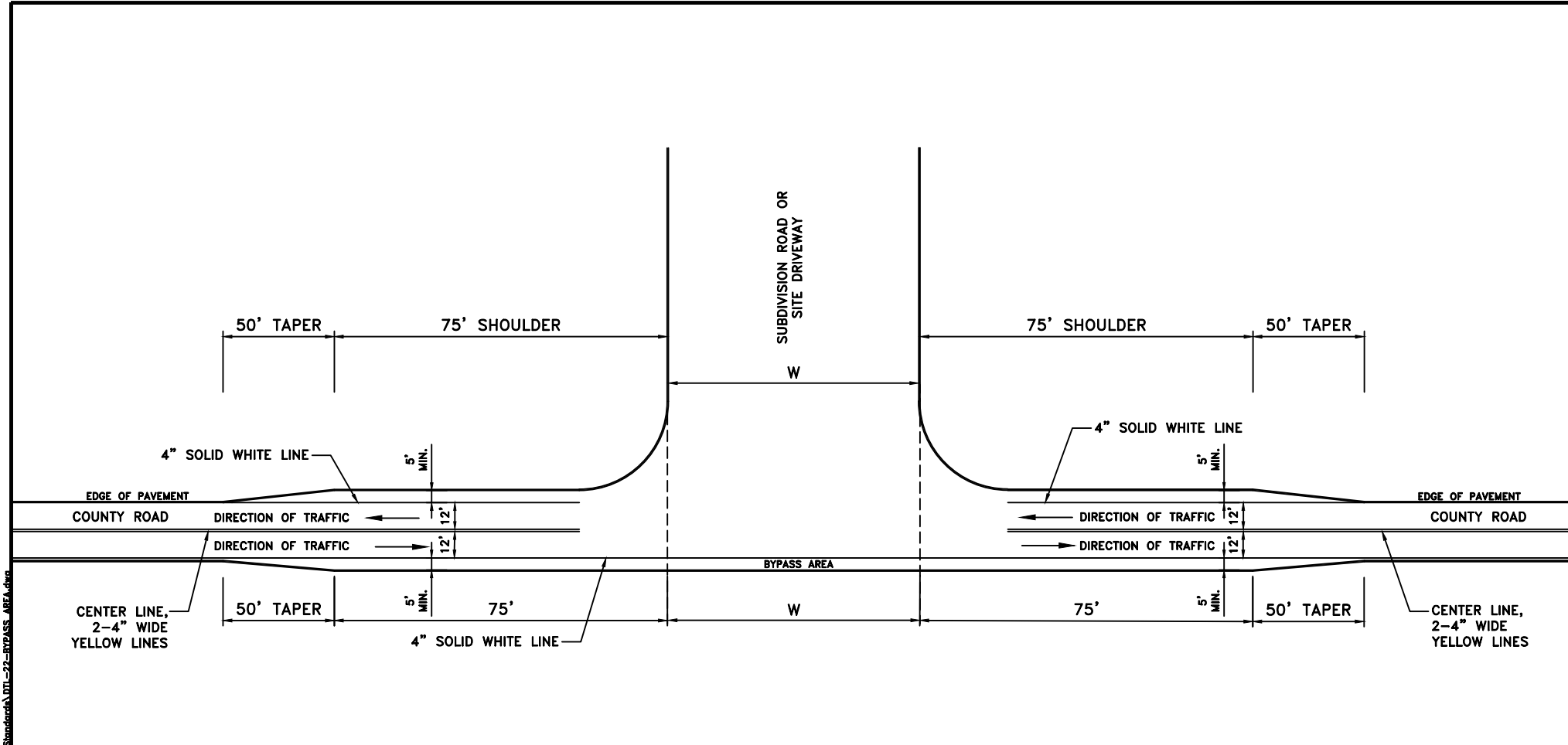

NOTES:

1. BYPASS AREA SHALL ONLY BE REQUIRED IN SPECIAL CIRCUMSTANCES WHERE TRAFFIC OR OTHER CONDITIONS INDICATE THE NEED.
2. FULL DEPTH SAWCUT THE EDGE OF EXISTING PAVEMENT TO RECEIVE THE NEW BYPASS AREA PAVEMENT. SEE TYPICAL COUNTY ROADWAY WIDENING DETAIL.

DETAIL 22 BYPASS AREA

N.T.S.

No.	DATE	REVISIONS

CAMDEN COUNTY
 DEPARTMENT OF PUBLIC WORKS
 DIVISION OF PLANNING
 CHARLES J. DEPALMA PUBLIC WORKS COMPLEX
 2311 EGG HARBOR ROAD
 LINDENWOLD
 NEW JERSEY 08021

CAMDEN COUNTY
 DEPARTMENT OF PUBLIC WORKS
 SAM MARTELLO, DIRECTOR
 KEVIN BECICA, PE, PP, CME, CFM
 COUNTY ENGINEER
 2311 EGG HARBOR ROAD
 LINDENWOLD, NEW JERSEY 08021

TITLE

 COUNTY STANDARD
 BYPASS AREA

DATE
 JUNE 2015
 DRAWN BY
 T.A.P./K.J.S.
 APPROVED BY
 K.B./A.L.

SHT. NO.
1
1

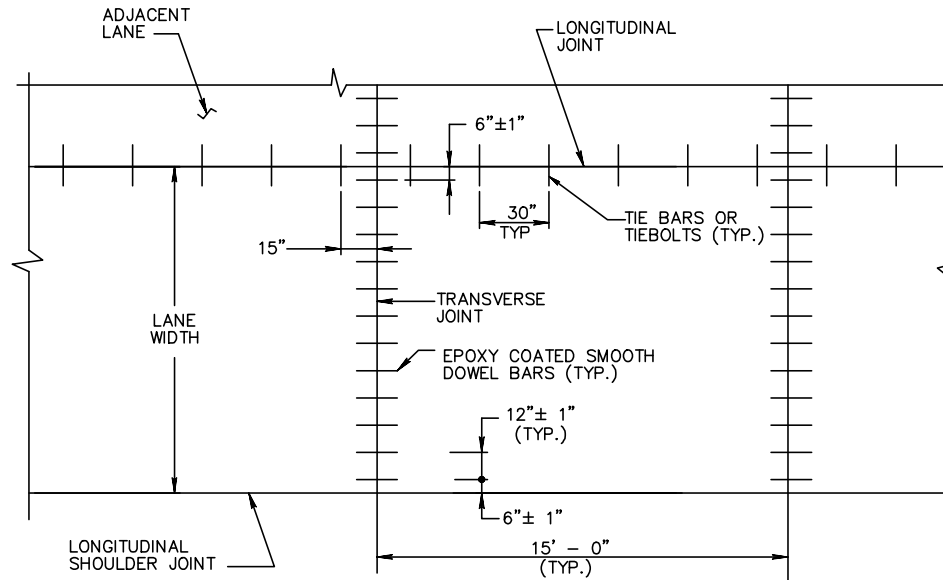

TYPICAL LAYOUT

SEE DETAIL A, B, OR C
(SHT. 3 OF 4)

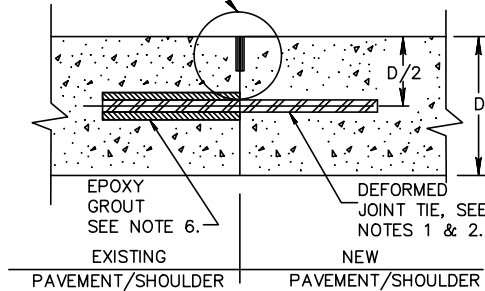

LONGITUDINAL JOINT
WHEN TYING INTO EXISTING
CONCRETE PAVEMENT/SHOULDER

NOTES :

1. SPECIFY #6 TIE BARS 30" ± 1/4" LONG, SPACED 30" CENTER TO CENTER MAXIMUM. FOR JOINT TIES SPECIFY #6 BARS 18" ± 1/4" LONG, SPACED 30" CENTER TO CENTER MAXIMUM. PLACE PERPENDICULAR TO AND CENTERED OVER THE LONGITUDINAL JOINT ± 1". WHEN ADJOINING TO AN UNEQUAL PAVEMENT OR SHOULDER DEPTH, D IS THE DEPTH OF THE THINNER SECTION.
2. DO NOT FIELD BEND TIE BARS, TIE BOLTS, AND JOINT TIES.
3. USE REBAR COUPLING DEVICE THAT IS LISTED ON THE QPL.
4. TEMPORARILY SECURE THE TIE BOLT TO THE FORM DURING PLACEMENT OF THE CONCRETE USING A METHOD ACCPETABLE TO THE R.E..
5. PLACE TIE BOLTS AT 30" CENTER TO CENTER MAXIMUM SPACING. WHEN ADJOINING TO AN UNEQUAL PAVEMENT OR SHOULDER DEPTH, D IS THE DEPTH OF THE THINNER SECTION. SCREW TIE BOLTS UNTIL SNUG.
6. USE AN APPROVED EPOXY GROUT MATERIAL TO WITHSTAND THE NECESSARY MINIMUM PULL-OUT RESISTANCE. TIE BAR HOLE DIAMETER IN EXISTING PAVEMENT SHOULD BE AS PER MANUFACTURER'S RECOMMENDATION. USE ROTARY IMPACT DRILL TO AVOID IMPACTING FINES INTO HOLE.
7. DO NOT USE THE HOOK COMPONENT OF THE TIE BOLT ASSEMBLY WHEN SLIP FORMING.
8. WHEN COLD-POURED JOINT SEALER IS SELECTED FOR USE IN TRANSVERSE JOINTS, USE THE SAME JOINT SEALING MATERIAL IN THE LONGITUDINAL JOINTS.

DETAIL 23 CONCRETE PAVEMENT REPAIR CONSTRUCTION DETAILS

N.T.S.

No.	DATE	REVISIONS

CAMDEN COUNTY
DEPARTMENT OF PUBLIC WORKS
DIVISION OF PLANNING
CHARLES J. DEPALMA PUBLIC WORKS COMPLEX
2311 EGG HARBOR ROAD
LINDENWOLD
NEW JERSEY 08021

CAMDEN COUNTY
DEPARTMENT OF PUBLIC WORKS
SAM MARTELLO, DIRECTOR
KEVIN BECICA, PE, PP, CME, CFM
COUNTY ENGINEER
2311 EGG HARBOR ROAD
LINDENWOLD, NEW JERSEY 08021

TITLE
COUNTY STANDARD
CONCRETE PAVEMENT REPAIR
CONSTRUCTION DETAILS

DATE
JULY 2015
DRAWN BY
T.A.P./K.J.S.
APPROVED BY
K.B/A.L.

SHT. NO.
1
4

Plotfile: 7/10/2015 3:05 PM File Name: \\c:\pwworking\camden\camden\standards\01-23-Concrete_Pavement_Repair_Constr_Details.dwg

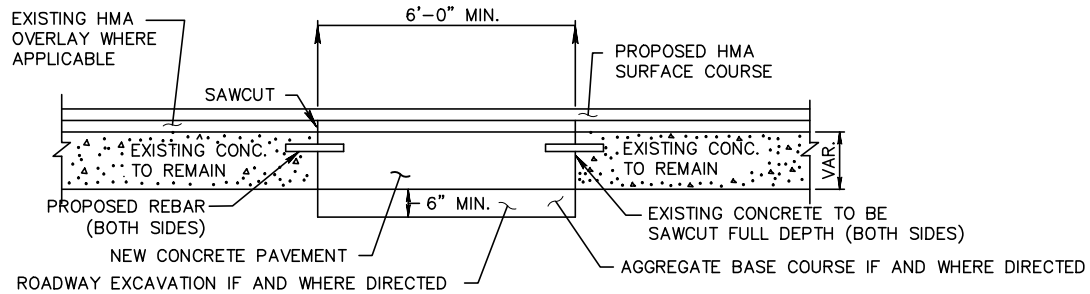

FULL DEPTH CONCRETE PAVEMENT REPAIR

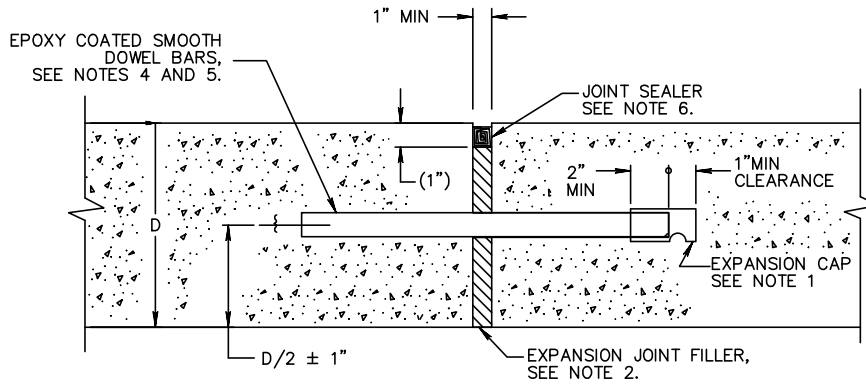

TRANSVERSE EXPANSION JOINT

NOTES :

1. PLACE A CLOSED-END EXPANSION CAP OVER THE LUBRICATED END OF ALL DOWEL BARS USED IN TRANSVERSE EXPANSION JOINTS AND PROVIDE A MINIMUM 1" CLEARANCE POCKET ASSURED BY MEANS OF A POSITIVE SPACING DEVICE.
2. CUT EXPANSION JOINT FILLER MATERIAL TO CONFORM TO THE CROSS SECTION OF THE PAVEMENT AND FURNISH IN STRIPS EQUAL TO THE WIDTH OF THE PAVEMENT SLAB. MAKE THE TOP SURFACE SMOOTH AND HAVE HOLES PUNCHED FOR THE DOWEL BARS PROVIDE A SNUG FIT WITHOUT LOSS IN THICKNESS OF THE MATERIAL.
3. CONSTRUCT ALL TRANSVERSE JOINTS PERPENDICULAR TO THE CENTERLINE.
4. USE MINIMUM 1 1/4" ~ x 18" LONG EPOXY COATED SMOOTH DOWEL BARS FOR PAVEMENT DEPTHS 10" OR LESS, AND MINIMUM 1 1/2" ~ X 18" LONG DOWEL BARS FOR PAVEMENT DEPTHS GREATER THAN 10". APPROVED ALTERNATE DOWEL BARS HAVING EQUIVALENT PROPERTIES TO CONVENTIONAL ROUND DOWEL REINFORCEMENT STEEL MAY BE PROPOSED FOR USE.
5. PLACE EPOXY COATED SMOOTH DOWEL BARS PARALLEL TO THE CENTERLINE AND SURFACE OF THE SLAB.
6. MAKE THE TOP OF THE JOINT SEALING MATERIAL 1/4" ± 1/8" BELOW THE SURFACE OF THE PAVEMENT.
7. THE INITIAL SAW CUT RELIEF JOINT IS NOT REQUIRED FOR CONSTRUCTION JOINTS.
8. WHEN COLD-POURED JOINT SEALER IS SELECTED FOR USE IN TRANSVERSE JOINTS, USE THE SAME JOINT SEALER IN THE LONGITUDINAL JOINTS.

DETAIL 24 CONCRETE PAVEMENT REPAIR CONSTRUCTION DETAILS

N.T.S.

Plotted: 7/10/2015 3:08 PM File Name: \\c:\pwworking\camden_county_standards\01-24-Concrete_Pavement_Repair_Constr_Details.dwg

No.	DATE	REVISIONS

CAMDEN COUNTY
 DEPARTMENT OF PUBLIC WORKS
 DIVISION OF PLANNING
 CHARLES J. DEPALMA PUBLIC WORKS COMPLEX
 2311 EGG HARBOR ROAD
 LINDENWOLD
 NEW JERSEY 08021

CAMDEN COUNTY
 DEPARTMENT OF PUBLIC WORKS
 SAM MARTELLO, DIRECTOR
 KEVIN BECICA, PE, PP, CME, CFM
 COUNTY ENGINEER
 2311 EGG HARBOR ROAD
 LINDENWOLD, NEW JERSEY 08021

TITLE
 COUNTY STANDARD
 CONCRETE PAVEMENT REPAIR
 CONSTRUCTION DETAILS

DATE
 JULY 2015
 DRAWN BY
 T.A.P./K.J.S.
 APPROVED BY
 K.B./A.L.

SHT. NO.
 2
 4

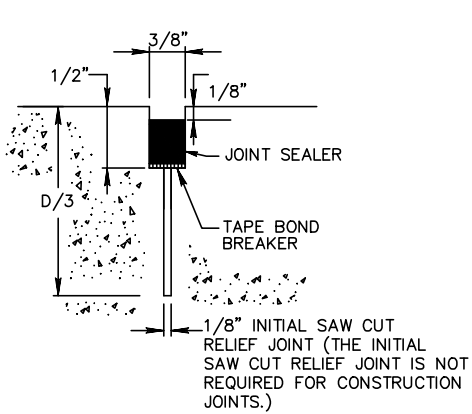

DETAIL A
HOT-POURED JOINT SEALER

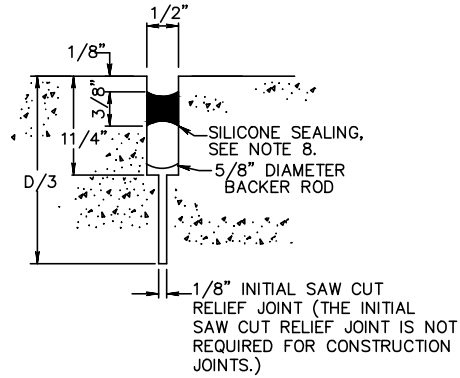

DETAIL B
COLD-POURED JOINT SEALER
WITH BACKER ROD
(CAMDEN COUNTY
PREFERRED TREATMENT)

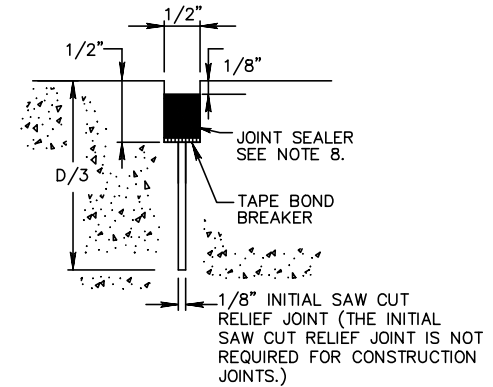

DETAIL C
COLD-POURED JOINT SEALER
WITHOUT BACKER ROD

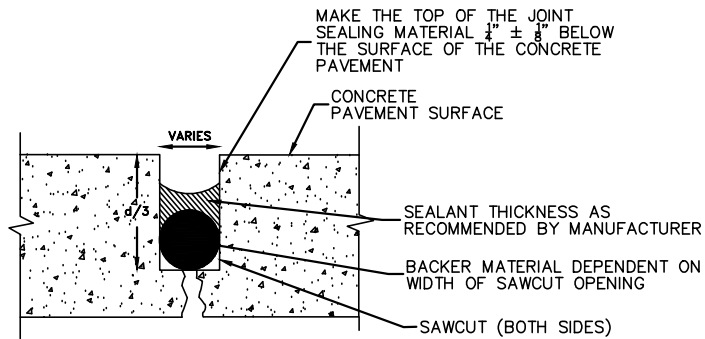

CRACK REPAIR DETAIL FOR CRACKS
OVER 0.5 INCHES TO 2.0 INCHES IN WIDTH

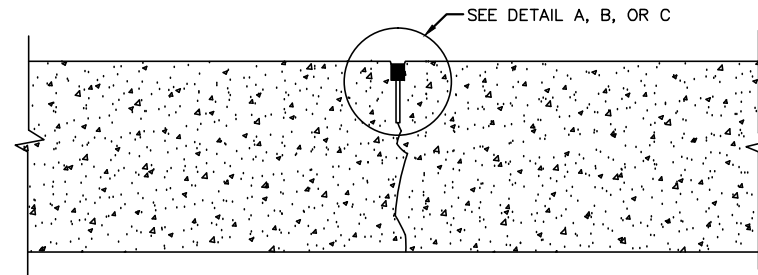

CRACK REPAIR DETAIL FOR CRACKS
LESS THAN 0.5 INCHES WIDE

DETAIL 25 CONCRETE PAVEMENT REPAIR CONSTRUCTION DETAILS

N.T.S.

Plotted: 7/10/2015 3:07 PM File Name: \\cconew\linda\Engineering\County_Standards\01-25-Concrete_Pavement_Repair_Constr_Details.dwg

No.	DATE	REVISIONS

CAMDEN COUNTY
DEPARTMENT OF PUBLIC WORKS
DIVISION OF PLANNING
CHARLES J. DEPALMA PUBLIC WORKS COMPLEX
2311 EGG HARBOR ROAD
LINDENWOLD
NEW JERSEY 08021

CAMDEN COUNTY
DEPARTMENT OF PUBLIC WORKS
SAM MARTELLO, DIRECTOR
KEVIN BECICA, PE, PP, CME, CFM
COUNTY ENGINEER
2311 EGG HARBOR ROAD
LINDENWOLD, NEW JERSEY 08021

TITLE
COUNTY STANDARD
CONCRETE PAVEMENT REPAIR
CONSTRUCTION DETAILS

DATE
JULY 2015
DRAWN BY
T.A.P/K.J.S.
APPROVED BY
K.B/A.L.

SHT. NO.
3
4

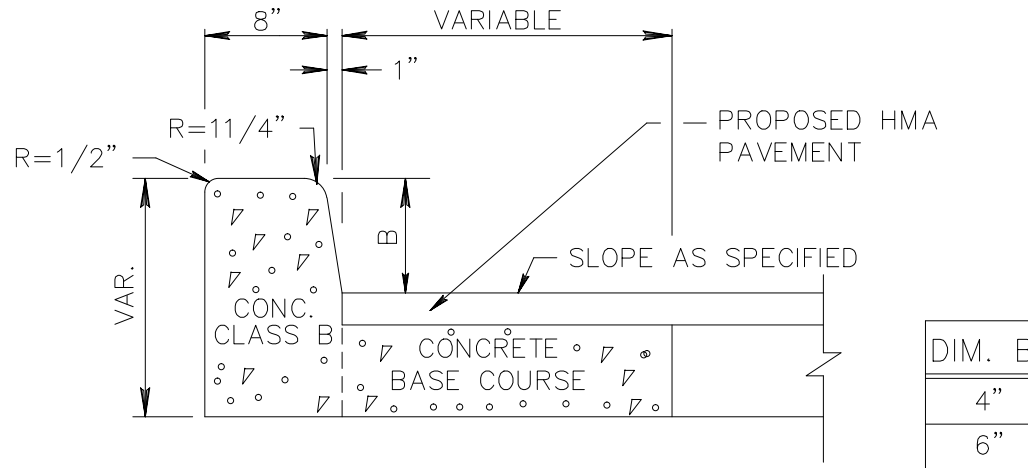

NOTES:
 EXPANSION JOINTS 1/2 INCH WIDE IN THE CURB, AND EXPANSION JOINT ASSEMBLY IN THE MONOLITHIC PAVEMENT STRIP SHALL BE DIRECTLY OPPOSITE EVERY TRANSVERSE JOINT IN THE CENTRAL PAVEMENT STRIPS. JOINT MATERIAL IN THE CURB SHALL BE AS SPECIFIED FOR CONCRETE VERTICAL CURB. THE TRANSVERSE EXPANSION JOINT MATERIAL SHALL NOT EXTEND THRU THE CURB.

CONCRETE VERTICAL CURB MONOLITHIC WITH CONCRETE BASE COURSE

DETAIL 26 CONCRETE PAVEMENT REPAIR CONSTRUCTION DETAILS

N.T.S.

No.		DATE	REVISIONS	CAMDEN COUNTY DEPARTMENT OF PUBLIC WORKS DIVISION OF PLANNING CHARLES J. DEPALMA PUBLIC WORKS COMPLEX 2311 EGG HARBOR ROAD LINDENWOLD NEW JERSEY 08021	CAMDEN COUNTY DEPARTMENT OF PUBLIC WORKS SAM MARTELLO, DIRECTOR KEVIN BECICA, PE, PP, CME, CFM COUNTY ENGINEER 2311 EGG HARBOR ROAD LINDENWOLD, NEW JERSEY 08021	TITLE COUNTY STANDARD CONCRETE PAVEMENT REPAIR CONSTRUCTION DETAILS	DATE JULY 2015 DRAWN BY T.A.P./K.J.S. APPROVED BY K.B./A.L.	SHT. NO. 4 4
-----	--	------	-----------	---	---	--	--	--------------------

Plotfile: 7/10/2015 3:09 PM File Name: \\c:\pwworking\linda\Engineering\County Standards\01-26-Concrete Pavement Repair_Constr_Details.dwg

Plotted: 1/19/2017 2:32 PM File Name: \\CDDPW-LIND\C\Engineers\County_Standards\DOT-28-HMA-Curb-6.5X11.dwg

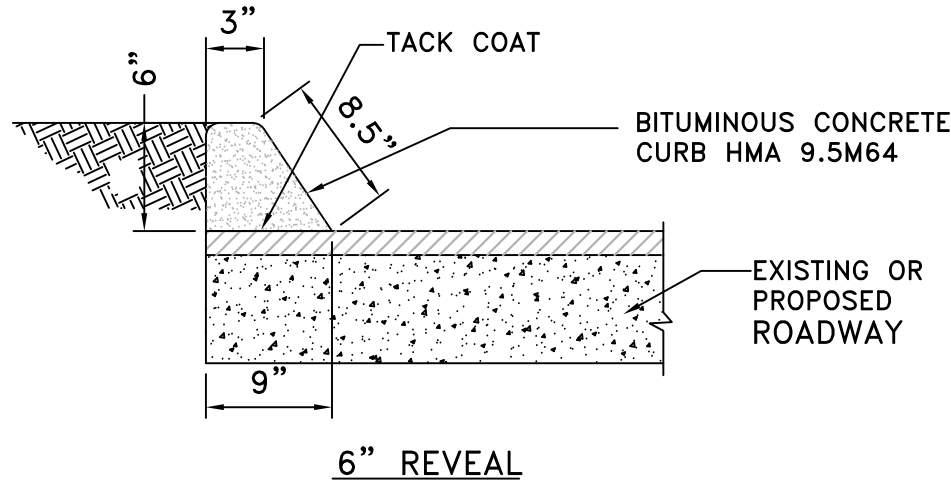

NOTES

1. HAND FORM CURB TO CROSS SECTION SHOWN OR MODIFY TO SUIT EXISTING CONDITIONS. ADJUST RATE OF PLACEMENT TO INSURE BONDING AND COMPACTION OF MIXTURE AS IT IS PLACED.
2. PROVIDE FINISHED CURB HAVING A SMOOTH AND TRUE LINE OF GRADE. COMPLETED CURB SHALL HAVE A SMOOTH SURFACE AND SHALL CONFORM TO PRESCRIBED AND/OR EXISTING CROSS SECTION.

DETAIL 28 BITUMINOUS CURB

N.T.S.

		CAMDEN COUNTY DEPARTMENT OF PUBLIC WORKS DIVISION OF PLANNING CHARLES J. DEPALMA PUBLIC WORKS COMPLEX 2311 EGG HARBOR ROAD LINDENWOLD NEW JERSEY 08021	CAMDEN COUNTY DEPARTMENT OF PUBLIC WORKS SAM MARTELLO, DIRECTOR KEVIN BECICA, PE, PP, CME, CFM COUNTY ENGINEER 2311 EGG HARBOR ROAD LINDENWOLD, NEW JERSEY 08021	TITLE COUNTY STANDARD BITUMINOUS CURB (6" REVEAL)	DATE AUG 2016 DRAWN BY T.A.P APPROVED BY K.B/A.L.	SHT. NO. <div style="border: 1px solid black; border-radius: 50%; width: 30px; height: 30px; margin: 0 auto; display: flex; align-items: center; justify-content: center;"> 1 </div> <div style="border: 1px solid black; border-radius: 50%; width: 30px; height: 30px; margin: 0 auto; display: flex; align-items: center; justify-content: center;"> 1 </div>
No.	DATE	REVISIONS				

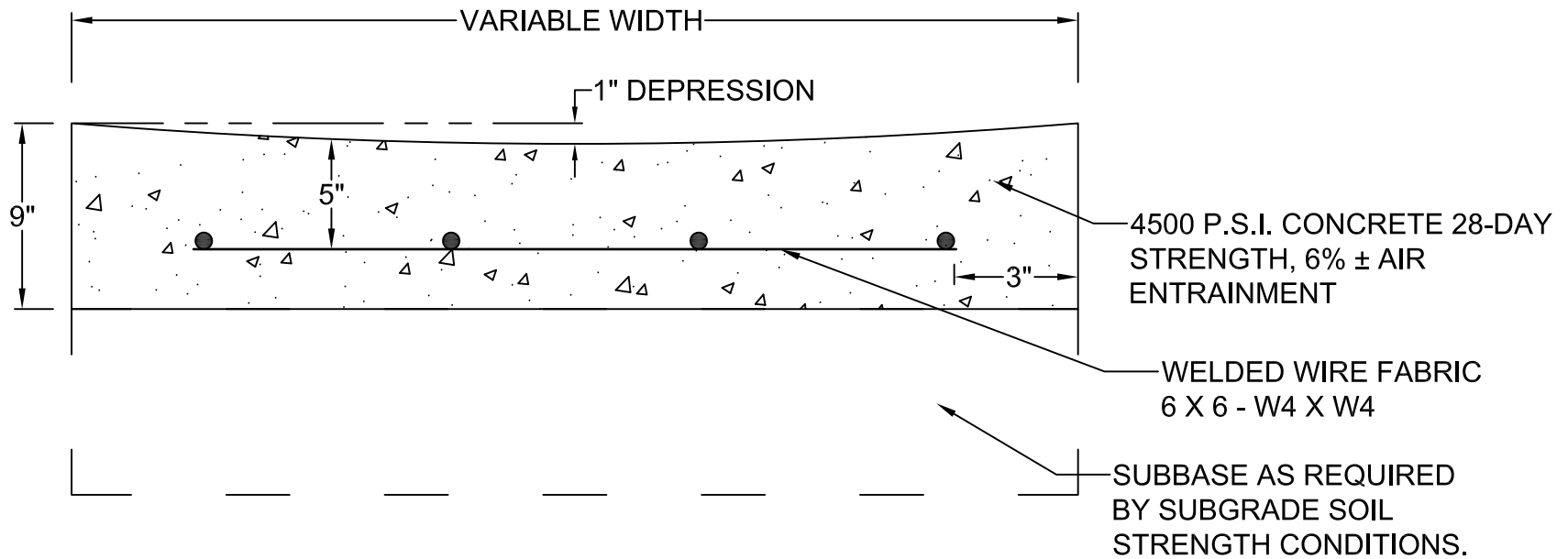

DETAIL 29 CONCRETE GUTTER

N.T.S.

Plotted: 1/23/2017 9:01 AM File Name: \\CDDPW-LIND\Engineering\County_Standards\DOT-29-Concrete_Gutter_Detail.dwg

No.	DATE	REVISIONS

CAMDEN COUNTY
 DEPARTMENT OF PUBLIC WORKS
 DIVISION OF PLANNING
 CHARLES J. DEPALMA PUBLIC WORKS COMPLEX
 2311 EGG HARBOR ROAD
 LINDENWOLD
 NEW JERSEY 08021

CAMDEN COUNTY
 DEPARTMENT OF PUBLIC WORKS
 SAM MARTELLO, DIRECTOR
 KEVIN BECICA, PE, PP, CME, CFM
 COUNTY ENGINEER
 2311 EGG HARBOR ROAD
 LINDENWOLD, NEW JERSEY 08021

TITLE
 COUNTY STANDARD
 CONCRETE GUTTER

DATE
 JAN 2017
 DRAWN BY
 K.S.
 APPROVED BY
 K.B/A.L.

SHT. NO.
1
1